

**Broad Development Parameters of the Applied Use/Development
in respect of Application No. A/YL-NSW/293
(Review under Section 17)
關乎申請編號 A/YL-NSW/293 的擬議用途/發展的概括發展規範
(根據第 17 條的覆核)**

Revised broad development parameters in view of
the further information received on 7.6.2023 and 13.6.2023
因應於 2023 年 6 月 7 日及 13 日接獲的進一步資料而修訂的概括發展規範

| | | | |
|---|---|---|--------------------|
| Application No. 申請編號 | A/YL-NSW/293 | | |
| Location/address 位置/地址 | Various Lots in D.D. 103 and D.D. 115, Tung Shing Lei, Nam Sang Wai, Yuen Long 元朗南生圍東成里丈量約份第 103 約多個地段和丈量約份第 115 約多個地段 | | |
| Site area 地盤面積 | About 約 53,584 sq. m 平方米 | | |
| Plan 圖則 | <u>Section 16 application 第 16 條申請</u> Approved Nam Sang Wai Outline Zoning Plan No. S/YL-NSW/8 南生圍分區計劃大綱核准圖編號 S/YL-NSW/8 | | |
| | <u>Section 17 Review 第 17 條覆核</u> Approved Nam Sang Wai Outline Zoning Plan No. S/YL-NSW/8 南生圍分區計劃大綱核准圖編號 S/YL-NSW/8 | | |
| Zoning 地帶 | <u>Section 16 application 第 16 條申請</u> "Undetermined" 「未決定用途」 | | |
| | <u>Section 17 Review 第 17 條覆核</u> "Undetermined" 「未決定用途」 | | |
| Applied use/ development 申請用途/發展 | Proposed Comprehensive Residential Development 擬議綜合住宅發展 | | |
| Nature of Review 覆核性質 | To review the refusal decision of the application 覆核拒絕申請的決定 | | |
| Gross floor area and/or plot ratio 總樓面面積及/ 或地積比率 | | sq. m 平方米 | Plot ratio 地積比率 |
| | Domestic 住用 | About 約 141,200 | About 約 2.635 |
| | Non-domestic 非住用 | About 約 5,358 | About 約 0.1 |
| No. of block 幢數 | Domestic 住用 | 11 Residential Towers 住宅大樓 9 Houses 屋宇 | |
| | Non-domestic 非住用 | - | |
| | Composite 綜合用途 | - | |

| | | | |
|--|---|---|----------------------|
| Building height/ No. of storeys 建築物高度／層數 | Domestic 住用 | 8 - 134.5 | m 米 |
| | | 12 - 139 | mPD 米(主水平基準上) |
| | | 2 - 44 <i>Exclude</i> 不包括 1 - 2 Basement 地庫 Refuge Floor 防火層 Podium 平台 | Storey(s) 層 |
| | Non-domestic 非住用 | - | m 米 |
| | | - | mPD 米(主水平基準上) |
| | | - | Storey(s) 層 |
| | Composite 綜合用途 | - | m 米 |
| | | - | mPD 米(主水平基準上) |
| | | - | Storey(s) 層 |
| Site coverage 上蓋面積 | About 約 16 % | | |
| No. of units 單位數目 | 2,802 Flats 住宅單位 9 Houses 屋宇 | | |
| Open space 休憩用地 | Private 私人 | Not less than 不少於 8,150 | sq. m 平方米 |
| | Public 公眾 | - | sq. m 平方米 |
| No. of parking spaces and loading / unloading spaces 停車位及上落客貨 車位數目 | Total no. of vehicle spaces 停車位總數 (excluding bicycle parking spaces 不包括單車車位) | | 1,093 |
| | Private Car Parking Spaces 私家車車位 | | 1,060 ⁽¹⁾ |
| | Motorcycle Parking Spaces 電單車車位 | | 33 |
| | Bicycle Parking Spaces 單車車位 | | 374 |
| | Total no. of vehicle loading/unloading bays/lay-bys 上落客貨車位／停車處總數 | | 18 |
| Light Goods Vehicle Spaces 輕型貨車車位 | | 5 | |
| Heavy Goods Vehicle Spaces 重型貨車車位 | | 13 | |

⁽¹⁾ Including 10 nos. accessible car parking spaces and 55 nos. visitor car parking spaces 包括 10 個暢通易達停車位 55 個訪客車位

* 有關資料是為方便市民大眾參考而提供。對於所載資料在使用上的問題及文義上的歧異，城市規劃委員會概不負責。若有任何疑問，應查閱申請人提交的文件。

The information is provided for easy reference of the general public. Under no circumstances will the Town Planning Board accept any liabilities for the use of the information nor any inaccuracies or discrepancies of the information provided. In case of doubt, reference should always be made to the submission of the applicant.

| Submitted Plans, Drawings and Documents 提交的圖則、繪圖及文件 | | |
|--|--------------------------|-------------------------------------|
| | <u>Chinese</u> 中文 | <u>English</u> 英文 |
| <u>Plans and Drawings 圖則及繪圖</u> | | |
| Master layout plan(s)/Layout plan(s) 總綱發展藍圖／布局設計圖 | <input type="checkbox"/> | <input checked="" type="checkbox"/> |
| Block plan(s) 樓宇位置圖 | <input type="checkbox"/> | <input type="checkbox"/> |
| Floor plan(s) 樓宇平面圖 | <input type="checkbox"/> | <input type="checkbox"/> |
| Sectional plan(s) 截視圖 | <input type="checkbox"/> | <input type="checkbox"/> |
| Elevation(s) 立視圖 | <input type="checkbox"/> | <input type="checkbox"/> |
| Photomontage(s) showing the proposed development 顯示擬議發展的合成照片 | <input type="checkbox"/> | <input type="checkbox"/> |
| Master landscape plan(s)/Landscape plan(s) 園境設計總圖／園境設計圖 | <input type="checkbox"/> | <input type="checkbox"/> |
| Others (please specify) 其他（請註明） | <input type="checkbox"/> | <input type="checkbox"/> |
| <u>Reports 報告書</u> | | |
| Planning Justifications 規劃理據 | <input type="checkbox"/> | <input checked="" type="checkbox"/> |
| Environmental assessment (noise, air and/or water pollutions) 環境評估（噪音、空氣及／或水的污染） | <input type="checkbox"/> | <input type="checkbox"/> |
| Traffic impact assessment (on vehicles) 就車輛的交通影響評估 | <input type="checkbox"/> | <input type="checkbox"/> |
| Traffic impact assessment (on pedestrians) 就行人的交通影響評估 | <input type="checkbox"/> | <input type="checkbox"/> |
| Visual impact assessment 視覺影響評估 | <input type="checkbox"/> | <input type="checkbox"/> |
| Landscape impact assessment 景觀影響評估 | <input type="checkbox"/> | <input type="checkbox"/> |
| Tree Survey 樹木調查 | <input type="checkbox"/> | <input type="checkbox"/> |
| Geotechnical impact assessment 土力影響評估 | <input type="checkbox"/> | <input type="checkbox"/> |
| Drainage impact assessment 排水影響評估 | <input type="checkbox"/> | <input type="checkbox"/> |
| Sewerage impact assessment 排污影響評估 | <input type="checkbox"/> | <input type="checkbox"/> |
| Risk Assessment 風險評估 | <input type="checkbox"/> | <input type="checkbox"/> |
| Others (please specify) 其他（請註明） | <input type="checkbox"/> | <input type="checkbox"/> |
| Note: May insert more than one 「✓」. 註：可在多於一個方格內加上「✓」號 | | |

Note: The information in the Gist of Application above is provided by the applicant for easy reference of the general public. Under no circumstances will the Town Planning Board accept any liabilities for the use of the information nor any inaccuracies or discrepancies of the information provided. In case of doubt, reference should always be made to the submission of the applicant.

註：上述申請摘要的資料是由申請人提供以方便市民大眾參考。對於所載資料在使用上的問題及文義上的歧異，城市規劃委員會概不負責。若有任何疑問，應查閱申請人提交的文件。

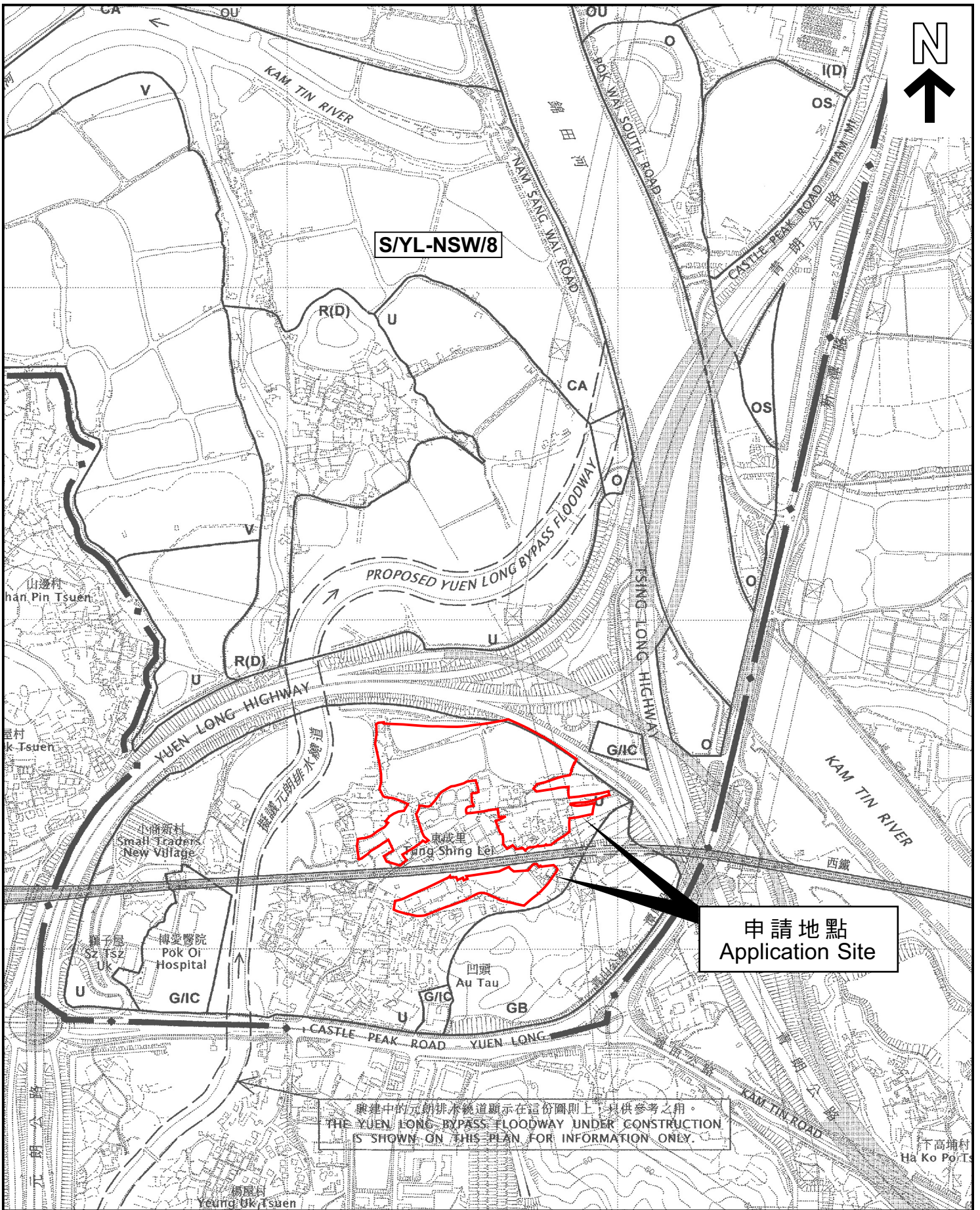

本摘要圖於2023年6月19日擬備，
 所根據的資料為於2006年10月17日
 核准的分區計劃大綱圖編號 S/YL-NSW/8
 EXTRACT PLAN PREPARED ON 19.6.2023
 BASED ON OUTLINE ZONING PLAN No.
 S/YL-NSW/8 APPROVED ON 17.10.2006

位置圖 LOCATION PLAN
 (覆核申請 REVIEW APPLICATION)

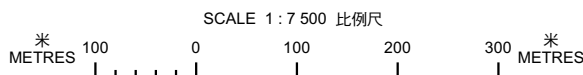

申請地點界線只作識別用
 APPLICATION SITE BOUNDARY
 FOR IDENTIFICATION PURPOSE ONLY

參考編號
 REFERENCE No.

A/YL-NSW/293

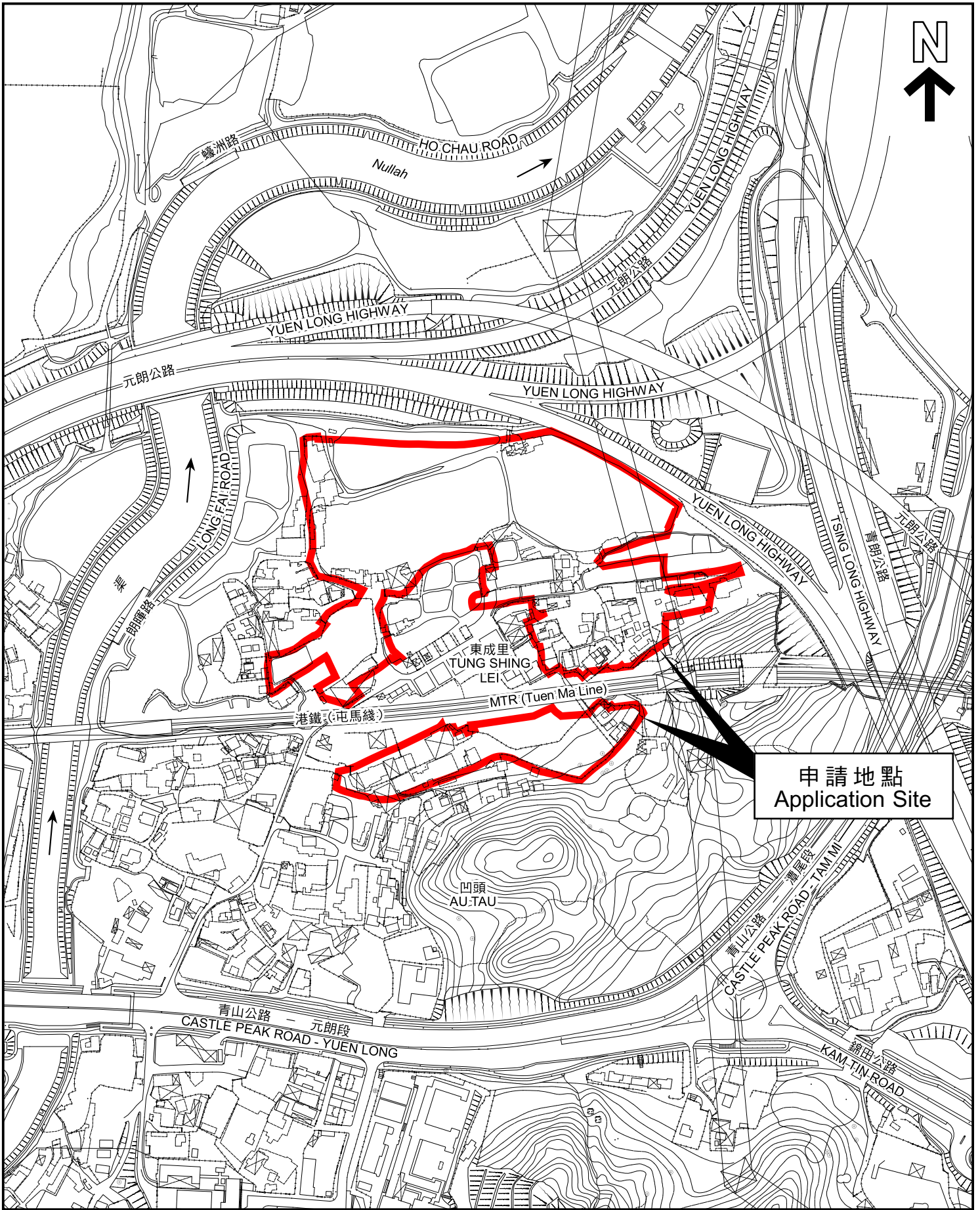

本摘要圖於2023年6月19日擬備，
 所根據的資料為測量圖編號
 6-NE-6A、6C 及 6-NW-10B、10D
 EXTRACT PLAN PREPARED ON 19.6.2023
 BASED ON SURVEY SHEETS No.
 6-NE-6A, 6C & 6-NW-10B, 10D

平面圖 SITE PLAN
 (覆核申請 REVIEW APPLICATION)

申請地點界線只作識別用
 APPLICATION SITE BOUNDARY
 FOR IDENTIFICATION PURPOSE ONLY

參考編號
 REFERENCE No.
A/YL-NSW/293

申請編號 Application No. : A/YL-NSW/293
(覆核申請 Review Application)

備註 Remarks

申請人呈交進一步資料，包括經修訂的總綱發展藍圖、經修訂的發展參數表及修訂的理由。

The applicant submitted further information, including a revised master layout plan, a revised development parameters table and justifications for the revisions.

有關資料是為方便市民大眾參考而提供。對於所載資料在使用上的問題及文義上的歧異，城市規劃委員會概不負責。若有任何疑問，應查閱申請人提交的文件。

The information is provided for easy reference of the general public. Under no circumstances will the Town Planning Board accept any liabilities for the use of the information nor any inaccuracies or discrepancies of the information provided. In case of doubt, reference should always be made to the submission of the applicant.

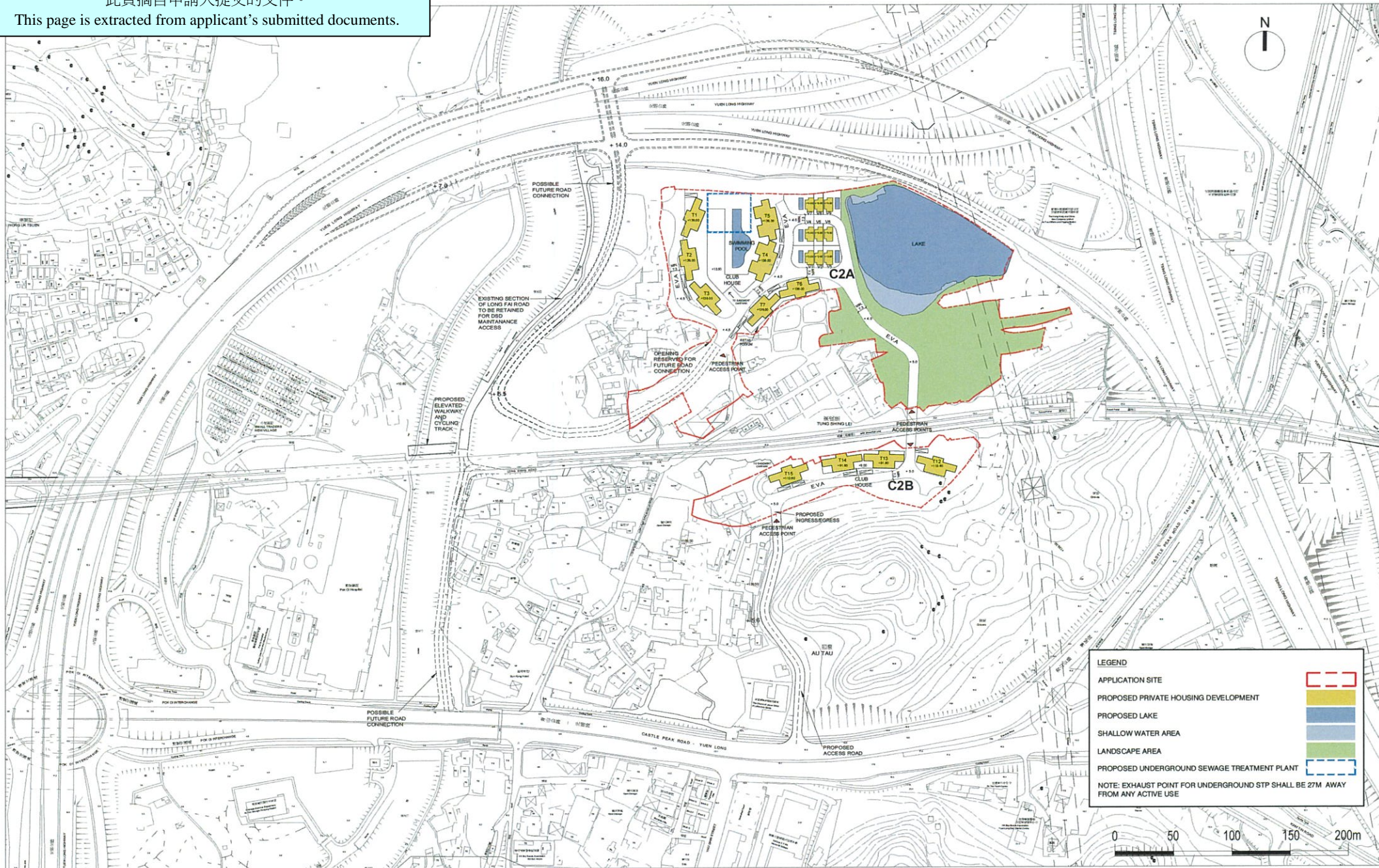

MASTER LAYOUT PLAN FOR THE PROPOSED COMPREHENSIVE RESIDENTIAL DEVELOPMENT AT THE APPLICATION SITE