

**Broad Development Parameters of the Applied Use/Development
in respect of Application No. A/YL-ST/649**

關於申請編號 A/YL-ST/649 的擬議用途/發展的概括發展規範

Application No. 申請編號	A/YL-ST/649		
Location/address 位置/地址	Lots 1999 and 2017 in D.D. 96, Lok Ma Chau, San Tin, Yuen Long 元朗新田落馬洲丈量約份第 96 約地段第 1999 號及第 2017 號		
Site area 地盤面積	About 約 374 sq. m 平方米		
Plan 圖則	Approved San Tin Outline Zoning Plan No. S/YL-ST/8 新田分區計劃大綱核准圖編號 S/YL-ST/8		
Zoning 地帶	"Green Belt" 「綠化地帶」		
Applied use/ development 申請用途/發展	Proposed Filling of Land for Permitted Agricultural Use 擬議填土工程以作准許的農業用途		
Gross floor area and/or plot ratio 總樓面面積及/ 或地積比率		sq. m 平方米	Plot ratio 地積比率
	Domestic 住用	-	-
	Non-domestic 非住用	-	-
No. of block 幢數	Domestic 住用	-	
	Non-domestic 非住用	-	
	Composite 綜合用途	-	
Building height/No. of storeys 建築物高度/ 層數	Domestic 住用	-	m 米
		-	mPD 米(主水平基準上)
		-	Storey(s) 層
	Non-domestic 非住用	-	m 米
		-	mPD 米(主水平基準上)
		-	Storey(s) 層
	Composite 綜合用途	-	m 米
		-	mPD 米(主水平基準上)
		-	Storey(s) 層
Site coverage 上蓋面積	-		
No. of units	-		

單位數目			
Open space 休憩用地	Private 私人	-	sq. m 平方米
	Public 公眾	-	sq. m 平方米
No. of parking spaces and loading / unloading spaces 停車位及上落客貨 車位數目	-		

* 有關資料是為方便市民大眾參考而提供。對於所載資料在使用上的問題及文義上的歧異，城市規劃委員會概不負責。若有任何疑問，應查閱申請人提交的文件。

The information is provided for easy reference of the general public. Under no circumstances will the Town Planning Board accept any liabilities for the use of the information nor any inaccuracies or discrepancies of the information provided. In case of doubt, reference should always be made to the submission of the applicant.

Submitted Plans, Drawings and Documents 提交的圖則、繪圖及文件		
	<u>Chinese</u> 中文	<u>English</u> 英文
<u>Plans and Drawings 圖則及繪圖</u>		
Master layout plan(s)/Layout plan(s) 總綱發展藍圖／布局設計圖	<input checked="" type="checkbox"/>	<input type="checkbox"/>
Block plan(s) 樓宇位置圖	<input type="checkbox"/>	<input type="checkbox"/>
Floor plan(s) 樓宇平面圖	<input type="checkbox"/>	<input type="checkbox"/>
Sectional plan(s) 截視圖	<input type="checkbox"/>	<input type="checkbox"/>
Elevation(s) 立視圖	<input type="checkbox"/>	<input type="checkbox"/>
Photomontage(s) showing the proposed development 顯示擬議發展的合成照片	<input type="checkbox"/>	<input type="checkbox"/>
Master landscape plan(s)/Landscape plan(s) 園境設計總圖／園境設計圖	<input type="checkbox"/>	<input type="checkbox"/>
Others (please specify) 其他（請註明）	<input checked="" type="checkbox"/>	<input type="checkbox"/>
<u>Location plan 位置圖</u>		
<u>Vehicular access plan 行車通道圖</u>		
<u>Site plan 地盤平面圖</u>		
<u>Land filling area plan 填土工程範圍圖</u>		
<u>Reports 報告書</u>		
Planning Statement / Justifications 規劃綱領 / 理據	<input checked="" type="checkbox"/>	<input type="checkbox"/>
Environmental assessment (noise, air and/or water pollutions) 環境評估（噪音、空氣及／或水的污染）	<input type="checkbox"/>	<input type="checkbox"/>
Traffic impact assessment (on vehicles) 就車輛的交通影響評估	<input type="checkbox"/>	<input type="checkbox"/>
Traffic impact assessment (on pedestrians) 就行人的交通影響評估	<input type="checkbox"/>	<input type="checkbox"/>
Visual impact assessment 視覺影響評估	<input type="checkbox"/>	<input type="checkbox"/>
Landscape impact assessment 景觀影響評估	<input type="checkbox"/>	<input type="checkbox"/>
Tree Survey 樹木調查	<input type="checkbox"/>	<input type="checkbox"/>
Geotechnical impact assessment 土力影響評估	<input type="checkbox"/>	<input type="checkbox"/>
Drainage impact assessment 排水影響評估	<input type="checkbox"/>	<input type="checkbox"/>
Sewerage impact assessment 排污影響評估	<input type="checkbox"/>	<input type="checkbox"/>
Risk Assessment 風險評估	<input type="checkbox"/>	<input type="checkbox"/>
Others (please specify) 其他（請註明）	<input type="checkbox"/>	<input type="checkbox"/>
Note: May insert more than one 「✓」. 註：可在多於一個方格內加上「✓」號		

Note: The information in the Gist of Application above is provided by the applicant for easy reference of the general public. Under no circumstances will the Town Planning Board accept any liabilities for the use of the information nor any inaccuracies or discrepancies of the information provided. In case of doubt, reference should always be made to the submission of the applicant.

註：上述申請摘要的資料是由申請人提供以方便市民大眾參考。對於所載資料在使用上的問題及文義上的歧異，城市規劃委員會概不負責。若有任何疑問，應查閱申請人提交的文件。

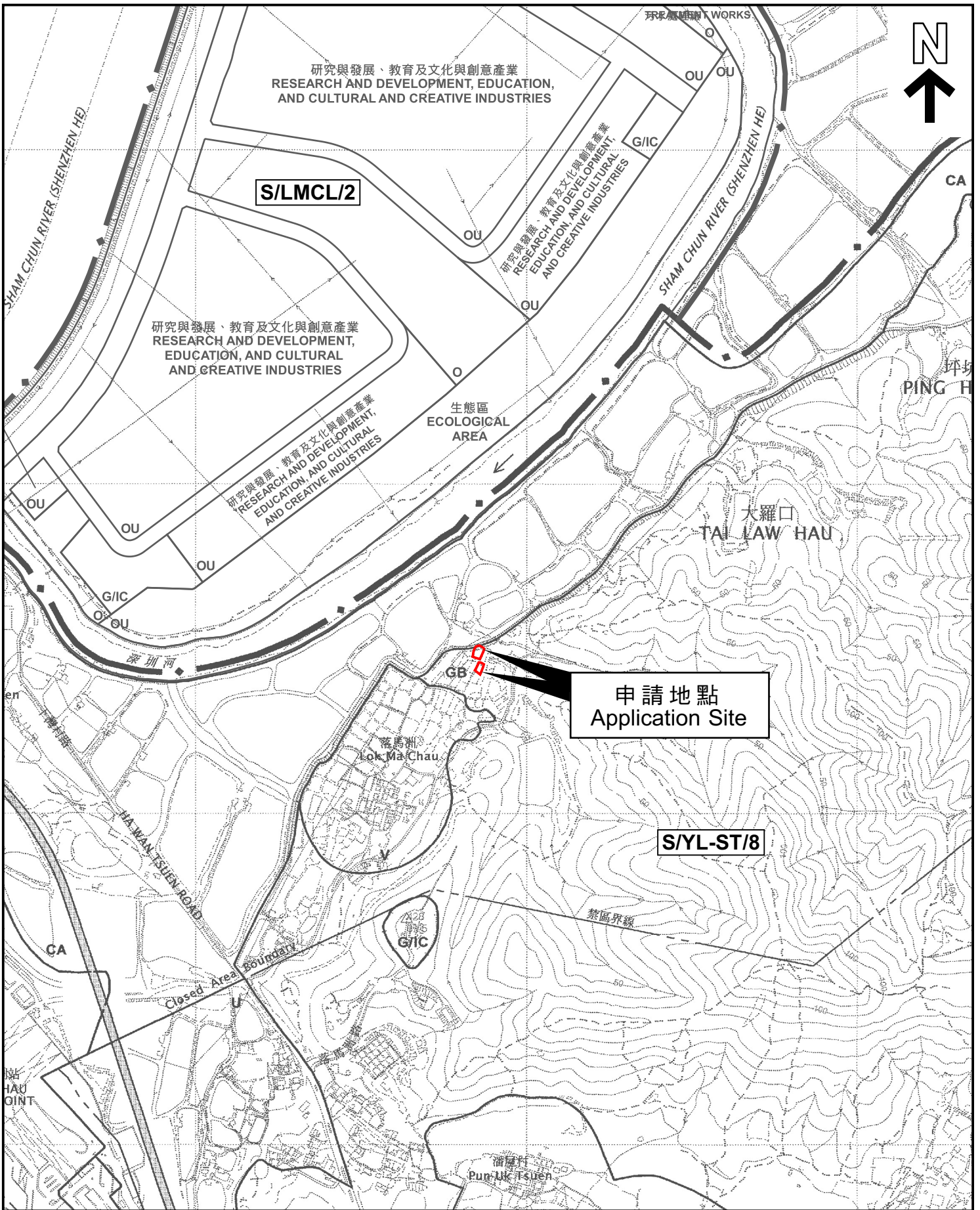

本摘要圖於2023年5月15日擬備，
 所根據的資料為於2006年12月5日
 核准的分區計劃大綱圖編號 S/YL-ST/8
 EXTRACT PLAN PREPARED ON 15.5.2023
 BASED ON OUTLINE ZONING PLAN No.
 S/YL-ST/8 APPROVED ON 5.12.2006

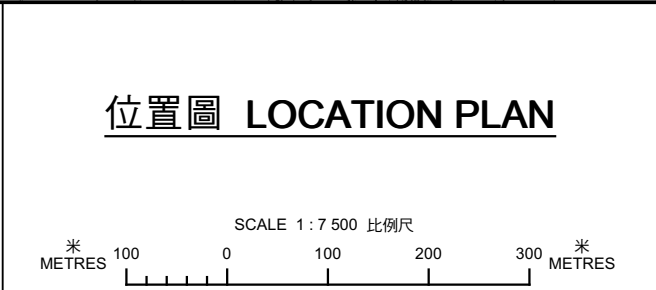

申請地點界線只作識別用
 APPLICATION SITE BOUNDARY
 FOR IDENTIFICATION PURPOSE ONLY

參考編號
 REFERENCE No.
A/YL-ST/649

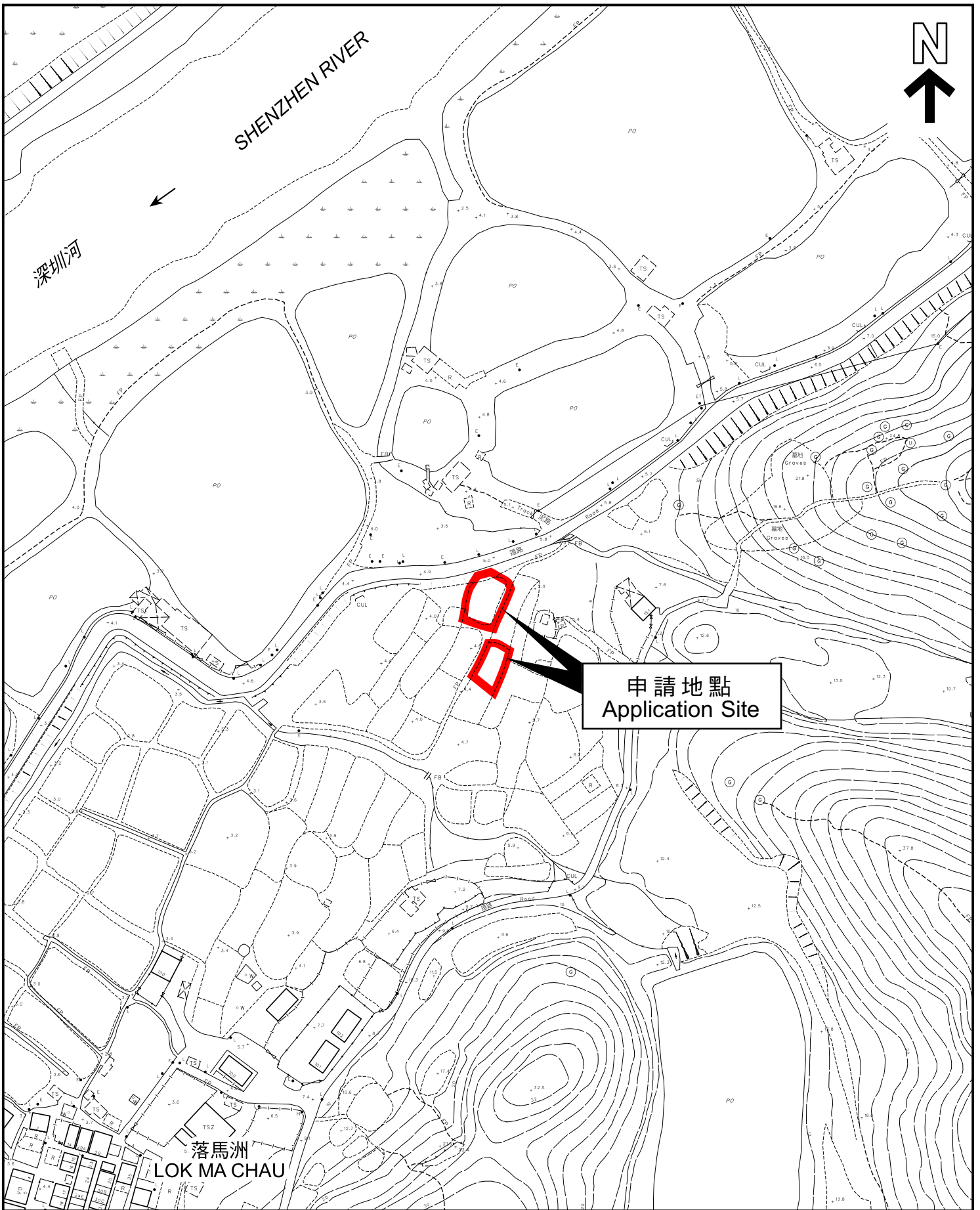

本摘要圖於2023年5月15日擬備，
 所根據的資料為測量圖編號
 2-SE-3B
 EXTRACT PLAN PREPARED ON 15.5.2023
 BASED ON SURVEY SHEET No.
 2-SE-3B

平面圖 SITE PLAN

申請地點界線只作識別用
 APPLICATION SITE BOUNDARY
 FOR IDENTIFICATION PURPOSE ONLY

參考編號
 REFERENCE No.
A/YL-ST/649

申請編號 Application No. : A/YL-ST/649

備註 Remarks

申請人要求批給規劃許可，准許在申請地點進行擬議填土工程（深度約 1.1 米），以作准許的農業用途。申請地點的地盤面積約 374 平方米。

The applicant seeks planning permission for proposed filling of land (about 1.1 m in depth) for permitted agricultural use at the application site (The Site). The site area is about 374 m².

有關資料是為方便市民大眾參考而提供。對於所載資料在使用上的問題及文義上的歧異，城市規劃委員會概不負責。若有任何疑問，應查閱申請人提交的文件。

The information is provided for easy reference of the general public. Under no circumstances will the Town Planning Board accept any liabilities for the use of the information nor any inaccuracies or discrepancies of the information provided. In case of doubt, reference should always be made to the submission of the applicant.

地段索引圖 LOT INDEX PLAN



地政總署測繪處 Survey and Mapping Office, Lands Department

比例尺 SCALE 1:1 000

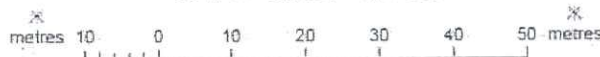

Locality : _____
 Lot Index Plan No. : LIP1351012P
 District Survey Office : DSOYL
 Date : 27-Oct-2022
 Reference No. : 2-SE-3B

香港特別行政區政府 一 版權所有
 © Copyright reserved - Hong Kong SAR Government
 SMO-P01 20221027144222 10

摘要說明：本地段索引圖在背景的地形圖上顯示了各種永久和臨時持有的土地。地圖顯示了、給與土地權的私人地塊、政府撥地、短期租約的地、以及其他允許用途的土地。請注意：(1) 本索引圖上的資料會在不事先通知的情況下更新；(2) 本索引圖的更新可能會與實際情況有所偏差；以及(3) 本索引圖的準確性和可靠性需要專業土地測量師的意見。
免費說明：如閣下用地段索引圖、或依賴該圖的本身或圖則本上推、繪製、選擇或有誤差而引致任何損失或損害，政府概不承擔任何法律責任。

Explanatory notes: This plan shows the graphical boundaries of different kinds of permanent and temporary land holdings with the topographic map in the backdrop. The land holdings as shown may include private lots, government land allocations, short term tenancies and other permitted uses of land. It must be noted that (1) the information shown on this plan is subject to update without prior notification; (2) there may be time lag between an update and the related changes taken place; and (3) the graphical boundaries as shown are for identification purpose only and interpretation of their accuracy and reliability requires the advice from professional land surveyor.
Disclaimer: The Government shall not be responsible for any loss or damage howsoever arising from the use of this plan or in reliance upon its correctness, completeness, timeliness or accuracy.