



New Traffic Circulation  

(Notional layout subject to detailed design upon DSP approval.)

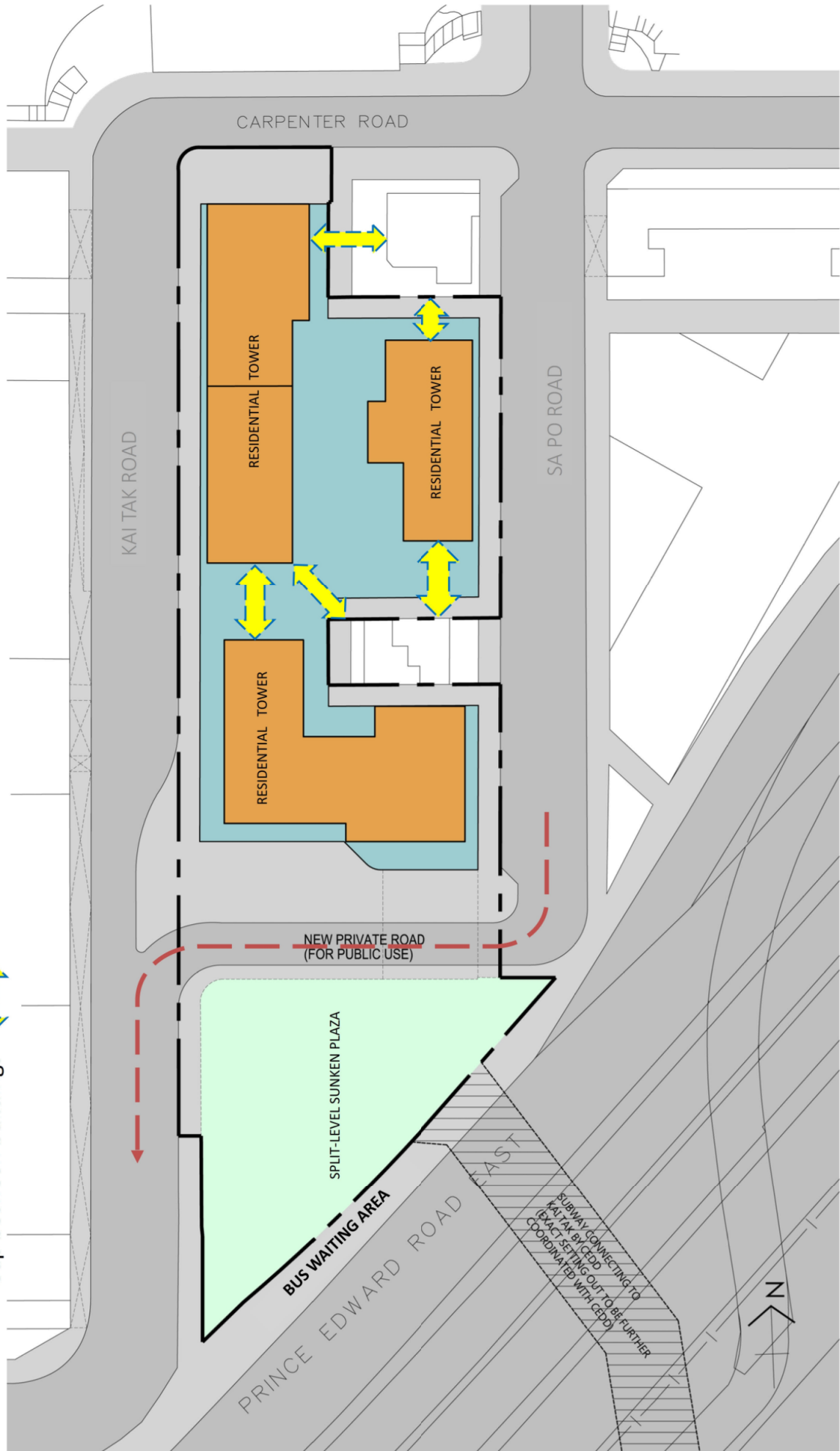

URA Kai Tak Road / Sa Po Road
Development Scheme (KC-015)

Notional Design – Traffic Circulation

Figure 1.3

(資料來源：由市區重建局提交)
(Source: Submitted by Urban Renewal Authority)

<p>參考編號 REFERENCE No. R/S/K10/URA1/1</p>	<p>繪圖 DRAWING H - 1a</p>
--	----------------------------------

(Notional layout subject to detailed design upon DSP approval.)

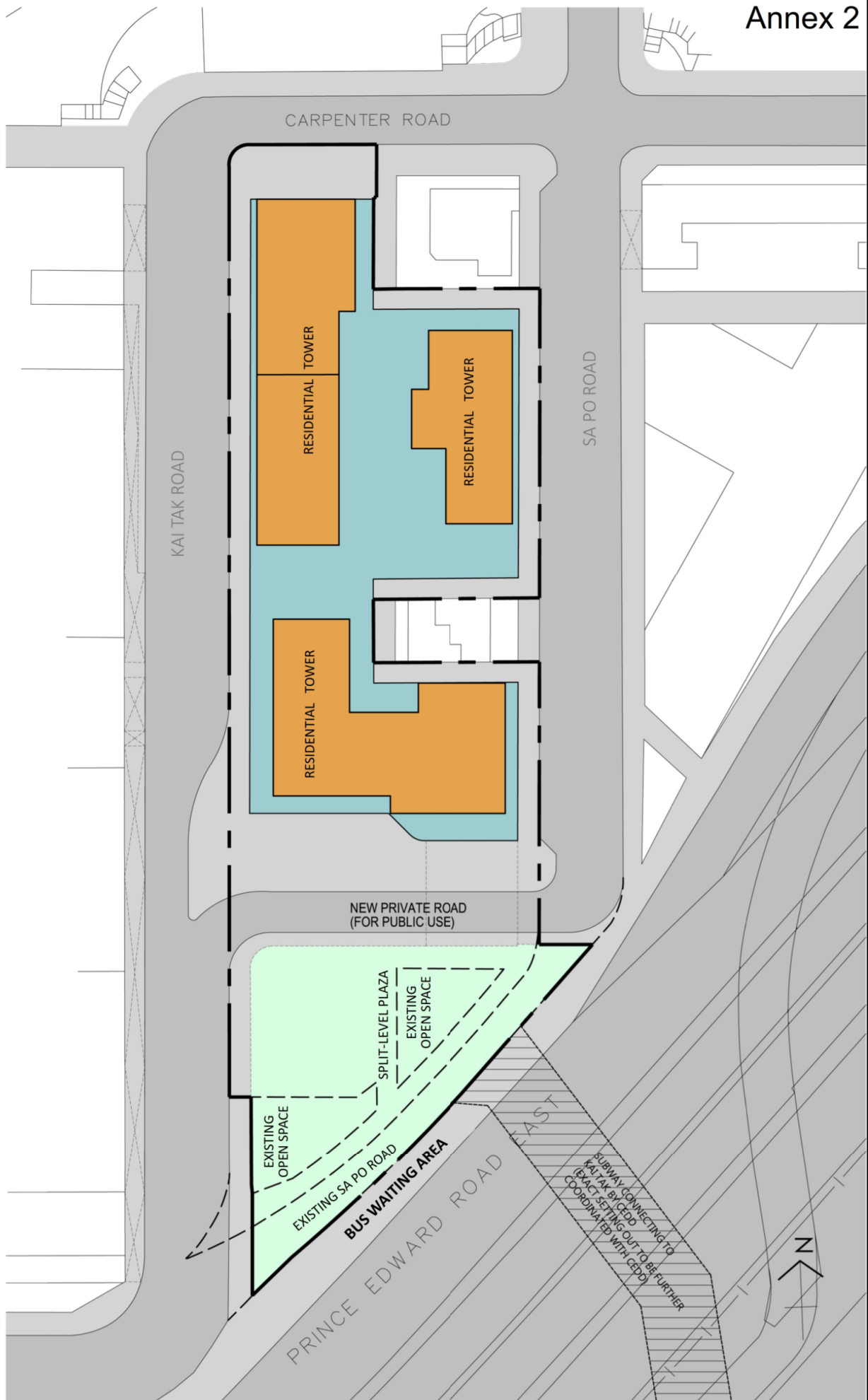

Notional Design – Overlay of new private street with the existing Sa Po Road and amenity areas

URA Kai Tak Road / Sa Po Road Development Scheme (KC-015)



(資料來源：由市區重建局提交)
(Source: Submitted by Urban Renewal Authority)

<p>參考編號 REFERENCE No. R/S/K10/URA1/1</p>	<p>繪圖 DRAWING H - 1b</p>
--	----------------------------------

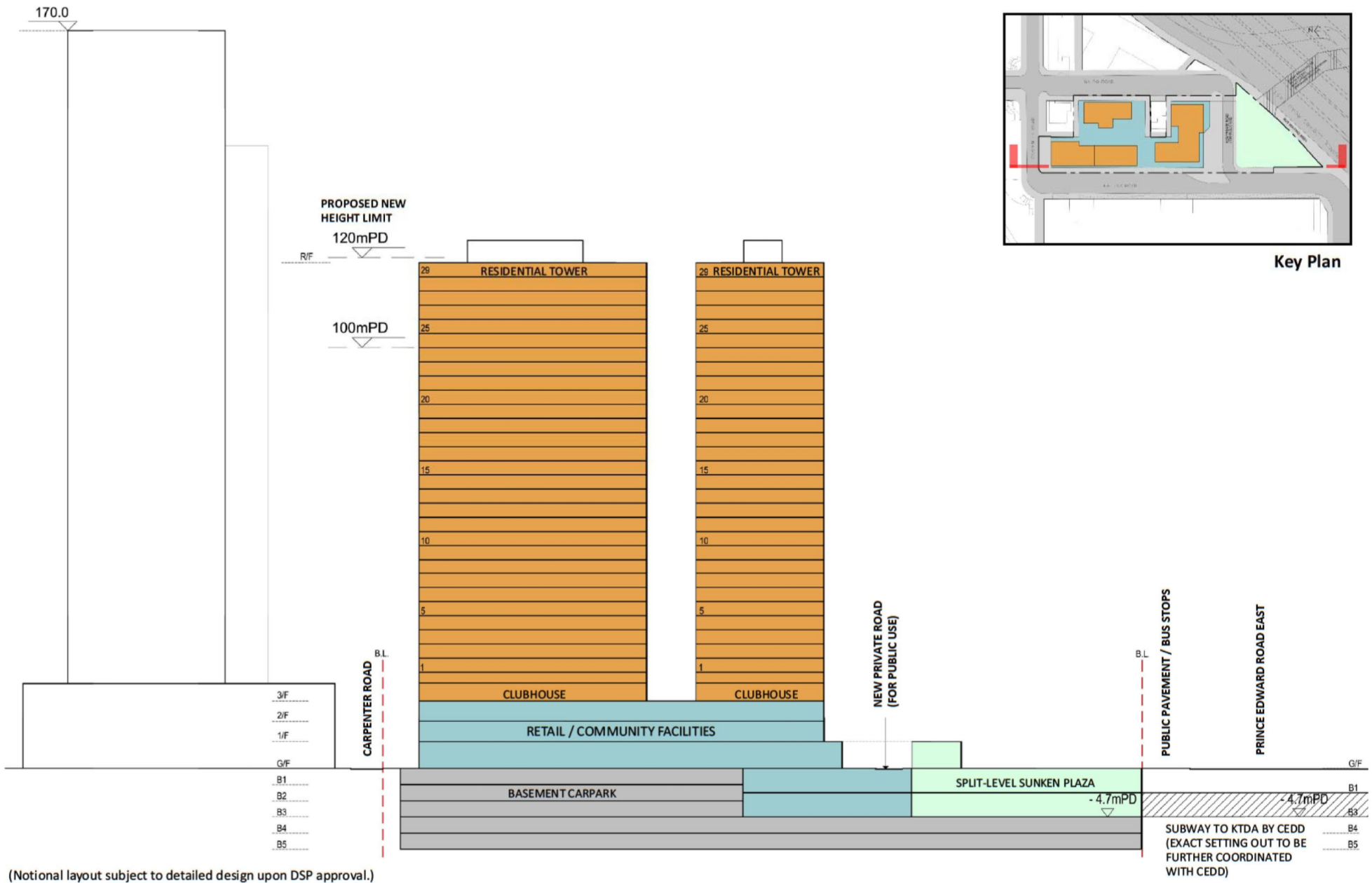

(Notional layout subject to detailed design upon DSP approval.)



URA Kai Tak Road / Sa Po Road
Development Scheme (KC-015)

Notional Design – Schematic Section

Figure 1.2

(資料來源：由市區重建局提交)
(Source: Submitted by Urban Renewal Authority)

參考編號 REFERENCE No. R/S/K10/URA1/1	繪圖 DRAWING H - 2
---	------------------------

Remarks: Notional design subjected to change in detailed design stage

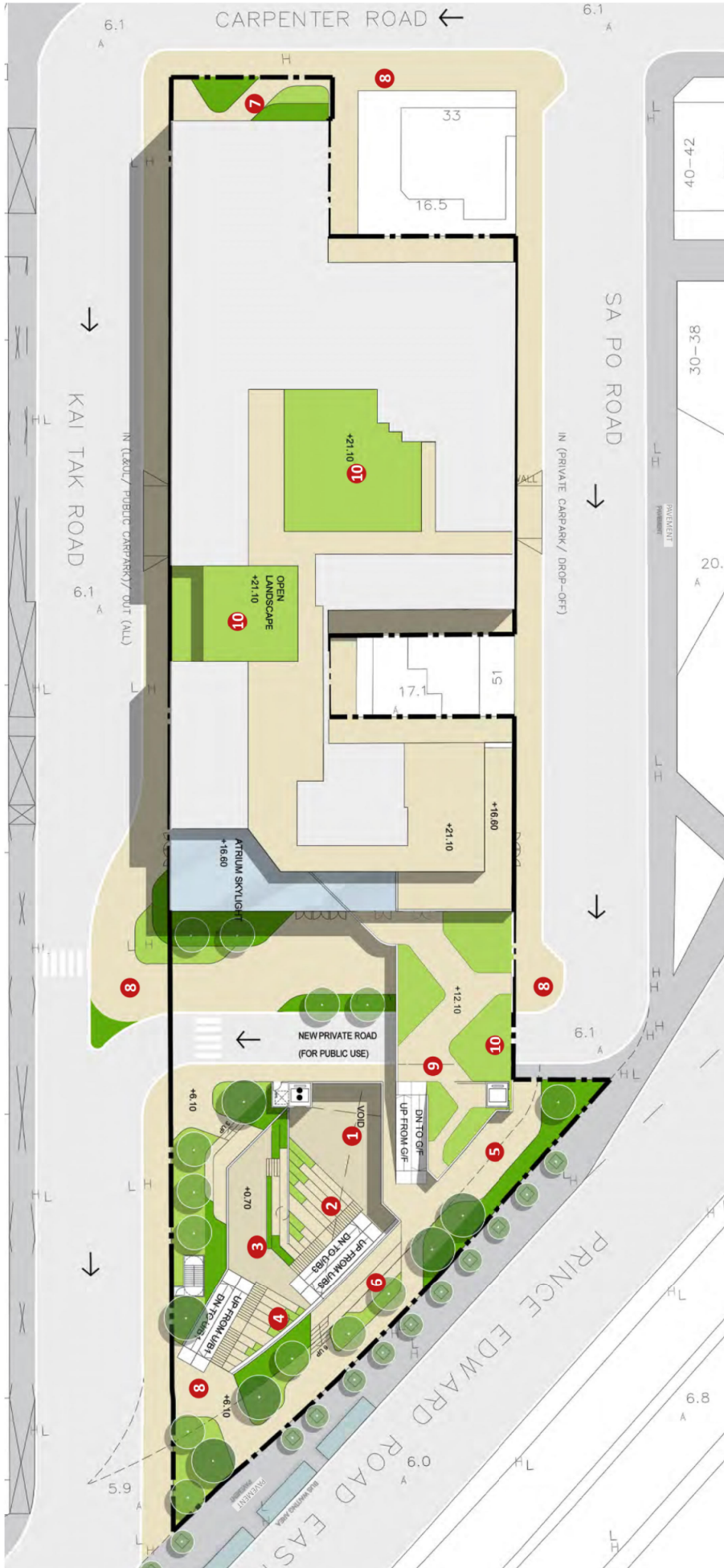

LEGEND

- 1 B3 Sunken Plaza
- 2 B3 Amphitheatre Seating Area
- 3 B1 Sunken Plaza
- 4 B1 Amphitheatre Seating Area
- 5 GF Plaza
- 6 GF Amphitheatre Seating Area
- 7 GF Garden
- 8 GF Pavement
- 9 Upper Level Platorm
- 10 Upper Level Planting Area

FIGURE 2.1 - OVERALL LANDSCAPE PROPOSAL









參考編號 REFERENCE No. R/S/K10/URA1/1	繪圖 DRAWING H - 3
--	-------------------------------

(資料來源：由市區重建局提交)
 (Source: Submitted by Urban Renewal Authority)



LEGEND

-  Poor
-  Varied
-  Marginal
-  Acceptable
-  Satisfactory
-  Projected Condition

(Building conditions survey updated in Jan 2019)



EXTRACT PLAN PREPARED ON 08.11.18
 BASED ON SURVEY SHEET No.11-NE-11A
 & 11-NE-11C

BUILDING CONDITION

DEVELOPMENT SCHEME
 AT KAI TAK ROAD / SA PO ROAD

METRES 15 0 15 30 45 60 75 METRES



KC-015

PLAN
6

(資料來源：由市區重建局提交)
 (Source: Submitted by Urban Renewal Authority)

參考編號
 REFERENCE No.
 R/S/K10/URA1/1

繪圖
 DRAWING
 H - 4

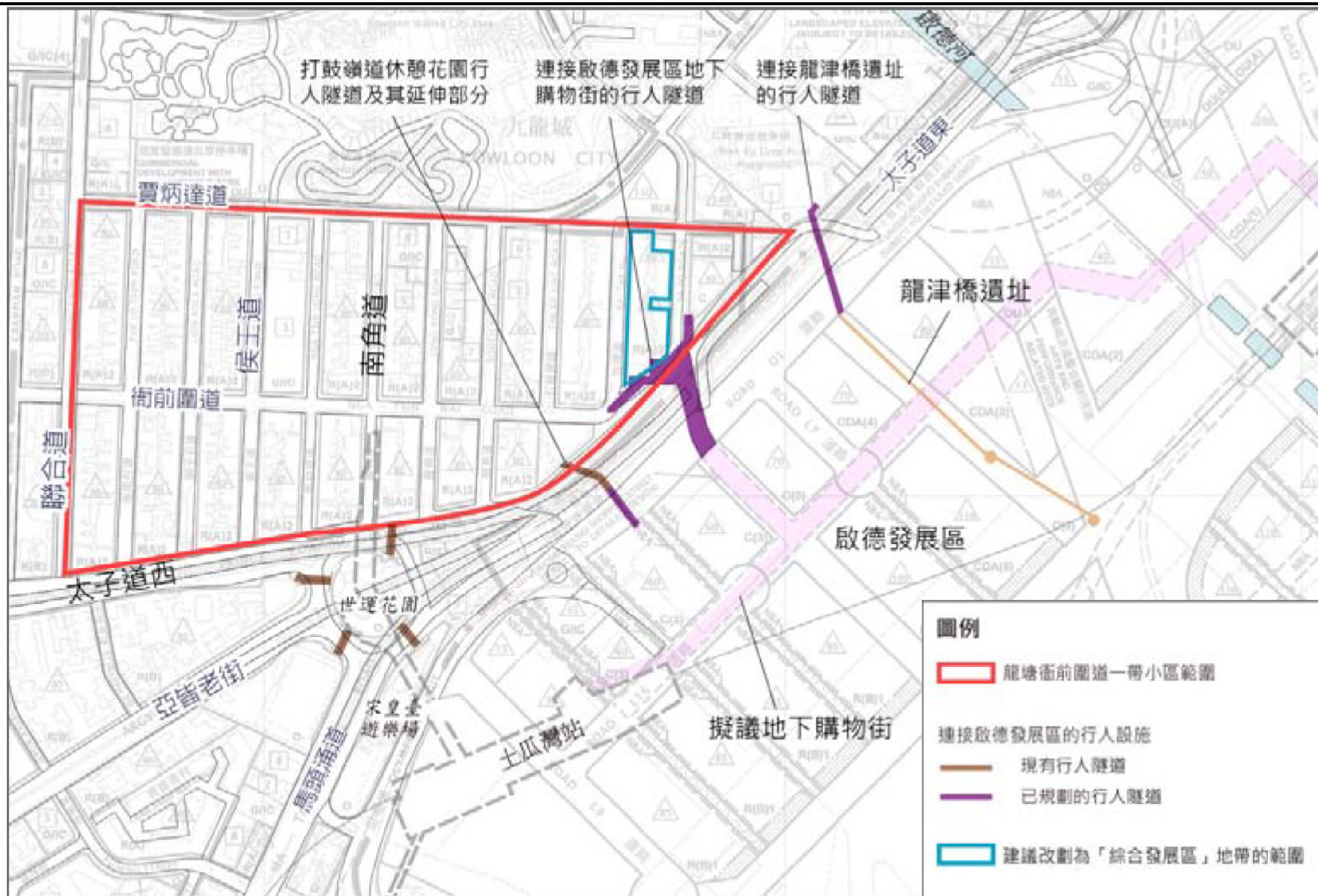

資料來源：九龍城市區更新地區諮詢平台
SOURCE: KOWLOON CITY DURF

本圖於2019年12月18日擬備
PLAN PREPARED ON 18.12.2019

九龍城市區更新計劃
URBAN RENEWAL PLAN FOR KOWLOON CITY

規劃署
PLANNING
DEPARTMENT



參考編號
REFERENCE No.
R/S/K10/URA1/1

圖 PLAN
H - 1

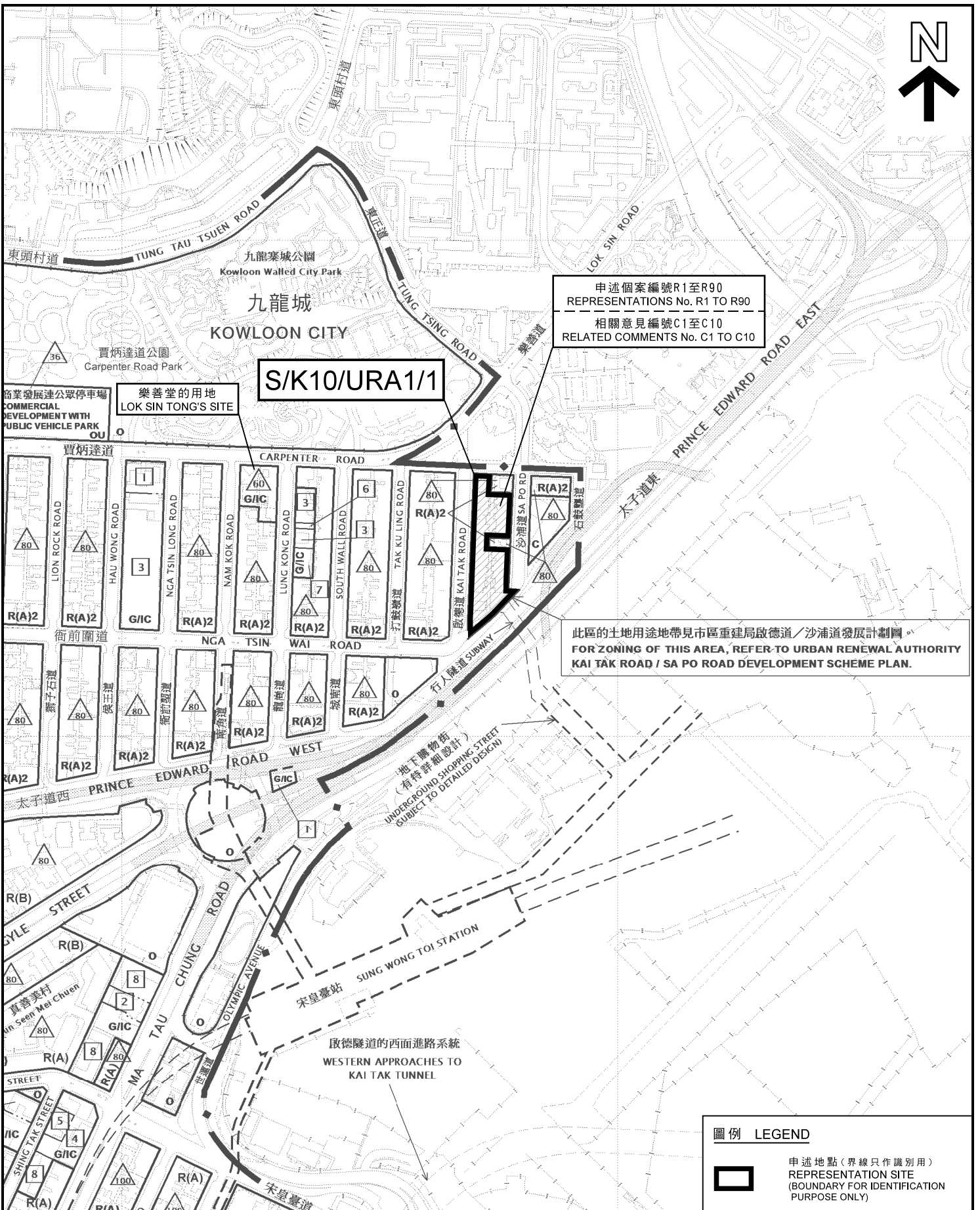

申述個案編號R1至R90
 REPRESENTATIONS No. R1 TO R90
 相關意見編號C1至C10
 RELATED COMMENTS No. C1 TO C10

S/K10/URA1/1

樂善堂的用地
 LOK SIN TONG'S SITE

此區的土地用途地帶市區重建局啟德道/沙浦道發展計劃圖
 FOR ZONING OF THIS AREA, REFER TO URBAN RENEWAL AUTHORITY
 KAI TAK ROAD / SA PO ROAD DEVELOPMENT SCHEME PLAN.

圖例 LEGEND

 申述地點(界線只作識別用)
 REPRESENTATION SITE
 (BOUNDARY FOR IDENTIFICATION
 PURPOSE ONLY)

本摘要圖於2020年1月10日擬備，
 所根據的資料為：
 於2019年7月5日展示的分區計劃大綱圖
 編號S/K10/25，以及於2019年7月5日展示的
 市區重建局發展計劃圖編號S/K10/URA1/1
 EXTRACT PLAN PREPARED ON 10.1.2020
 BASED ON OUTLINE ZONING PLAN No.
 S/K10/25 EXHIBITED ON 5.7.2019 AND
 URA DEVELOPMENT SCHEME PLAN No.
 S/K10/URA1/1 EXHIBITED ON 5.7.2019

位置圖 LOCATION PLAN

就市區重建局啟德道/沙浦道發展計劃草圖編號S/K10/URA1/1
 提出的申述個案編號R1至R90及相關意見編號C1至C10作出考慮
 CONSIDERATION OF REPRESENTATIONS No. R1 TO R90 AND
 RELATED COMMENTS No. C1 TO C10 TO THE DRAFT
 URBAN RENEWAL AUTHORITY KAI TAK ROAD / SA PO ROAD
 DEVELOPMENT SCHEME PLAN No. S/K10/URA1/1

SCALE 1:5 000 比例尺

米 METRES 100 0 100 200 米 METRES

規劃署
 PLANNING
 DEPARTMENT



參考編號
 REFERENCE No.

圖 PLAN

R/S/K10/URA1/1 H - 2

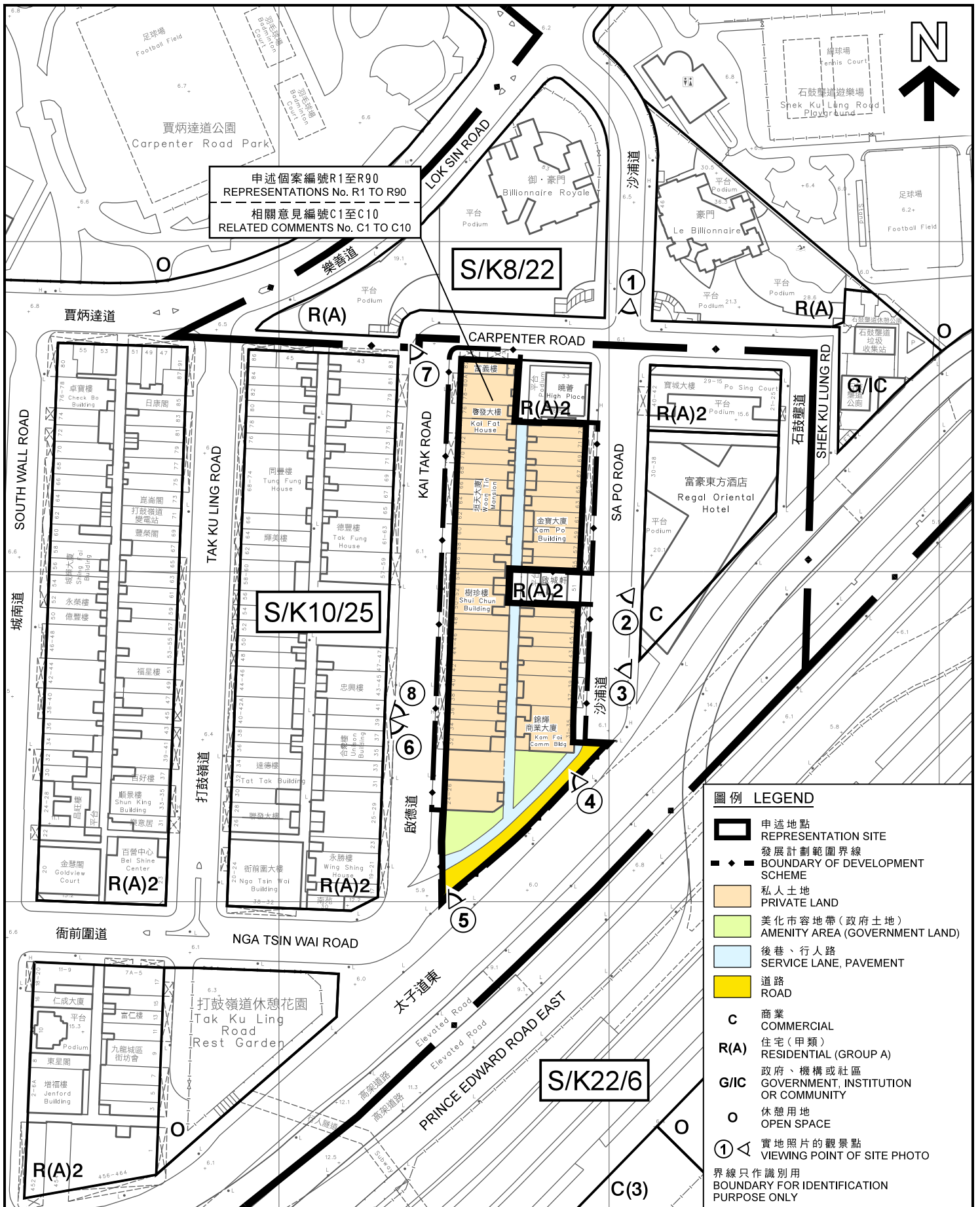

平面圖 SITE PLAN

就市區重建局啟德道/沙浦道發展計劃草圖編號S/K10/URA1/1提出的申述個案編號R1至R90及相關意見編號C1至C10作出考慮
CONSIDERATION OF REPRESENTATIONS No. R1 TO R90 AND RELATED COMMENTS No. C1 TO C10 TO THE DRAFT URBAN RENEWAL AUTHORITY KAI TAK ROAD / SA PO ROAD DEVELOPMENT SCHEME PLAN No. S/K10/URA1/1

SCALE 1 : 1 500 比例尺
米 METRES 20 0 20 40 60 米 METRES

規劃署
PLANNING
DEPARTMENT



參考編號
REFERENCE No.
R/S/K10/URA1/1

圖 PLAN
H - 3

本摘要圖於2019年12月9日擬備，
所根據的資料為測量圖編號
11-NE-11A

EXTRACT PLAN PREPARED ON 9.12.2019
BASED ON SURVEY SHEET No.
11-NE-11A

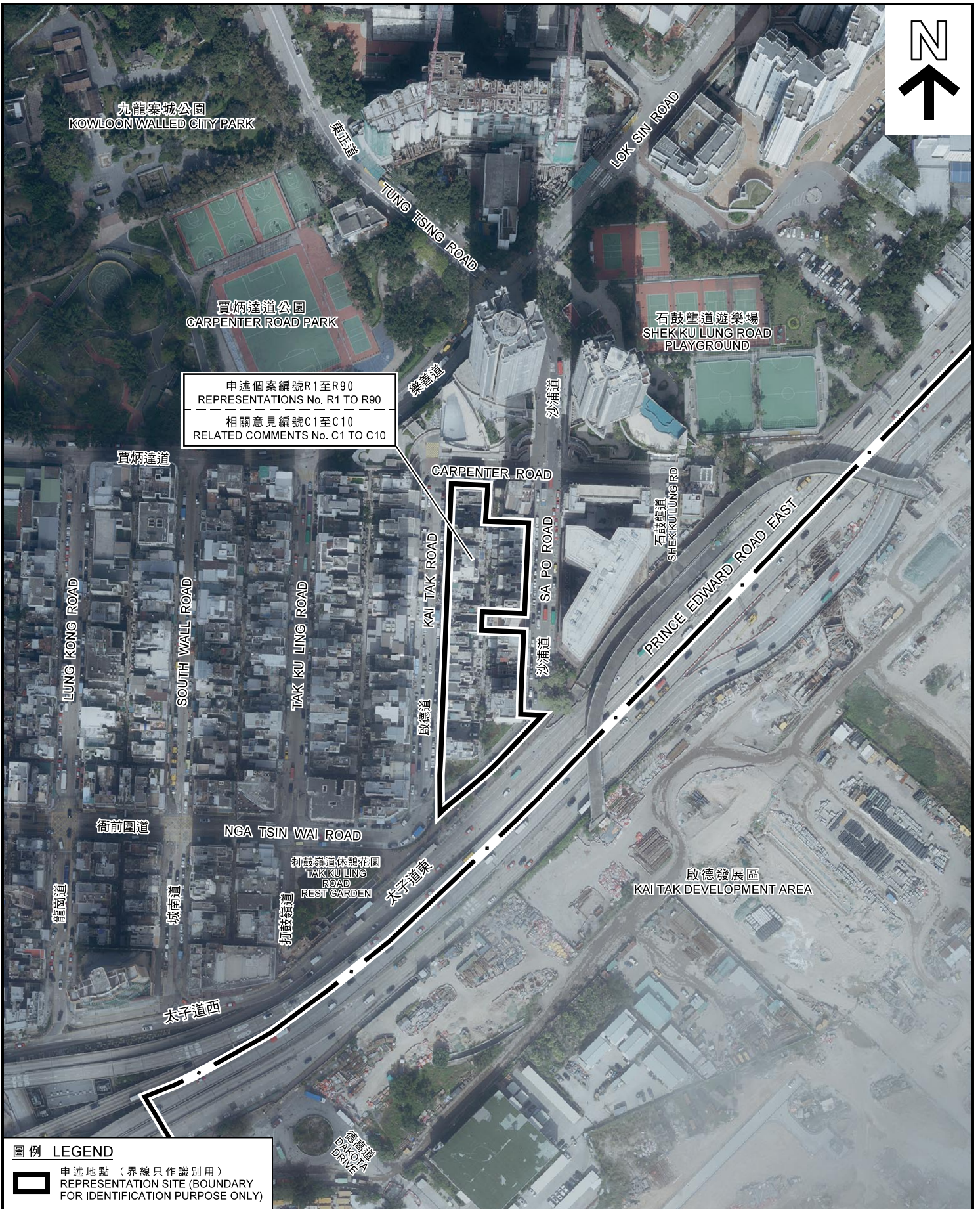

申述個案編號R1至R90
 REPRESENTATIONS No. R1 TO R90
 相關意見編號C1至C10
 RELATED COMMENTS No. C1 TO C10

圖例 LEGEND

 申述地點 (界線只作識別用)
 REPRESENTATION SITE (BOUNDARY FOR IDENTIFICATION PURPOSE ONLY)

本圖於2019年12月18日擬備，
 所根據的資料為地政總署於
 2018年12月27日拍得的
 航攝照片編號E051550C
 PLAN PREPARED ON 18.12.2019
 BASED ON AERIAL PHOTO No.
 E051550C TAKEN ON 27.12.2018
 BY LANDS DEPARTMENT

航攝照片 AERIAL PHOTO

就市區重建局啟德道/沙浦道發展計劃草圖編號S/K10/URA1/1
 提出的申述個案編號R1至R90及相關意見編號C1至C10作出考慮
 CONSIDERATION OF REPRESENTATIONS No. R1 TO R90 AND
 RELATED COMMENTS No. C1 TO C10 TO THE DRAFT
 URBAN RENEWAL AUTHORITY KAI TAK ROAD / SA PO ROAD
 DEVELOPMENT SCHEME PLAN No. S/K10/URA1/1

規劃署
 PLANNING
 DEPARTMENT



參考編號
 REFERENCE No.
 R/S/K10/URA1/1

圖 PLAN
 H - 4

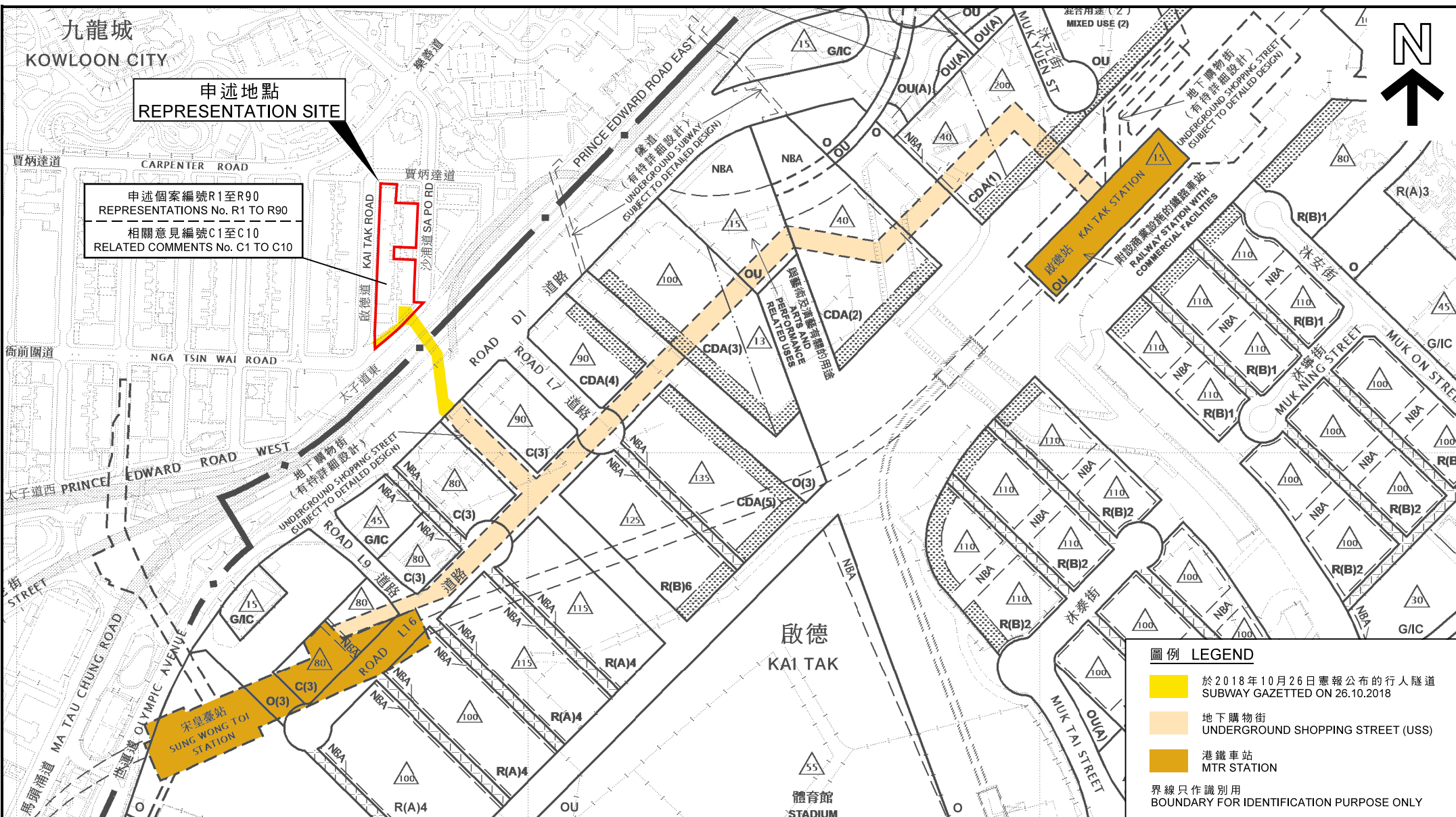

申述地點
REPRESENTATION SITE

申述個案編號R1至R90
REPRESENTATIONS No. R1 TO R90
相關意見編號C1至C10
RELATED COMMENTS No. C1 TO C10

圖例 LEGEND

- 於2018年10月26日憲報公布的行人隧道
SUBWAY GAZETTED ON 26.10.2018
 - 地下購物街
UNDERGROUND SHOPPING STREET (USS)
 - 港鐵車站
MTR STATION
- 界線只作識別用
BOUNDARY FOR IDENTIFICATION PURPOSE ONLY

位置圖 LOCATION PLAN

就市區重建局啟德道/沙浦道發展計劃草圖編號S/K10/URA1/1
提出的申述個案編號R1至R90及相關意見編號C1至C10作出考慮
CONSIDERATION OF REPRESENTATIONS No. R1 TO R90 AND
RELATED COMMENTS No. C1 TO C10 TO THE DRAFT
URBAN RENEWAL AUTHORITY KAI TAK ROAD / SA PO ROAD
DEVELOPMENT SCHEME PLAN No. S/K10/URA1/1

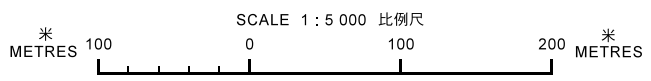

本摘要圖於2019年12月9日擬備，
所根據的資料為於2018年5月15日
核准的分區計劃大綱圖編號S/K22/6
EXTRACT PLAN PREPARED ON 9.12.2019
BASED ON OUTLINE ZONING PLAN No.
S/K22/6 APPROVED ON 15.5.2018

規劃署
PLANNING
DEPARTMENT



參考編號
REFERENCE No.
R/S/K10/URA1/1

圖 PLAN
H - 5

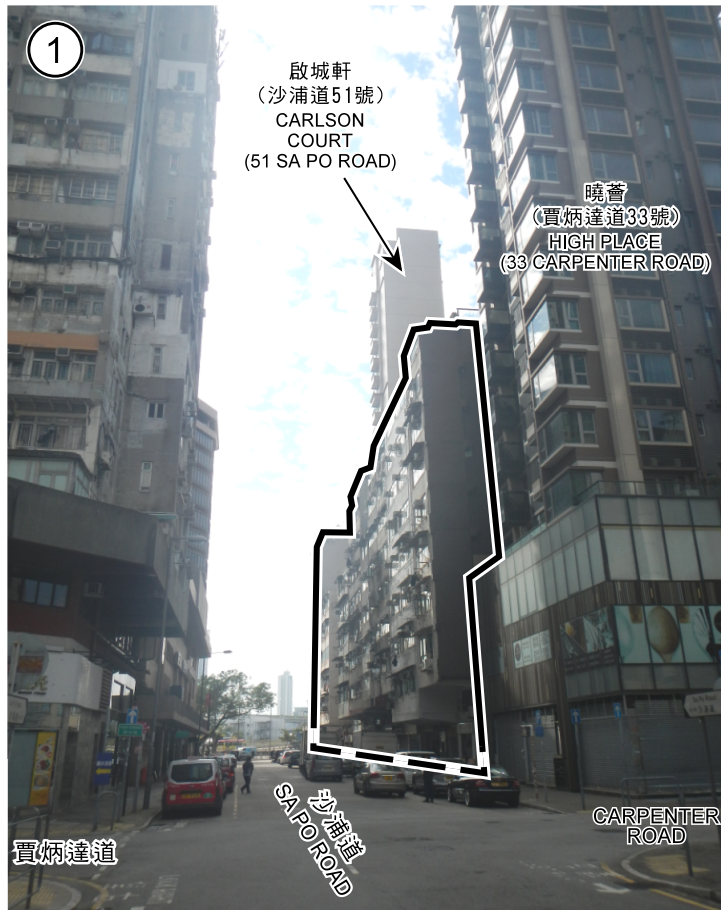

申述地點
REPRESENTATION SITE



申述地點
REPRESENTATION SITE

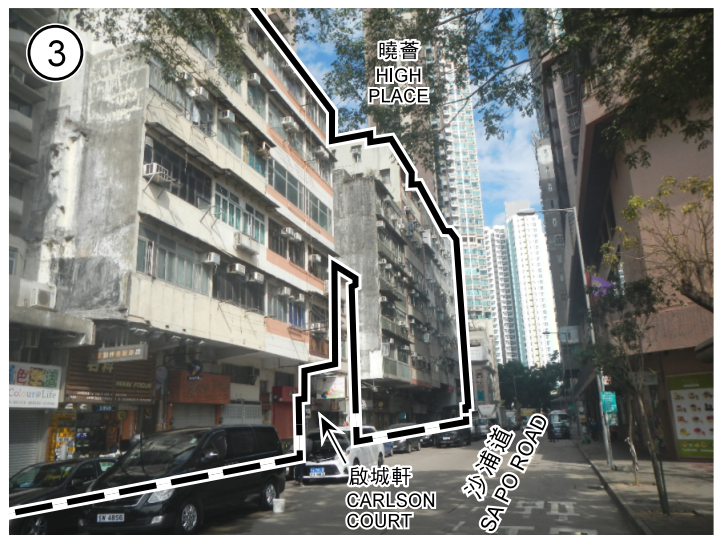

申述地點
REPRESENTATION SITE

界線只作識別用
BOUNDARY FOR IDENTIFICATION
PURPOSE ONLY

本圖於2019年12月9日擬備，
所根據的資料為攝於
2019年12月6日的實地照片
PLAN PREPARED ON 9.12.2019
BASED ON SITE PHOTOS
TAKEN ON 6.12.2019

實地照片 SITE PHOTOS

就市區重建局啟德道/沙浦道發展計劃草圖編號S/K10/URA1/1
提出的申述個案編號R1至R90及相關意見編號C1至C10作出考慮
CONSIDERATION OF REPRESENTATIONS No. R1 TO R90 AND
RELATED COMMENTS No. C1 TO C10 TO THE DRAFT
URBAN RENEWAL AUTHORITY KAI TAK ROAD / SA PO ROAD
DEVELOPMENT SCHEME PLAN No. S/K10/URA1/1

規劃署
PLANNING
DEPARTMENT



參考編號
REFERENCE No.
R/S/K10/URA1/1

圖 PLAN
H - 6

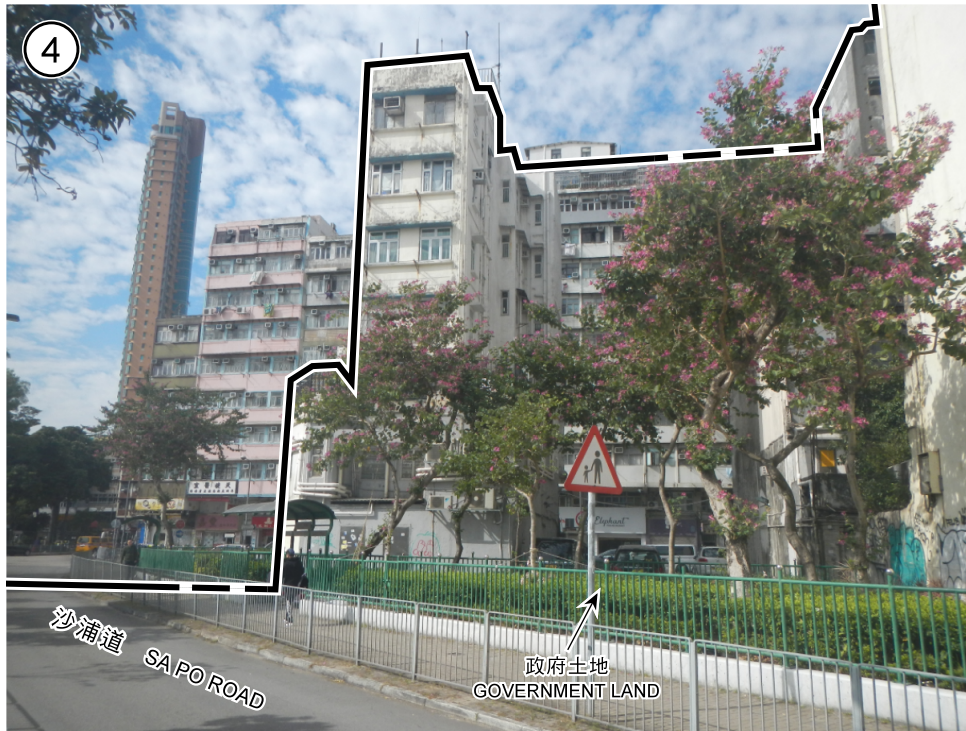

申述地點
REPRESENTATION SITE



申述地點
REPRESENTATION SITE

界線只作識別用
BOUNDARY FOR IDENTIFICATION
PURPOSE ONLY

本圖於2019年12月9日擬備，
所根據的資料為攝於
2019年12月6日的實地照片
PLAN PREPARED ON 9.12.2019
BASED ON SITE PHOTOS
TAKEN ON 6.12.2019

實地照片 SITE PHOTOS

就市區重建局啟德道/沙浦道發展計劃草圖編號S/K10/URA1/1
提出的申述個案編號R1至R90及相關意見編號C1至C10作出考慮
CONSIDERATION OF REPRESENTATIONS No. R1 TO R90 AND
RELATED COMMENTS No. C1 TO C10 TO THE DRAFT
URBAN RENEWAL AUTHORITY KAI TAK ROAD / SA PO ROAD
DEVELOPMENT SCHEME PLAN No. S/K10/URA1/1

規劃署
PLANNING
DEPARTMENT



參考編號
REFERENCE No.
R/S/K10/URA1/1

圖 PLAN
H - 7



申述地點
REPRESENTATION SITE

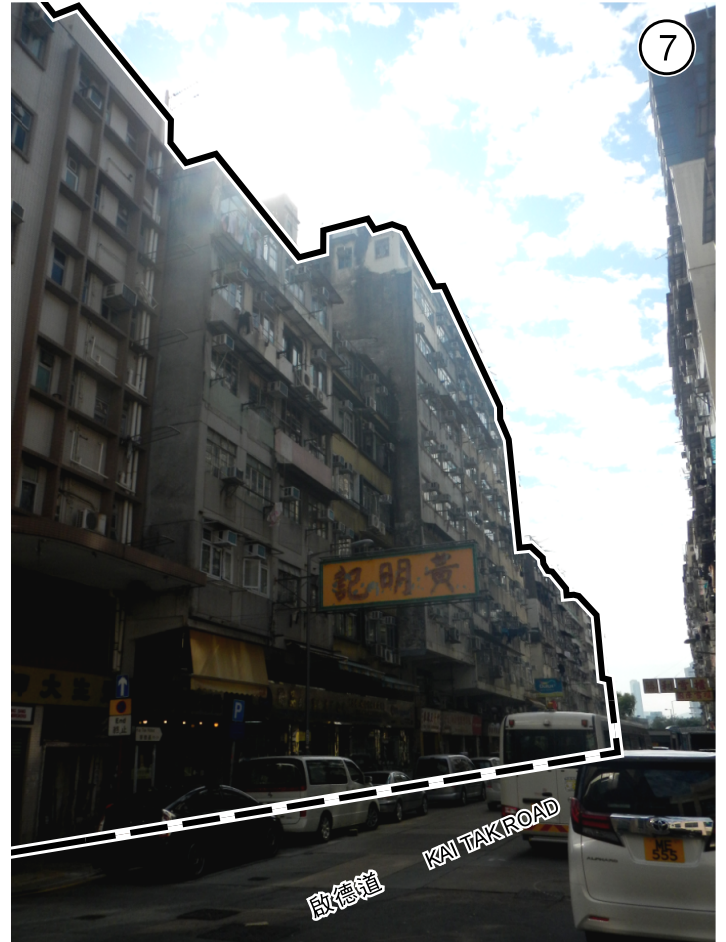

申述地點
REPRESENTATION SITE

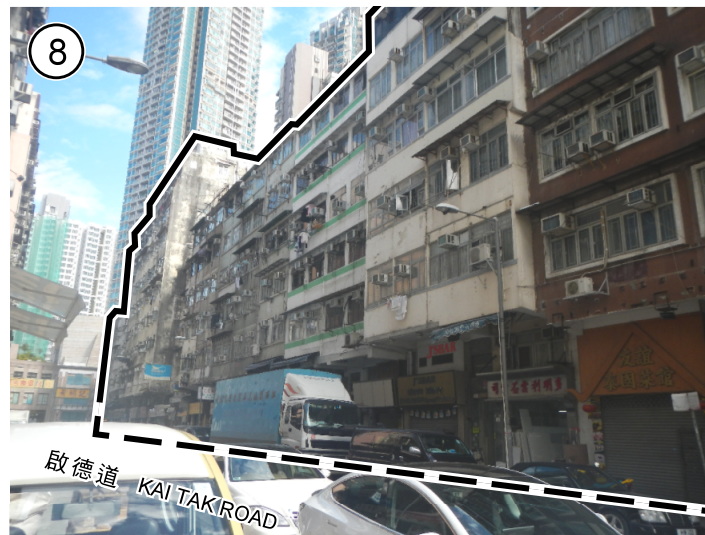

申述地點
REPRESENTATION SITE

界線只作識別用
BOUNDARY FOR IDENTIFICATION
PURPOSE ONLY

本圖於2019年12月9日擬備，
所根據的資料為攝於
2019年12月6日的實地照片
PLAN PREPARED ON 9.12.2019
BASED ON SITE PHOTOS
TAKEN ON 6.12.2019

實地照片 SITE PHOTOS

就市區重建局啟德道/沙浦道發展計劃草圖編號S/K10/URA1/1
提出的申述個案編號R1至R90及相關意見編號C1至C10作出考慮
CONSIDERATION OF REPRESENTATIONS No. R1 TO R90 AND
RELATED COMMENTS No. C1 TO C10 TO THE DRAFT
URBAN RENEWAL AUTHORITY KAI TAK ROAD / SA PO ROAD
DEVELOPMENT SCHEME PLAN No. S/K10/URA1/1

規劃署
PLANNING
DEPARTMENT



參考編號
REFERENCE No.
R/S/K10/URA1/1

圖 PLAN
H - 8

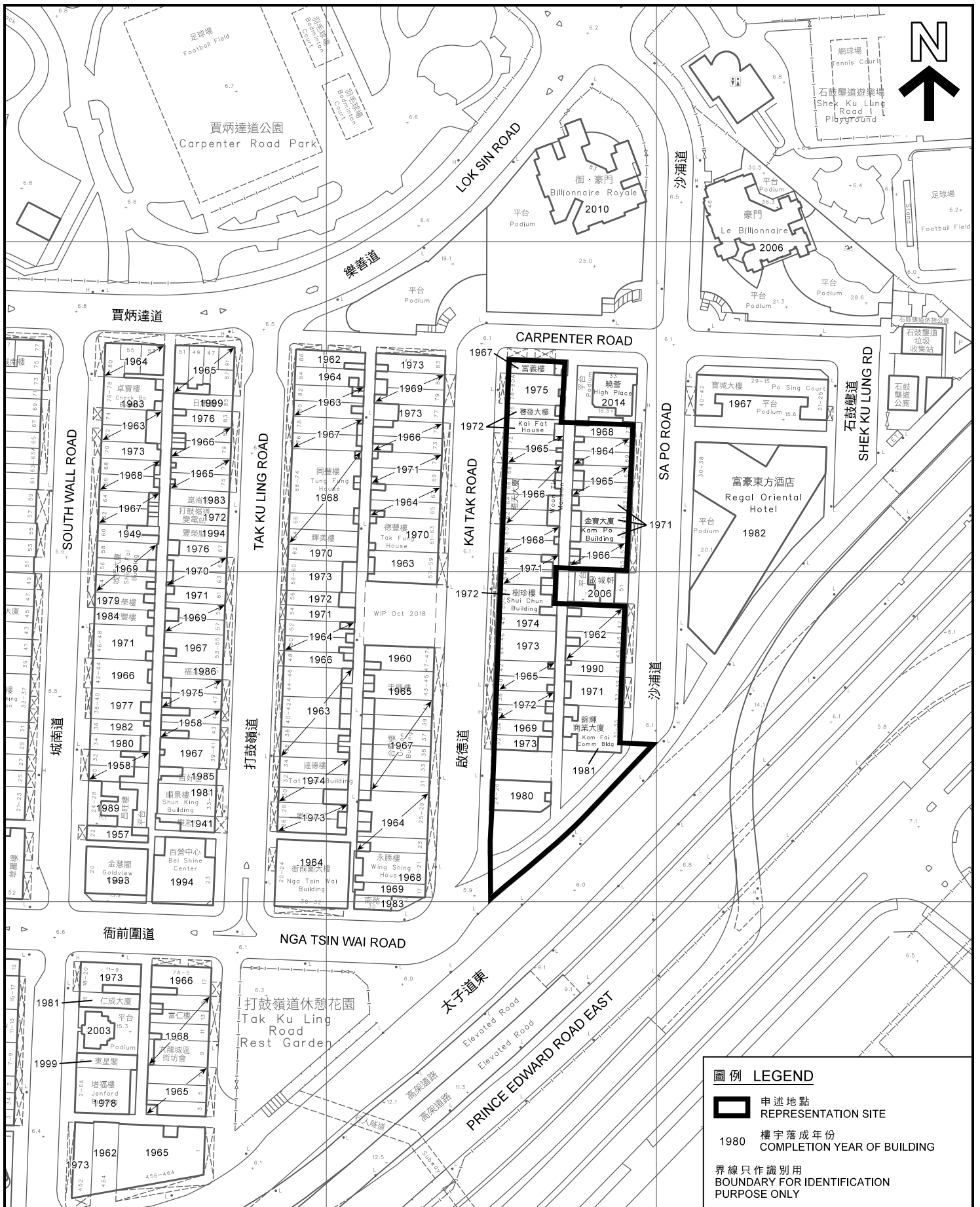

圖例 LEGEND

- 申述地點 REPRESENTATION SITE
- 1980 樓宇落成年份 COMPLETION YEAR OF BUILDING
- 界線只作識別用 BOUNDARY FOR IDENTIFICATION PURPOSE ONLY

平面圖 SITE PLAN

就市區重建局啟德道/沙浦道發展計劃草圖編號S/K10/URA1/1提出的申述個案編號R1至R90及相關意見編號C1至C10作出考慮
 CONSIDERATION OF REPRESENTATIONS No. R1 TO R90 AND RELATED COMMENTS No. C1 TO C10 TO THE DRAFT URBAN RENEWAL AUTHORITY KAI TAK ROAD / SA PO ROAD DEVELOPMENT SCHEME PLAN No. S/K10/URA1/1

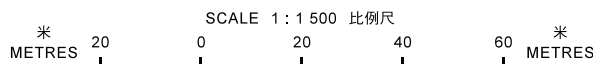

規劃署
PLANNING DEPARTMENT



參考編號
 M/K10/19/1
R/S/K10/URA1/1

圖 PLAN
H - 9a

本摘要圖於2019年12月10日擬備，
 所根據的資料為測量圖編號
 11-NE-11A

EXTRACT PLAN PREPARED ON 10.12.2019
 BASED ON SURVEY SHEET No.
 11-NE-11A

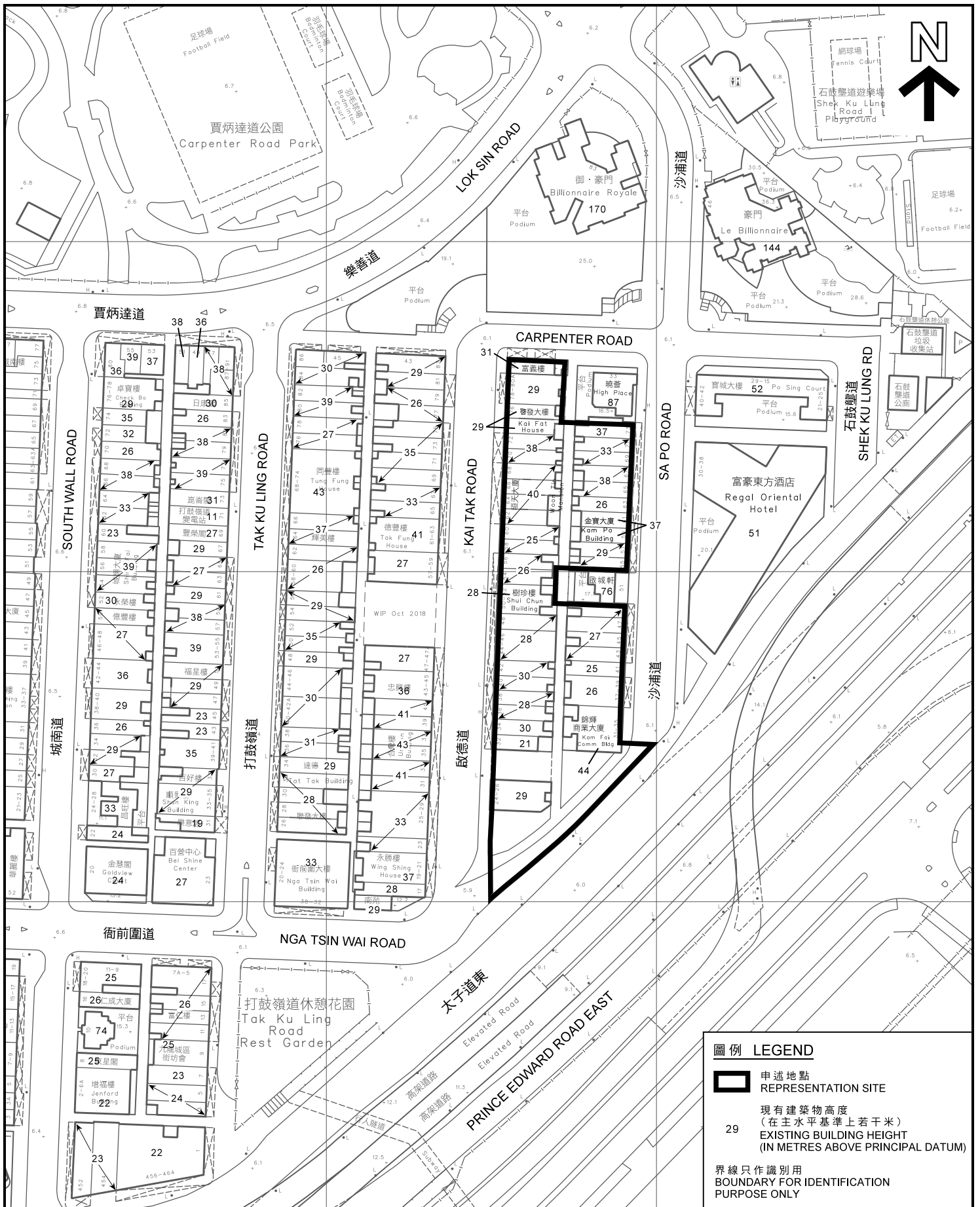

圖例 LEGEND

- 申述地點
REPRESENTATION SITE
- 29 現有建築物高度
(在主水平基準上若干米)
EXISTING BUILDING HEIGHT
(IN METRES ABOVE PRINCIPAL DATUM)
- 界線只作識別用
BOUNDARY FOR IDENTIFICATION
PURPOSE ONLY

平面圖 SITE PLAN

就市區重建局啟德道/沙浦道發展計劃草圖編號S/K10/URA1/1
提出的申述個案編號R1至R90及相關意見編號C1至C10作出考慮
CONSIDERATION OF REPRESENTATIONS No. R1 TO R90 AND
RELATED COMMENTS No. C1 TO C10 TO THE DRAFT
URBAN RENEWAL AUTHORITY KAI TAK ROAD / SA PO ROAD
DEVELOPMENT SCHEME PLAN No. S/K10/URA1/1

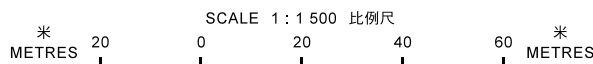

規劃署
PLANNING
DEPARTMENT



參考編號
M/K10/19/1
R/S/K10/URA1/1

圖 PLAN
H - 9b

本摘要圖於2019年12月10日擬備，
所根據的資料為測量圖編號
11-NE-11A

EXTRACT PLAN PREPARED ON 10.12.2019
BASED ON SURVEY SHEET No.
11-NE-11A

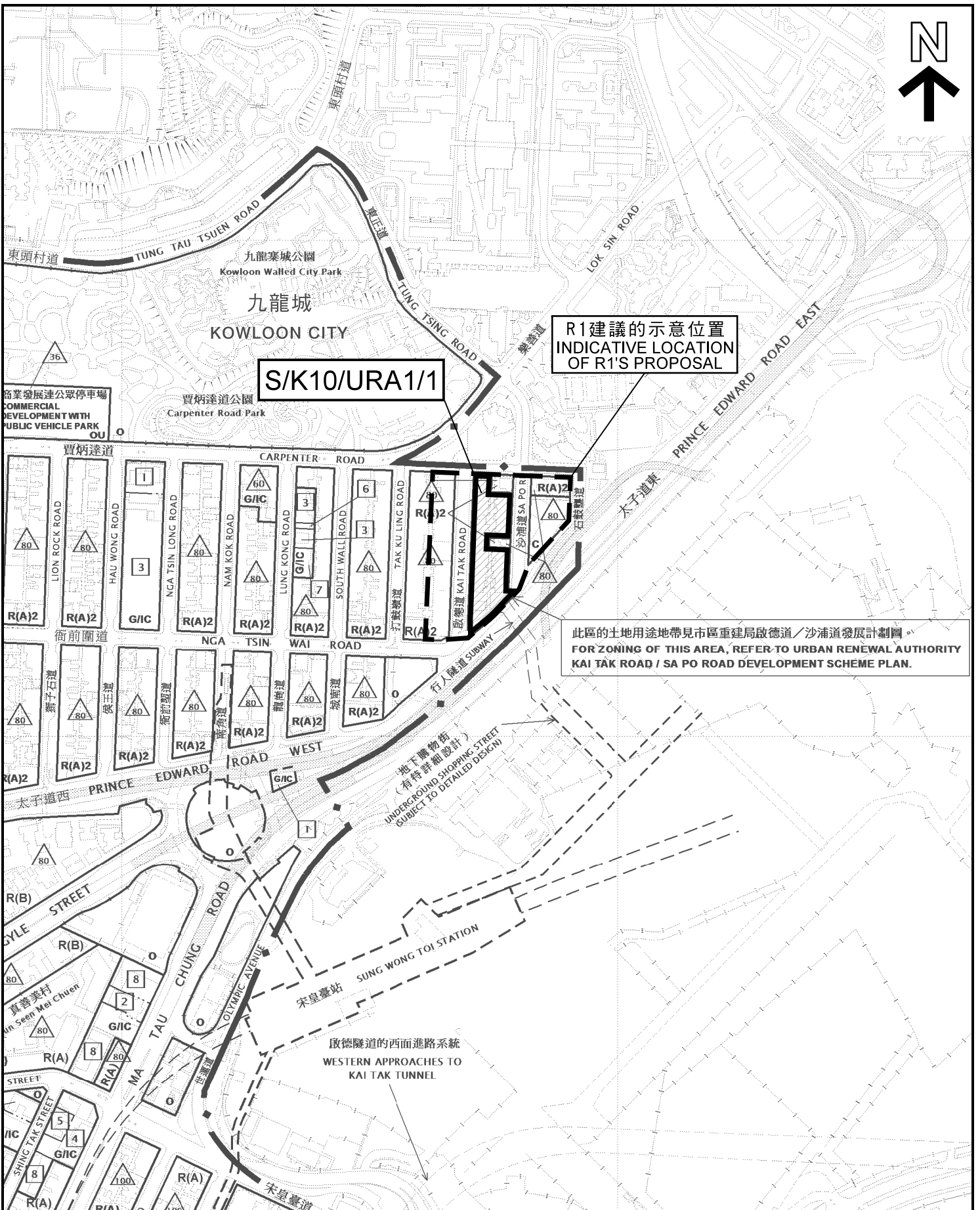

本摘要圖於2020年1月14日擬備，
 所根據的資料為：
 於2019年7月5日展示的分區計劃大綱圖
 編號S/K10/25，以及於2019年7月5日展示的
 市區重建局發展計劃圖編號S/K10/URA1/1
 EXTRACT PLAN PREPARED ON 14.1.2020
 BASED ON OUTLINE ZONING PLAN No.
 S/K10/25 EXHIBITED ON 5.7.2019 AND
 URA DEVELOPMENT SCHEME PLAN No.
 S/K10/URA1/1 EXHIBITED ON 5.7.2019

R1建議的示意位置
INDICATIVE LOCATION OF R1'S PROPOSAL

就市區重建局啟德道/沙浦道發展計劃草圖編號S/K10/URA1/1
 提出的申述個案編號R1至R90及相關意見編號C1至C10作出考慮
 CONSIDERATION OF REPRESENTATIONS No. R1 TO R90 AND
 RELATED COMMENTS No. C1 TO C10 TO THE DRAFT
 URBAN RENEWAL AUTHORITY KAI TAK ROAD / SA PO ROAD
 DEVELOPMENT SCHEME PLAN No. S/K10/URA1/1
 SCALE 1 : 5 000 比例尺

米 100 0 100 200 米
 METRES

<p>規劃署 PLANNING DEPARTMENT</p>	
<p>參考編號 REFERENCE No.</p> <p>R/S/K10/URA1/1</p>	<p>圖 PLAN</p> <p>H - 10</p>

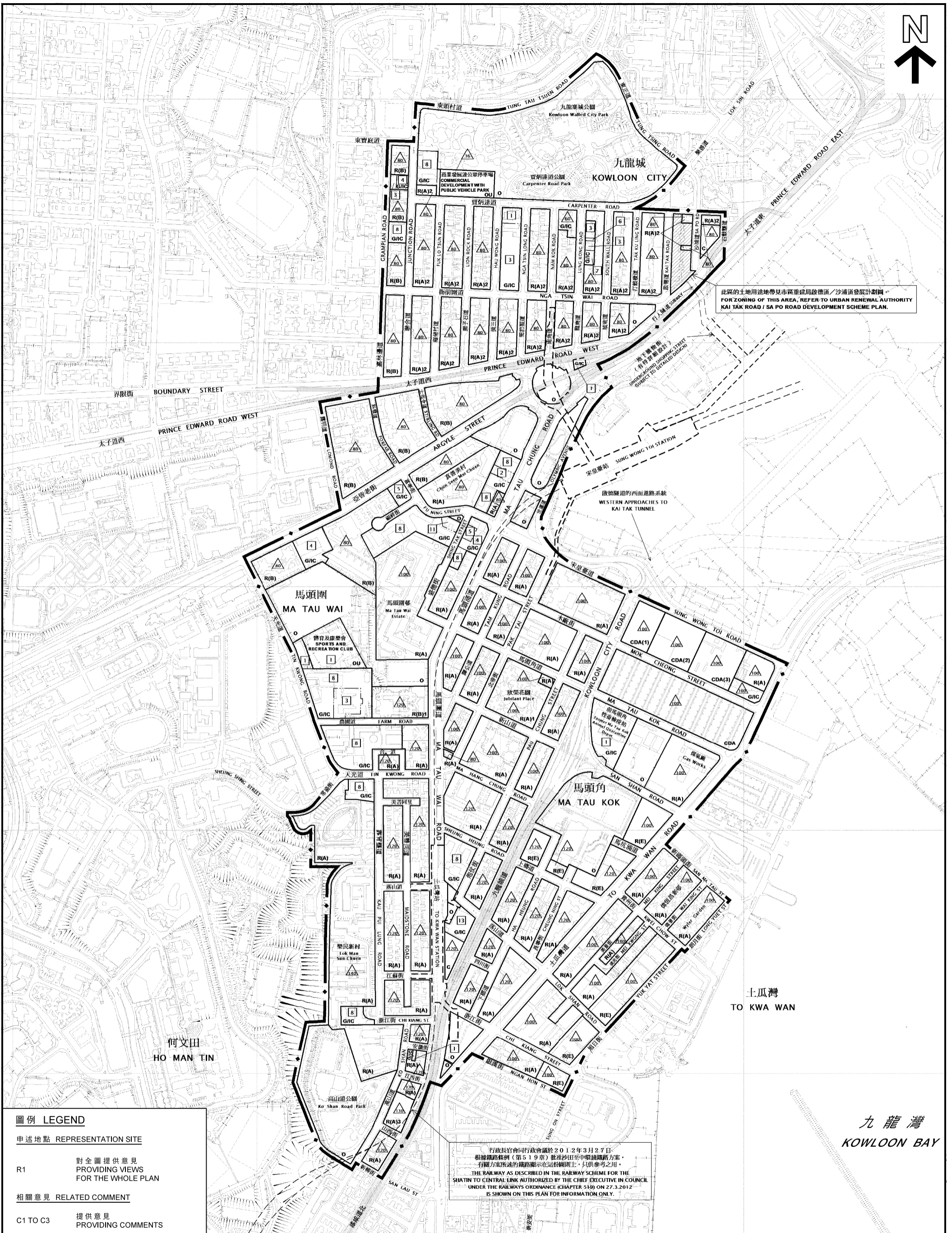

圖例 LEGEND

申述地點 REPRESENTATION SITE

R1 對全圖提供意見
PROVIDING VIEWS
FOR THE WHOLE PLAN

相關意見 RELATED COMMENT

C1 TO C3 提供意見
PROVIDING COMMENTS

位置圖 LOCATION PLAN

就馬頭角分區計劃大綱草圖編號S/K10/25
提出的申述個案編號R1及相關意見C1至C3作出考慮
CONSIDERATION OF REPRESENTATION No. R1
AND RELATED COMMENTS No. C1 TO C3 TO THE
DRAFT MA TAU KOK OUTLINE ZONING PLAN No. S/K10/25

SCALE 1:7 000 比例尺
METRES 100 0 100 200 300 METRES

本摘要圖於2020年1月9日擬備，
所根據的資料為於2019年7月5日
展示的分區計劃大綱圖編號S/K10/25
EXTRACT PLAN PREPARED ON 9.1.2020
BASED ON OUTLINE ZONING PLAN No.
S/K10/25 EXHIBITED ON 5.7.2019

規劃署
PLANNING
DEPARTMENT



參考編號
REFERENCE No.
R/S/K10/25

圖 PLAN
H - 11

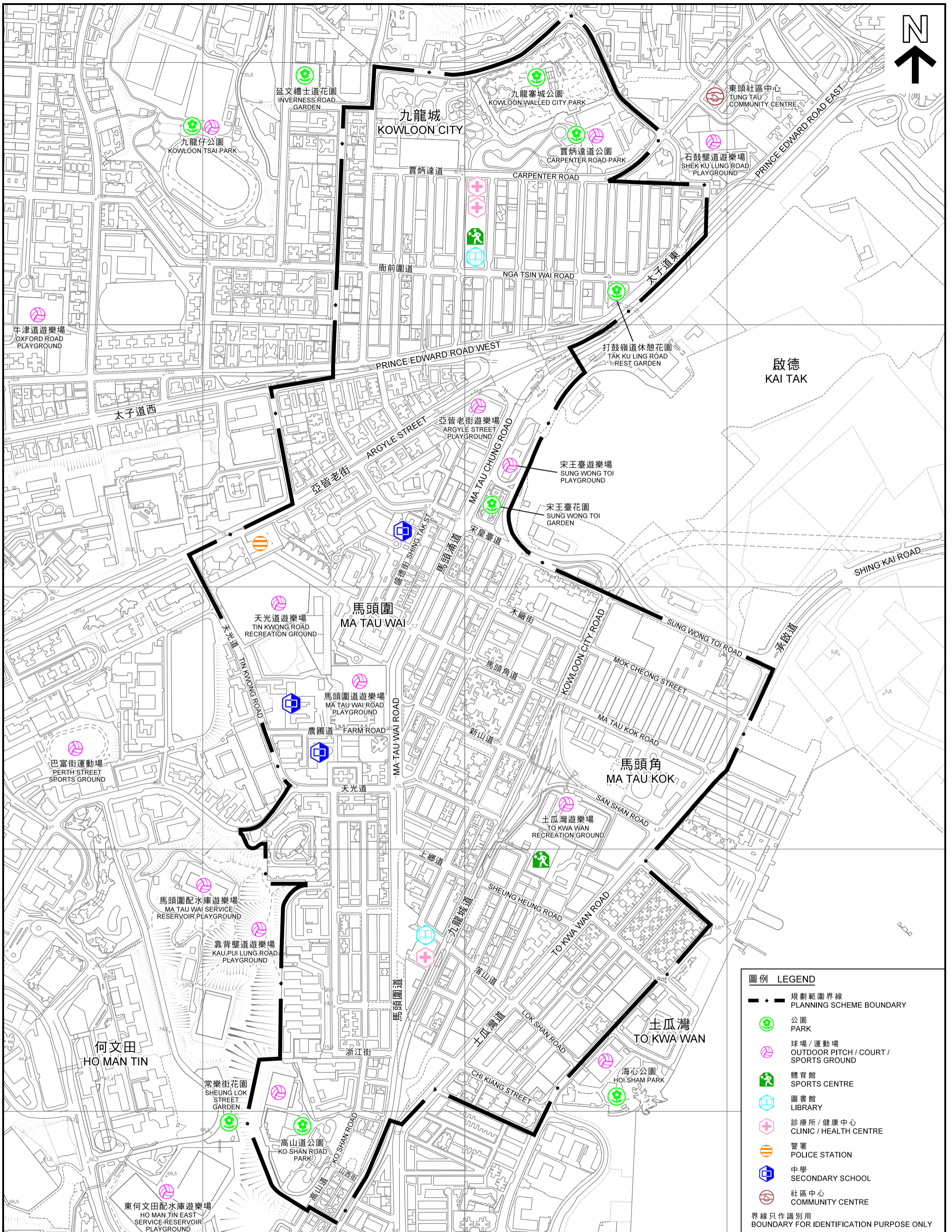

圖例 LEGEND	
	規劃範圍界線 PLANNING SCHEME BOUNDARY
	公園 PARK
	球場/運動場 OUTDOOR PITCH / COURT / SPORTS GROUND
	體育館 SPORTS CENTRE
	圖書館 LIBRARY
	診所/健康中心 CLINIC / HEALTH CENTRE
	警署 POLICE STATION
	中學 SECONDARY SCHOOL
	社區中心 COMMUNITY CENTRE
界線只作識別用 BOUNDARY FOR IDENTIFICATION PURPOSE ONLY	

位置圖 LOCATION PLAN

本摘要圖於2020年1月9日擬備，
所根據的資料為地形圖編號
11-NE-A、C、11-NW-B和D
EXTRACT PLAN PREPARED ON 9.1.2020
BASED ON TOPOGRAPHIC MAPS No.
11-NE-A, C, 11-NW-B & D

馬頭角及鄰近地區的主要現有休憩用地及政府、機構及社區設施
MAJOR EXISTING OPEN SPACE AND GOVERNMENT, INSTITUTION AND COMMUNITY FACILITIES
IN MA TAU KOK AND VICINITY AREA

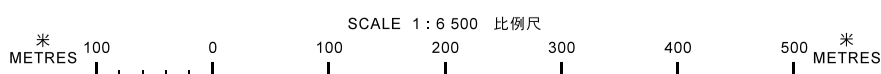

規劃署
PLANNING
DEPARTMENT



參考編號
REFERENCE No.
R/S/K10/25
R/S/K10/URA1/1

圖 PLAN
H - 12