

申請地點
Application Site

位置圖 LOCATION PLAN

申請地點界線只作識別用
APPLICATION SITE BOUNDARY
FOR IDENTIFICATION PURPOSE ONLY

參考編號
REFERENCE No.

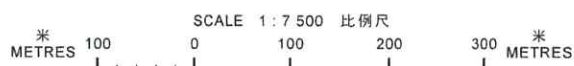

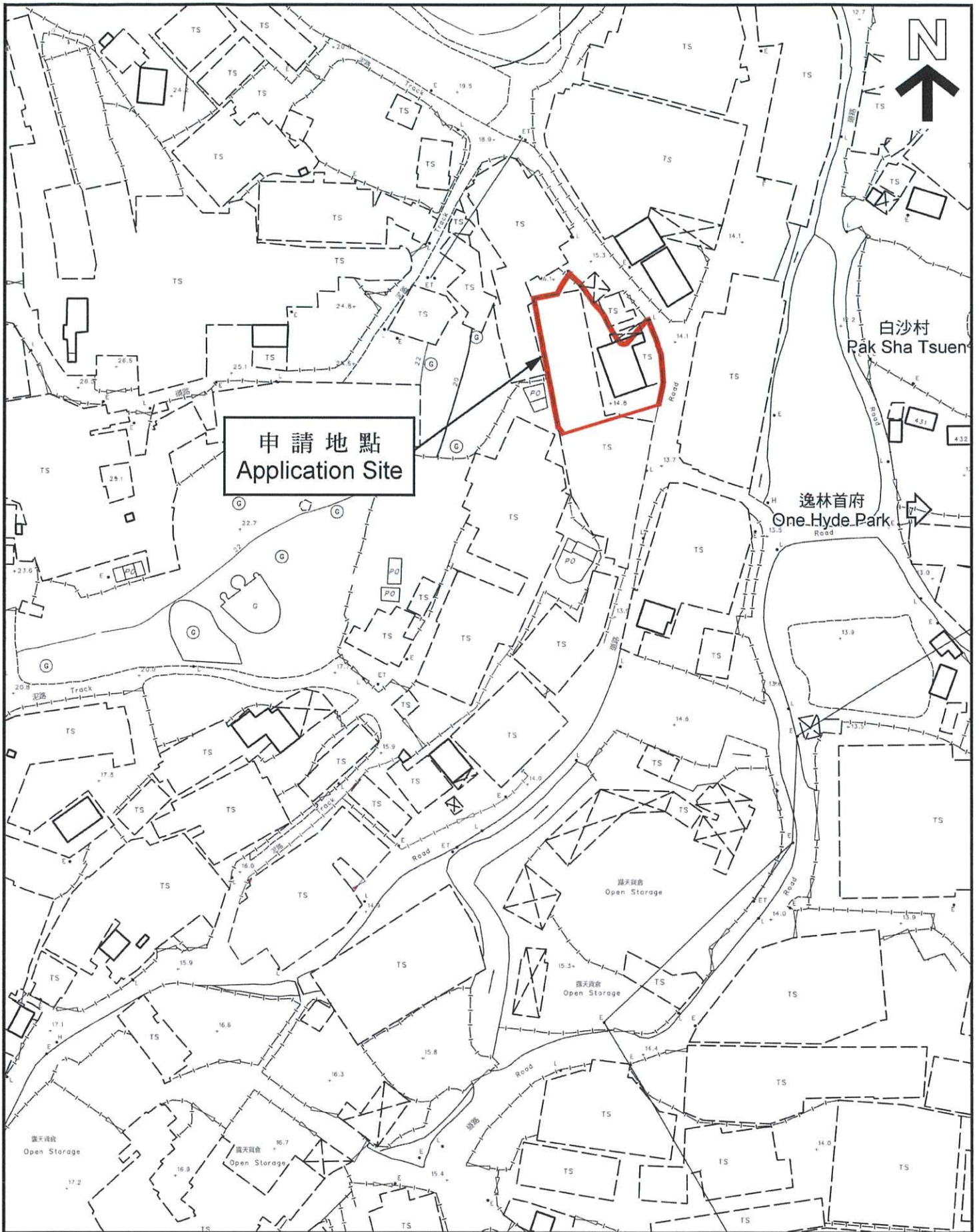

申請地點
Application Site

白沙村
Pak Sha Tsuen

逸林首府
One Hyde Park

平面圖 SITE PLAN

申請地點界線只作識別用
APPLICATION SITE BOUNDARY
FOR IDENTIFICATION PURPOSE ONLY

參考編號
REFERENCE No.

N



Structure 1
Warehouse for storage of office paper
GFA: About 220m²
Height: Not exceeding 8.5m
No. of Storey: 1

Structure 2
Warehouse for storage of
office paper and workshop for
shredding paper
GFA: About 220m²
Height: Not exceeding 8.5m
No. of Storey: 1

Structure 3
Toilet
GFA: About 40m²
Height: Not exceeding 3m
No. of storey: 1

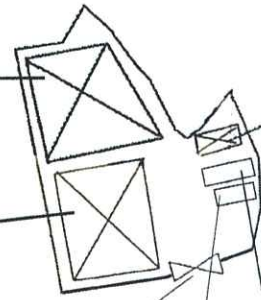

MGV Parking space (11m x 3.5m)

Ingress / Egress

LGV Parking space (7m x 3.5m)

Project 項目名稱:

Drawing Title 圖目:

Proposed Layout Plan

Remarks 備註:



Ingress/Egress

Drawing No. 圖號:

Scale 比例:

1:1000

Structure 1 and Structure 2 Layout Plan A-1



Structure 2
 Warehouse for storage of office paper and workshop for shredding paper
 GFA: About 220m²
 Height: Not exceeding 8.5m
 No. of Storey: 1

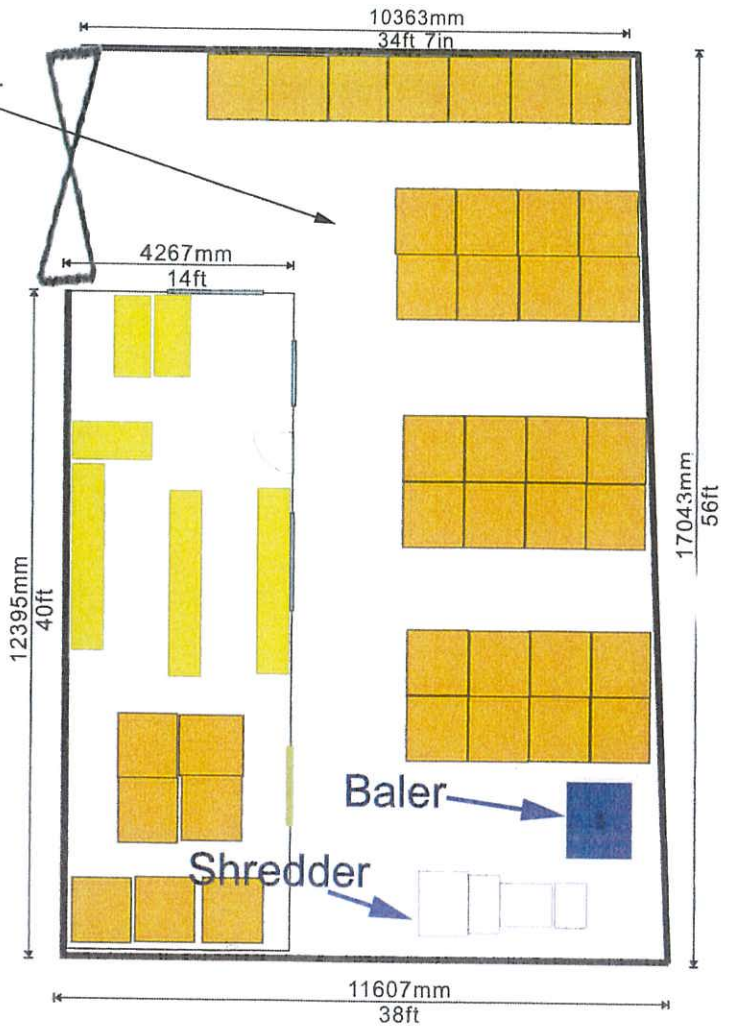

Structure 1
 Warehouse for storage of office paper
 GFA: About 220m²
 Height: Not exceeding 8.5m
 No. of Storey: 1

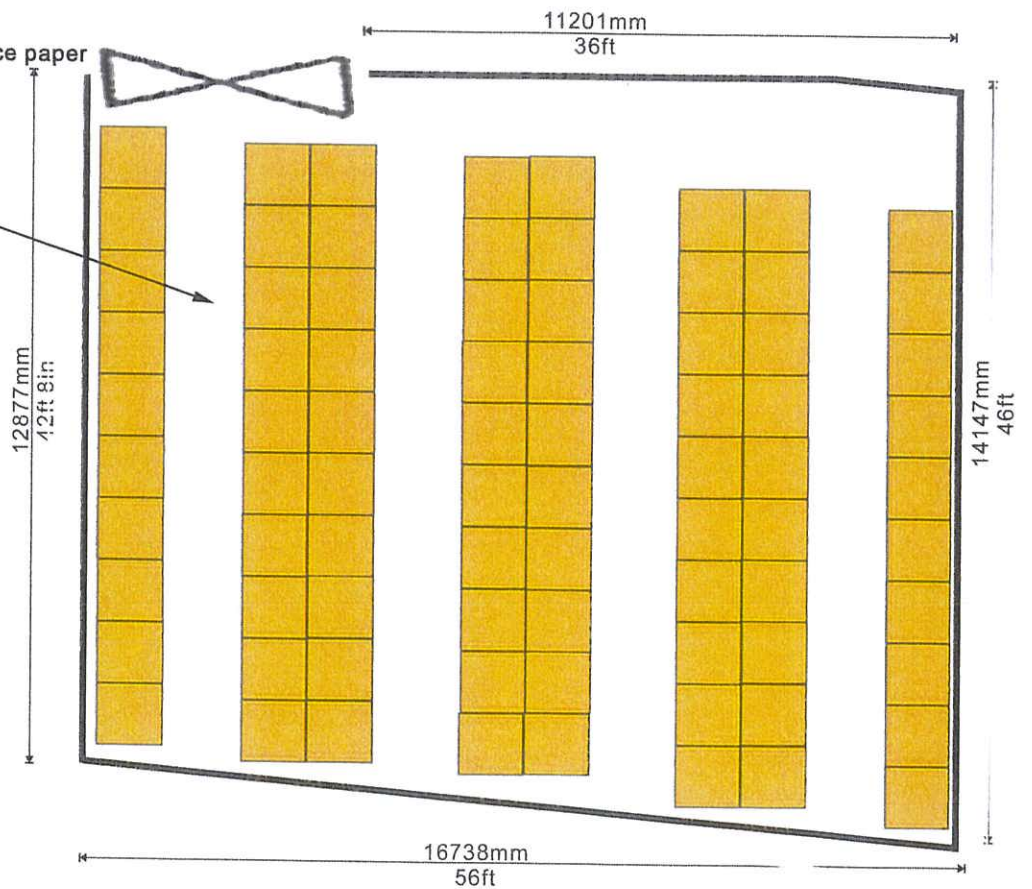

Structure 2



Layout Plan : A-2

