

# **Appendix I**

## **Figures**

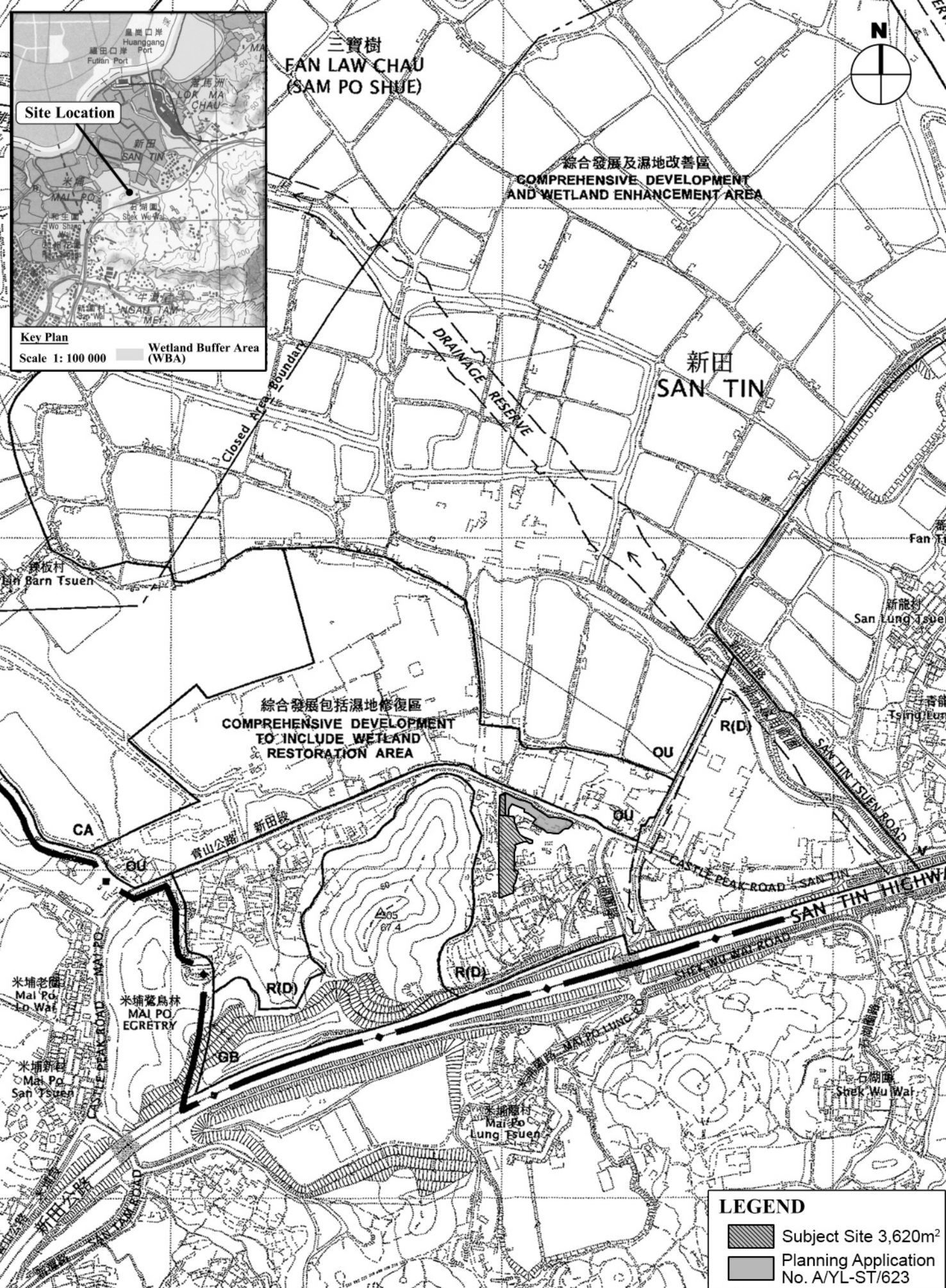

Location of Application Site

Figure 1

1 : 7 500



申請地點  
Application Site

米埔隴  
Mai Po Lung

新田公路

SAN TIN HIGHWAY

石湖圍路 SHEK MU MAI ROAD

MAI PO LUNG ROAD  
米埔隴路

Site Plan

Figure 2

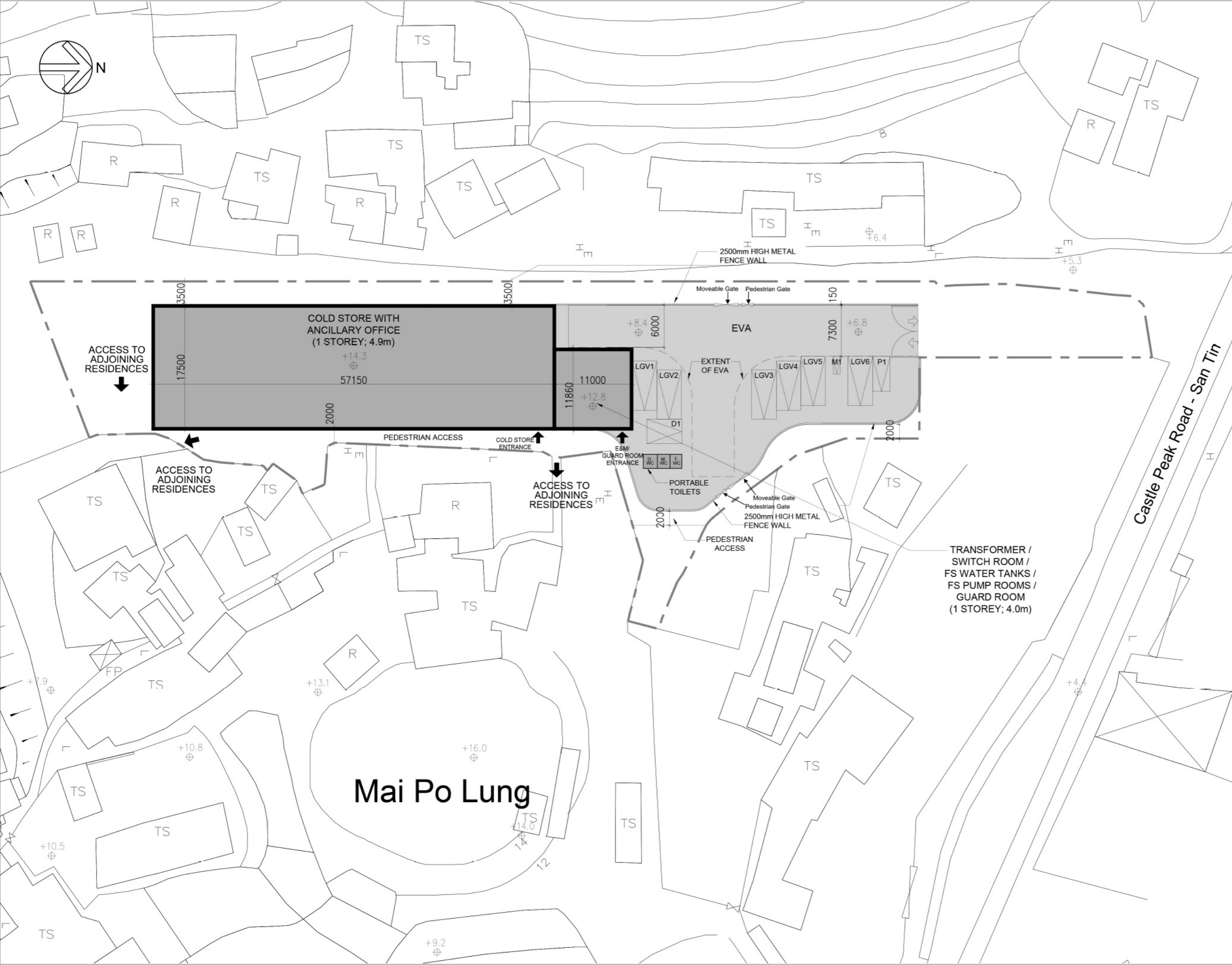

**NOTES :**  
 DO NOT SCALE DRAWINGS.  
 ALL DIMENSIONS MUST BE VERIFIED AT THE WORK BY THE CONTRACTOR.  
 ALL PRINTS, SPECIFICATIONS AND THEIR COPYRIGHT ARE THE PROPERTY OF THE ARCHITECTS AND SHALL BE RETURNED AT THE COMPLETION OF THE WORK.

**LEGENDS:**  
 [Symbol] Gate  
 - - - Subject Site Boundary

**Figure 3:**  
**Master Layout Plan**

REVISION		
NO.	DATE	DESCRIPTION

ARCHITECT  
**STUDIO | R&A**  
 18/F | Xiu Hua Commercial Building  
 211-213 Jaffe Road | Wan Chai | HK  
 Tel: 3583-2000 | Fax: 8143-1130  
 Email: mail@studiorca.com

STUDIO | RAYMOND CHAU |  
 ARCHITECTURE | LIMITED

PROJECT NAME  
 APPLICATION FOR A TEMPORARY COLD STORE FOR A PERIOD OF THREE YEARS IN "RESIDENTIAL (GROUP D)" ZONE AT VARIOUS LOTS IN D.D. 105 & ADJOINING GOVERNMENT LAND, SOUTH OF CASTLE PEAK ROAD - SAN TIN, MAI PO LUNG, SAN TIN, YUEN LONG, N.T.

DRAWING TITLE  
 MASTER LAYOUT PLAN

DRAWN BY MH	CHECKED BY RC
SCALE NTS	DATE 15.11.2017
JOB NO. 1714	DRAWING NO. A-001