

Our Ref : YL/TPN/734K/L03

5 April 2024

Secretary
Town Planning Board
15/F, North Point Government Offices
333 Java Road, North Point
Hong Kong

By Post and Email

Dear Sir/Madam,

**Planning Application for
A Proposed Temporary Public Vehicle Park (Private Cars and Container Vehicles),
Vehicle Repair Workshop, Open Storage of Construction Materials and Ancillary
Offices for a Period of 3 Years
Lots 826RP(Part), 827, 828, 829 in DD 102 and Lots 296, 297RP, 298RP, 299RP,
396RP(Part), 397(Part) in DD 105, and adjoining Government Land,
Ngau Tam Mei, Yuen Long, New Territories
(Planning Application No. A/YL-NTM/472)**

We refer to the captioned planning application.

We would like to provide herewith a set of "Response-to-Comments" for submission in support of the captioned planning application.

Should you have any queries, please feel free to call our Mr. Anson Lee at 2301-1869. Thank you.

Yours faithfully,
For and on behalf of
LANBASE SURVEYORS LIMITED



Anson Lee
Encl.
RK/AL

c.c.
DPO/FS&YLE (Attn.: Ms. Karen Chan By Email)



ISO 9001 : 2015
Certificate No.: CC 1687
(Valuation & Land Administration)



ISO 9001 : 2015
Certificate No.: CC 1687
(Valuation & Land Administration)

Response-to-Comments

	Departmental Comments	Responses
	<u>Urban Design and Landscape Unit, Planning Department (UD&L, PlanD)</u>	
(1)	The applicant should provide information on the existing trees within the Site (including tree location plan, tree schedule and date-imprinted tree photos) and the remove debris/stockpiles away from the tree planting areas to ensure healthy tree growth	<p>Please note that there are existing landscape and tree plantings on the site and a Landscape and Tree Preservation Proposal was approved under previous Planning Application No. A/YL-NTM/358, as shown in the Appendix 8 of the Planning Statement (Please also see the attached).</p> <p>Please also note that the current planning application is a renewal planning application, which is identical to previous Planning Application Nos. A/YL-NTM/358 and A/YL-NTM/416, and the site condition and existing landscape and tree plantings on the site remain unchanged.</p> <p>As mentioned in the planning statement, the existing plantings are also properly maintained. Should there be any reinforcement/maintenance works, the Applicant is willing to plant further trees to your satisfaction.</p>

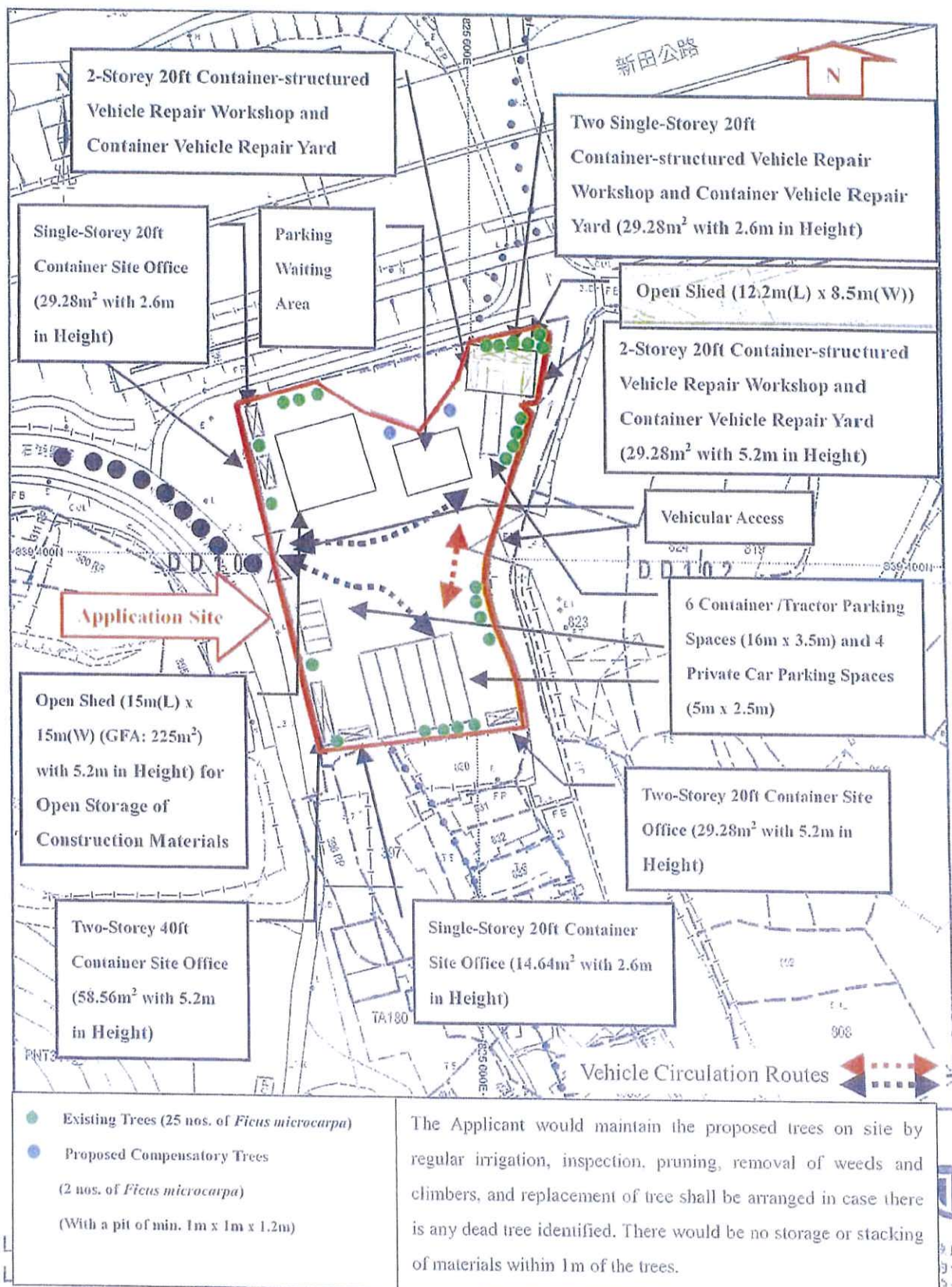

District Survey Office : Kowloon

Date : 23-Nov-2012

Reference No. : 2-8E-13A

地政專員啟者，本圖則所示的資料必須透過地政專員辦事處查詢，當有更新的地界線時，地政專員圖可能會被修訂而無須事先通知。

This plan is a copy of the lot index plan showing the approximate location of boundaries, including the temporary occupation of land under Government Land Allocations, Temporary Government Land Allocations, Short Term Tenancies or Government Land Licences. The temporary occupation of land may be created

For Identification Only