

TYPICAL CABLE TRENCH FOR SINGLE LV CABLE

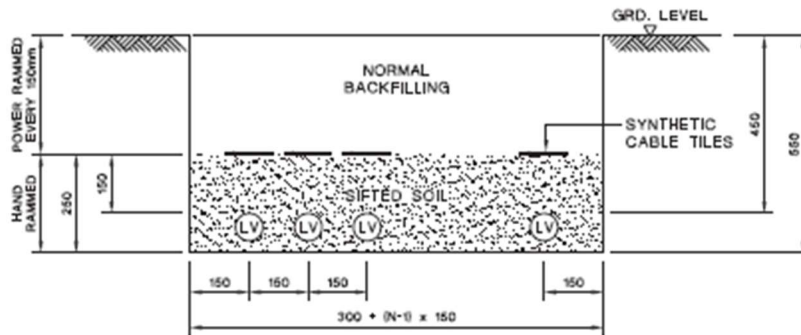

TYPICAL CABLE TRENCH FOR MULTIPLE LV CABLES

LEGEND :

- (LV) LV CABLE
- N NUMBER OF CABLE CIRCUITS

NOTES:

1. ALL SOIL BACKFILLING BENEATH CABLE TILES SHALL BE SIFTED THROUGH 12mm WIRE MESH.
2. ALL DIMENSIONS ARE IN mm.

CLP 中電		REVISIONS		SYNTHETIC CABLE TILE SPECIFIED	
DRAWN: S.C.T.	DATE: 15 Aug, 2003	REV. 15-2-04	19-4-07	28-6-07	
CHECKED: K. K. LEUNG	APPROVED: W. B. LEE	A	B	C	D
SCALE: 1 : 15	SHEET(S) IN SET: 1	INITIAL C.Y.P.	W.B.LEE	YX.MAN	
ASSET MANAGEMENT		TITLE : TYPICAL LV CABLE TRENCH			
DRG. NO. TGEN25500D		CONTRACT NO. E33000201CA			

ALL RIGHTS RESERVED AND REPRODUCTION IN ANY FORM MUST BE APPROVED BY CLP POWER

Typical LV Cable Trench

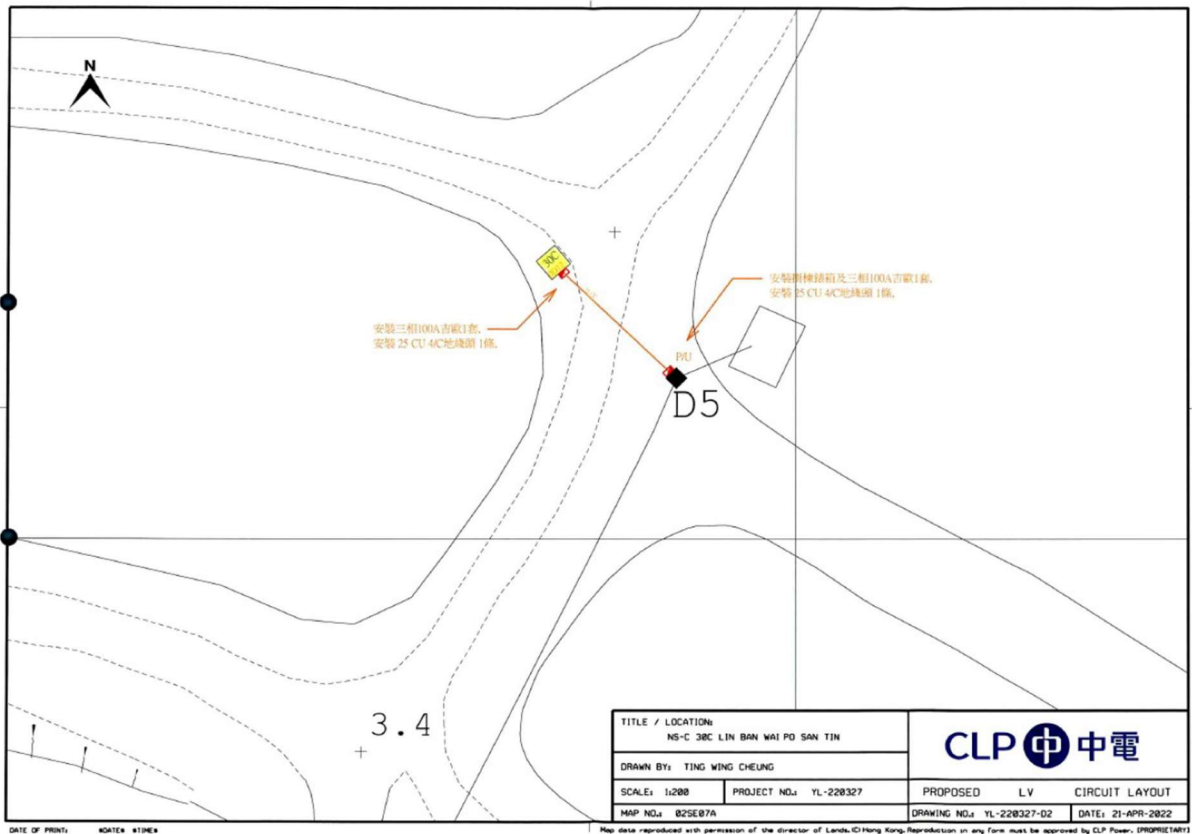

Layout Plan

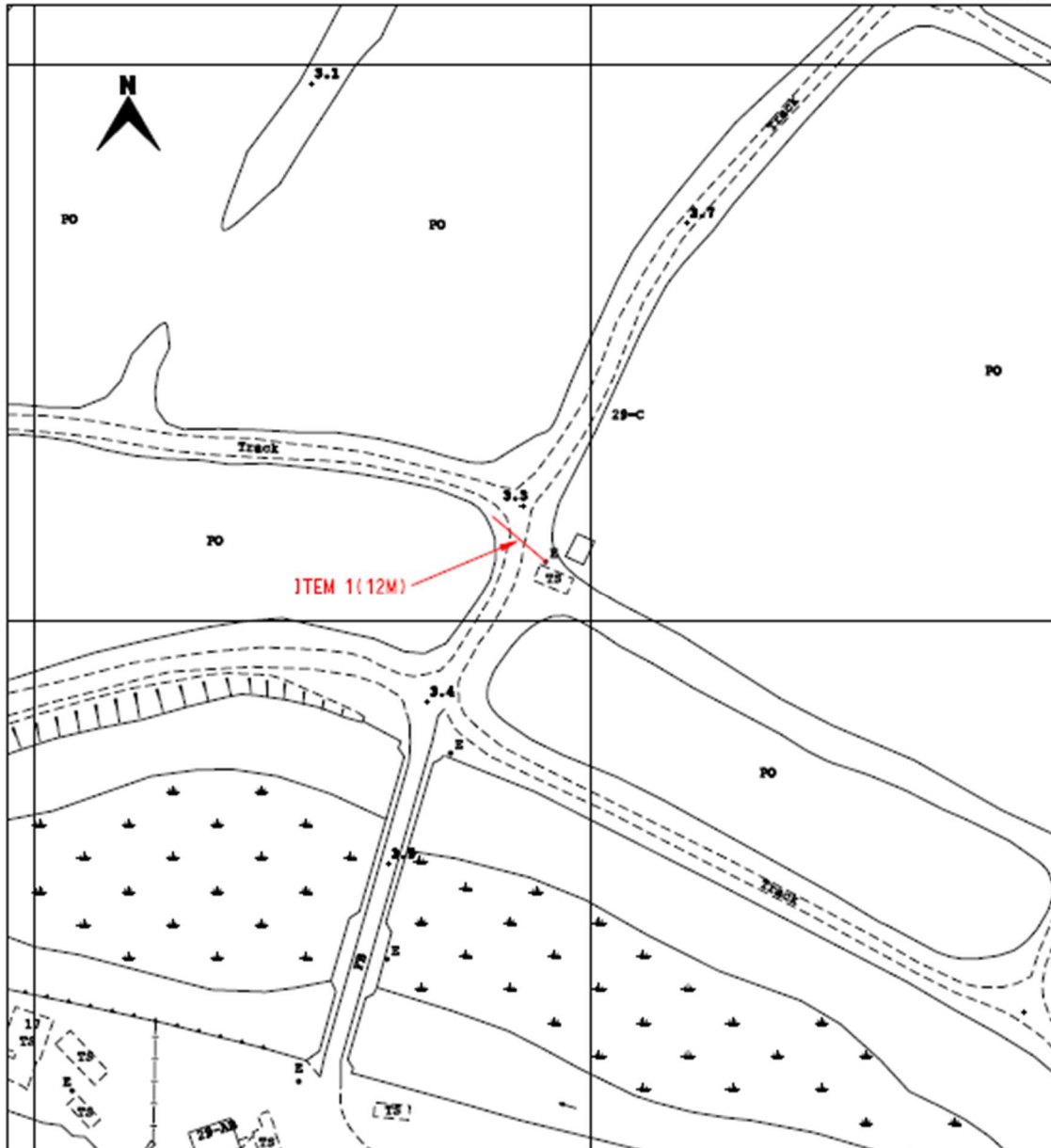

TITLE : LV Cable Laying
Near Po San Tin

LEGEND

- PROPOSED TRENCH FOR LAYING / RECOVERING CABLE
- PROPOSED TRENCH FOR LAYING DUCTS
- PROPOSED CABLE THROUGH EXISTING DUCTS
- EXISTING PILLAR
- PROPOSED PILLAR 1.6M x 0.5M x 0.75M / CUTOUT BOX
- EXCAVATION FOR JOINTING / REPAIRING / INSPECTION CABLE
- EXISTING OVERHEAD LINE & POLE
- PROPOSED 11kV, LV, OHL, OF STEEL / WOODEN POLE
- OVERHEAD LINE & POLE TO BE REMOVED
- PROPOSED TREE TRIMMING / CUTTING
- EXISTING POLE MOUNTED TRANSFORMER
- PROPOSED POLE MOUNTED TRANSFORMER
- PROPOSED STAY / STAY POLE
- PROPOSED 5.0(M) x 2.39(M) x 3.0(M) PACKAGE SUBSTATION

MAP NO : 02SE07A, 02SE02C

DRAWN : BENSON		E/O NO :	
CHECKED : Y.F.YIK		REGION : NR	O.C. : YL
DATE : 05-07-2022		PROJECT REF. : YL2022-0327	
SCALE : 1:1000		PLAN REF. : NRYL2022-0327-01	

Map data reproduced with permission of the Director of Lands, G2 Hong Kong

Location Plan(DLO Permit)

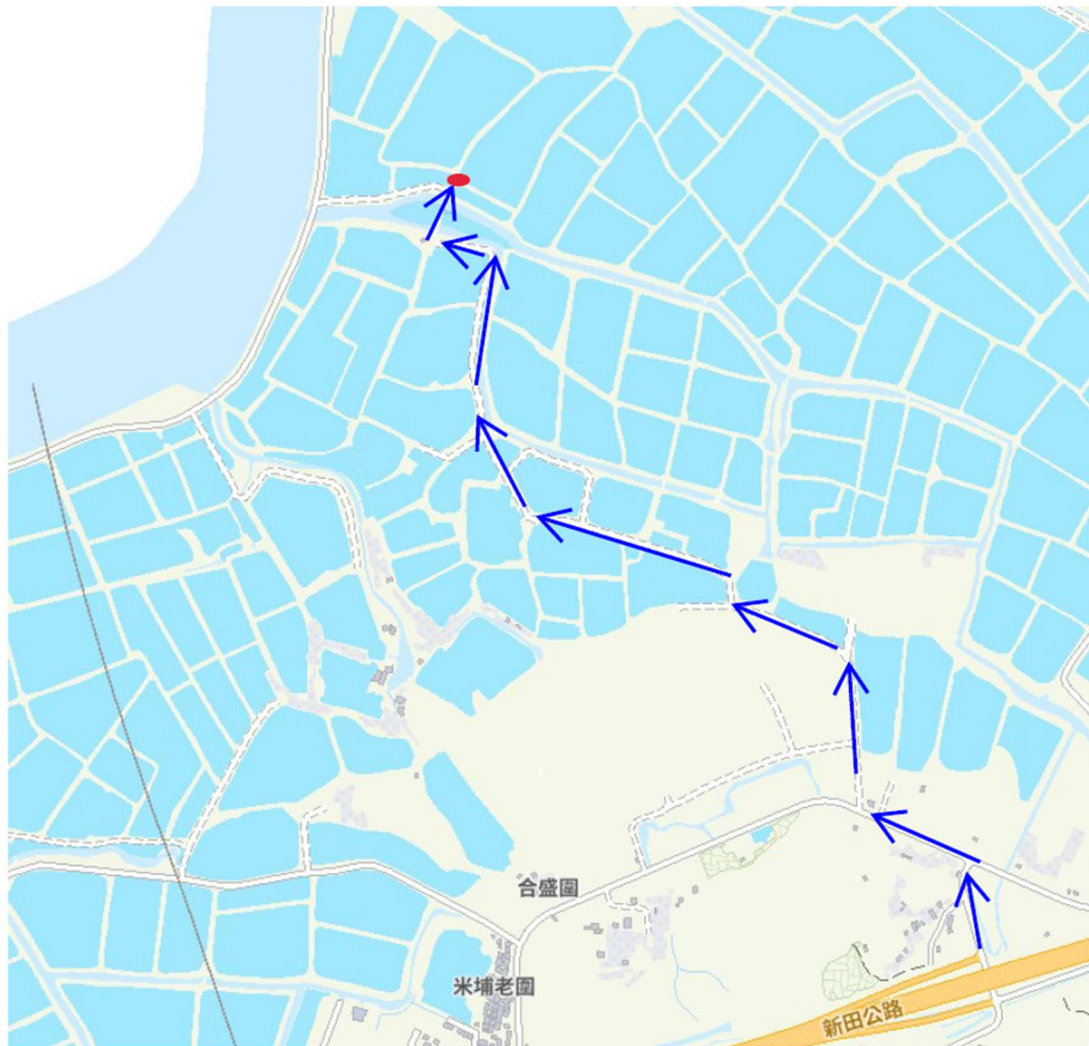

Vehicle Access Plan

- The red point is the location of site
- The blue arrow symbols are Vehicular Access Route