

TYPICAL CABLE TRENCH FOR SINGLE LV CABLE

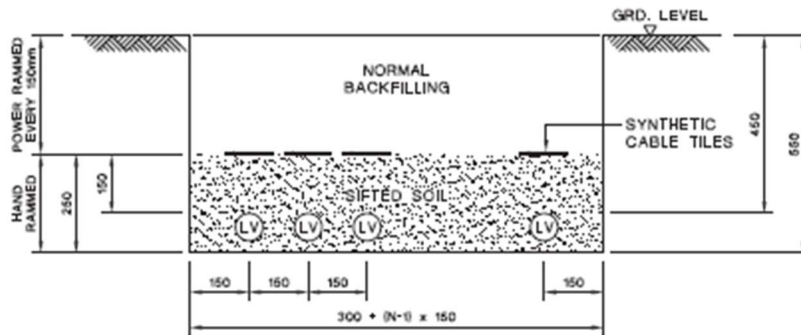

TYPICAL CABLE TRENCH FOR MULTIPLE LV CABLES

LEGEND :

- (LV) LV CABLE
- N NUMBER OF CABLE CIRCUITS

NOTES:

1. ALL SOIL BACKFILLING BENEATH CABLE TILES SHALL BE SIFTED THROUGH 12mm WIRE MESH.
2. ALL DIMENSIONS ARE IN mm.

CLP 中電		REVISIONS		TITLE :													
DRAWN: S.C.T. DATE: 15 Aug, 2003		CHECKED: K. K. LEUNG APPROVED: W. B. LEE		SCALE: 1 : 15 SHEET(S) IN SET: 1		PROJECT NO.		CONTRACT NO.									
ASSET MANAGEMENT		DRG. NO. T G E N 2 5 5 0 0 D E 3 3 0 0 0 2 0 1 C A		TYPICAL LV CABLE TRENCH													

ALL RIGHTS RESERVED AND REPRODUCTION IN ANY FORM MUST BE APPROVED BY CLP POWER

Typical LV Cable Trench

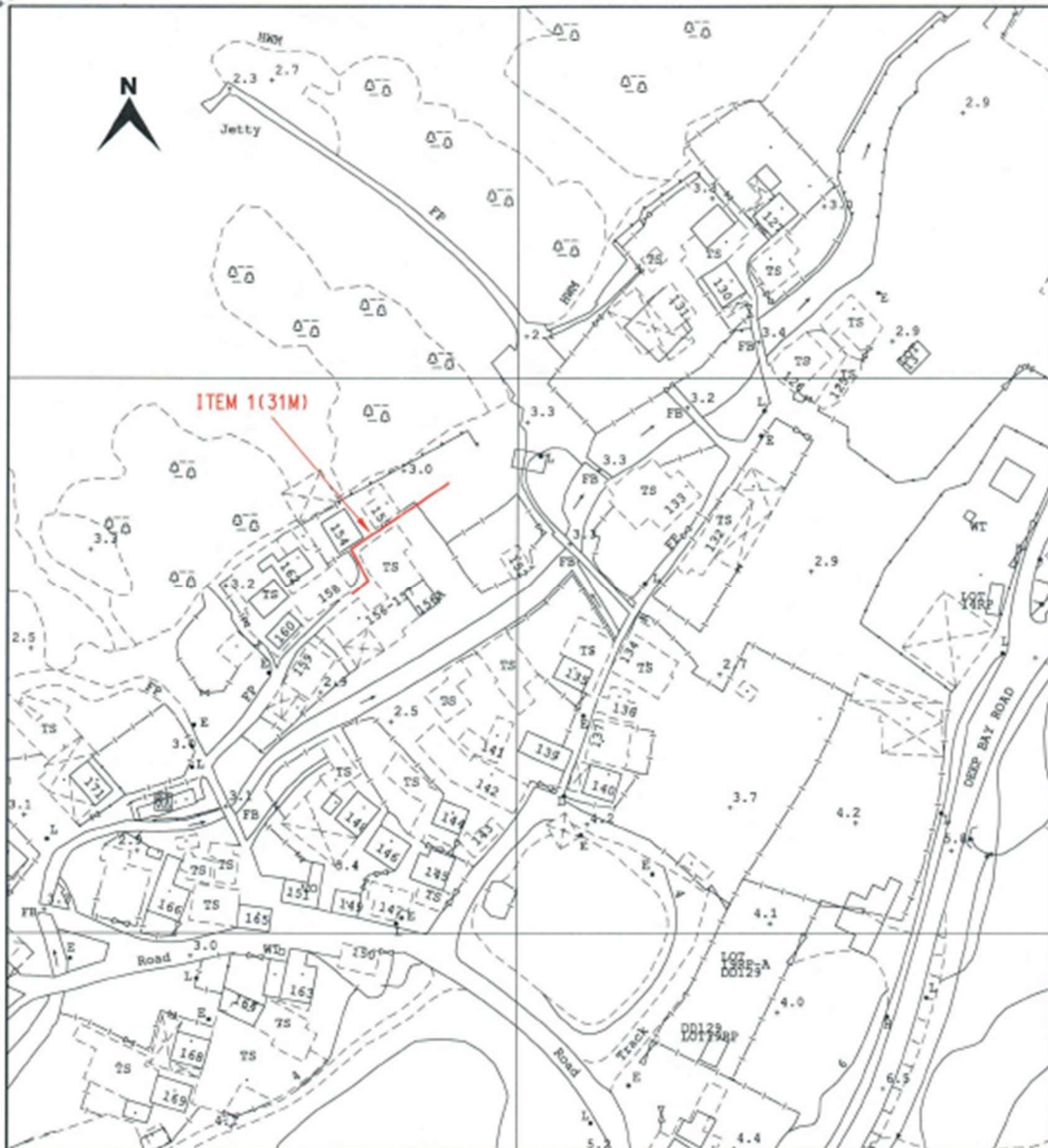

TITLE : LV Cable Laying
Near Sha Kiu Tsuen

- LEGEND**
- PROPOSED TRENCH FOR LAYING / RECOVERING CABLE
 - PROPOSED TRENCH FOR LAYING DUCTS
 - PROPOSED CABLE THROUGH EXISTING DUCTS
 - EXISTING PILLAR
 - PROPOSED PILLAR 1.6M x 0.6M x 0.75M / CUTOUT BOX
 - EXCAVATION FOR JOINTING / REPAIRING / INSPECTION CABLE
 - EXISTING OVERHEAD LINE & POLE
 - PROPOSED 11kV, LV, OHL OF STEEL / WOODEN POLE
 - OVERHEAD LINE & POLE TO BE REMOVED
 - PROPOSED TREE TRIMMING / CUTTING
 - EXISTING POLE MOUNTED TRANSFORMER
 - PROPOSED POLE MOUNTED TRANSFORMER
 - PROPOSED STAY / STAY POLE
 - PROPOSED 5.0M(L) x 2.39M(W) x 3.0M(H) PACKAGE SUBSTATION

MAP NO : 02SW12D

DRAWN : BENSON		E/O NO :	
CHECKED : Alex KO		REGION :NR	O.C. : YL
DATE : 26-08-2021		PROJECT REF. : TM2021-0450	
SCALE : 1:1000		PLAN REF. : NRTM2021-0450-01	

Map data reproduced with permission of the Director of Lands, GCI Hong Kong

Location Plan(DLO Permit)