

PROPOSED BUILDING LICENCE LOT NO. 1228 S.B IN D.D.100

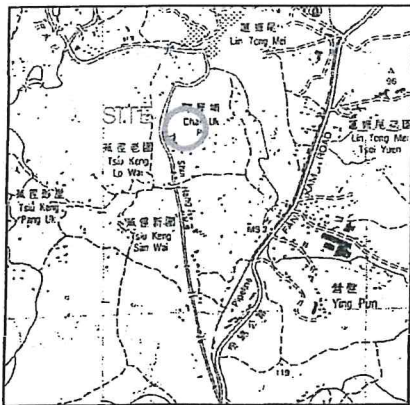

LOCATION PLAN



COLOURED PINK AREA : 65.03 SQUARE METRES (ABOUT)

Line	Bearing	Distance(m)	Northing(m)	Easting(m)	Pt.
A-B	63° 55' 16"	10.160	837704.020	829131.097	A
B-C	153° 55' 16"	6.401	837708.486	829140.223	B
C-D	243° 55' 16"	10.160	837702.737	829143.037	C
D-A	333° 55' 16"	6.401	837698.271	829133.911	D

Dated this 25th day of September 2017.

Legends:

- Septic Tank (4' x 12')
- Balcony (10.160m x 1.220m)

Scale 1:1000

Survey Sheet No.: 2-SE-20C

Date: September 2017

Plan No. : GL0705/SH/03(R1)

LEUNG Chi-yan, George
MIS.Aust MNZIS MHKIS MRICS RPS(LS) ACIArb
Authorized Land Surveyor

Gland GLand Surveying, Planning & GIS Co. Ltd.
創領測量規劃及地理訊息系統有限公司

1611 Workingbond Commercial Centre, No.162 Prince Edward Road West, Kowloon, Hong Kong
Telephone : 2544 8939 Facsimile : 2544 1669 E-mail : gland@biznetvigator.com

The Site

Notes:
SUBJECT LOT CO-ORDINATES & DIMENSIONS:
Boundary Point
LOT 1228 S.A. IN D.D.100

Point	Bearing	Distance	N	E
AH	50° 07' 10"	19.014	837710.767	829141.485
AJ	164° 55' 02"	1.447	837722.958	829136.076
AK	137° 23' 36"	2.291	837721.361	829156.453
AL	129° 25' 33"	1.551	837719.313	829157.480
AM	112° 41' 02"	1.163	837718.372	829158.530
AN	218° 53' 32"	1.231	837717.633	829159.429
AO	222° 39' 20"	2.941	837715.181	829160.564
AP	228° 57' 37"	1.807	837706.498	829158.969
AQ	328° 29' 23"	5.160	837703.110	829150.969
AR		0.766	837702.684	829147.077
AS		9.481	837710.767	829146.440
AT				829141.485

LOT 1228 S.B. IN D.D.100

A	65° 55' 56"	3.264	837705.008	829127.492
B	152° 20' 47"	8.188	837710.022	829130.472
C	63° 15' 59"	1.000	837709.136	829137.784
D	148° 29' 23"	3.624	837710.767	829138.249
E	236° 12' 02"	9.481	837708.684	829141.485
F	242° 54' 35"	4.316	837700.283	829142.854
G	250° 00' 15"	3.123	837698.851	829140.074
H	256° 41' 13"	3.709	837687.555	829136.485
I	333° 15' 45"	1.338	837686.701	829132.876
J	323° 08' 02"	3.014	837700.307	829132.274
K	307° 53' 13"	2.513	837701.650	829128.483
L	295° 36' 18"	0.801	837702.196	829127.761
M	2° 33' 26"	0.516	837702.711	829127.784
N	352° 45' 19"	2.313	837705.008	829127.492

Table of Subdivisions

SECTION	AREA
LOT 1228 S.A (Coloured Yellow)	165.0 m ² (About)
LOT 1228 S.B (Coloured Green)	157.9 m ² (About)
LOT 1228 S.C (Coloured Pink)	65.9 m ² (About)
LOT 1228 R.P (Coloured Indigo)	31.3 m ² (About)
Total Area	420.1 m ² (About)

I, LEUNG Chi-wan, George, an Authorized Land Surveyor registered under the Land Survey Ordinance (Cap. 473), hereby certify that this land boundary plan has been prepared from land boundary surveys that were carried out by me, or under my direct supervision in conformity with the Code of Practice approved by the Land Survey Authority under the above Ordinance, and that this plan correctly represents that survey completed on the 28th day of June, 2012.

Dated this 08th day of August, 2012.

LEUNG Chi-wan, George
MIS/AUST INTSIS INTSIS/RICS RPS(S) ADP/ab
Authorized Land Surveyor

Gland 創領測量規劃及地理訊息系統有限公司
Gland Surveying, Planning & GIS Co. Ltd.

FOR OFFICIAL USE

Land Boundary Plan No. : LBP/DN/054/0238/D1

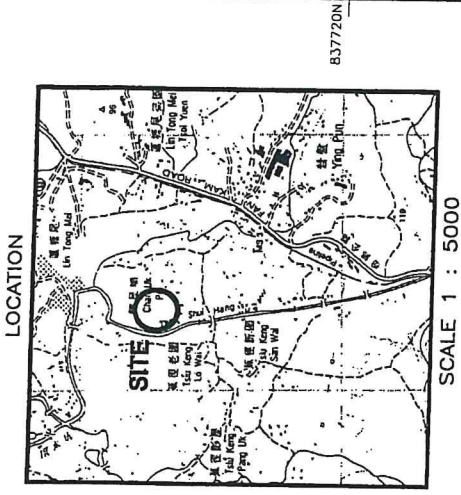

SUBJECT LOT CO-ORDINATES & DIMENSIONS:
Boundary Point
LOT 1228 S.C. IN D.D.100

Point	Bearing	Distance	N	E
B	50° 03' 51"	3.549	837706.339	829130.472
C	36° 26' 59"	0.045	837708.617	829133.193
D	42° 55' 46"	4.693	837710.266	829134.408
E	58° 01' 59"	3.118	837713.698	829137.604
F	56° 37' 41"	13.183	837716.358	829141.849
G	60° 26' 46"	2.659	837723.421	829153.105
H	111° 51' 06"	0.649	837724.831	829153.592
I	230° 07' 08"	20.129	837724.515	829156.380
J	243° 15' 59"	11.713	837706.339	829140.933
K				829130.472

LOT 1228 R.P. IN D.D.100

Point	Bearing	Distance	N	E
AE	63° 15' 59"	3.526	837710.022	829137.784
AF	30° 07' 08"	20.129	837711.608	829140.933
AG	144° 40' 07"	0.872	837724.515	829156.380
AH	164° 55' 02"	1.952	837721.919	829157.392
AI	153° 21' 36"	2.050	837720.087	829158.311
AJ	137° 23' 12"	1.341	837719.100	829159.219
AK	129° 25' 33"	0.946	837718.499	829159.950
AL	112° 41' 02"	1.374	837717.969	829161.218
AM	292° 41' 02"	1.041	837717.158	829160.564
AN	309° 25' 33"	1.231	837717.633	829159.429
AO	317° 23' 12"	1.163	837718.372	829158.530
AP	333° 21' 36"	1.551	837719.513	829157.480
AQ	344° 55' 02"	2.291	837722.958	829156.453
AR	230° 07' 10"	1.447	837722.958	829156.076
AS	243° 15' 59"	19.014	837710.767	829141.485
AT	332° 20' 47"	3.624	837709.136	829138.249
AU		1.000	837710.022	829137.784

The Site

Ref	Colour
B	BROWN
C	GREEN
D	INDIGO
E	ORANGE
F	PINK
G	RED
H	VIOLET
I	YELLOW
J	GREY

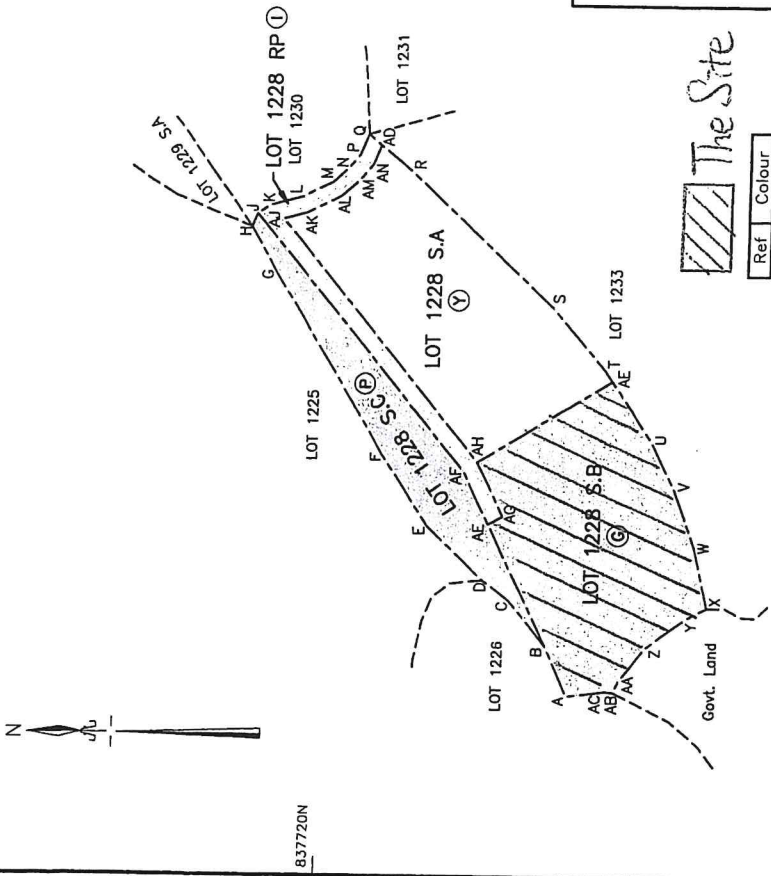
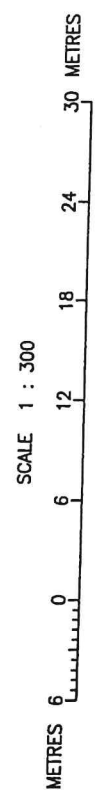

PLAN OF LOT Nos. 1228 S.A, S.B, S.C & RP IN D.D.100
BEING SUBDIVISION OF LOT No. 1228 IN D.D.100

Survey District : North
Date of Survey : June 2012
Survey Sheet No. : 2-SE-20C
Survey Record Plan No.: SRP/DN/054/0238/D1



GB

華

V

Statutory Planning Portal 2

Statutory Planning Portal 2

Statutory Planning Portal 2

Statutory Planning Portal 2

Statutory Planning Portal 2

The Site ★

Statutory Planning Portal 2

V

AGR

陳屋埔

Statutory Planning Portal 2

Statutory Planning Portal 2

蕉徑路

Statutory Planning Portal 2

Statutory Planning Portal 2

蕉徑老圍

0 10 20 40 60 80 100

METERS 米

由規劃署法定規劃綜合網站 2 提供

© 規劃資料由城市規劃委員會提供，數碼地形圖由地政總署提供