

**Environmental Impact Assessment Ordinance (Cap. 499), Section 5(7)  
Environmental Impact Assessment Study Brief No. ESB-218/2010**

**Project Title: Modification of Hing Wah Street Between Lai Chi Kok Road and  
Cheung Sha Wan Road for Two-Way Traffic  
(hereinafter known as the “Project”)**

**Name of Applicant: Highways Department of the Hong Kong SAR Government  
(hereinafter known as the “Applicant”)**

**1. BACKGROUND**

- 1.1 An application (No. ESB-218/2010) for an Environmental Impact Assessment (EIA) study brief under section 5(1) of the Environmental Impact Assessment Ordinance (EIAO) was submitted by the captioned Applicant on 3 November 2010 with a project profile No. PP-426/2010 (hereafter known as the “Project Profile”).
- 1.2 The Project at the location as shown in Appendix A of this study brief mainly involves:
- (a) Road modification along Hing Wah Street between Lai Chi Kok Road and Hang Cheung Street to a single 5-lane 2-way carriageway (i.e. 2-lane northbound and 3-lane southbound). The road length involved is about 195m long.
  - (b) Road modification along Hing Wah Street between Hang Cheung Street and Cheung Sha Wan Road to a single 6-lane 2-way carriageway (i.e. 3-lane northbound and 3-lane southbound). The road length involved is about 75m long.
  - (c) Associated junction modification works at Lai Chi Kok Road, Cheung Sha Wan Road and other connected local roads.
  - (d) Associated road drainage works, traffic aids and street lighting modification works and environmental mitigation measures if required.
- 1.3 The Project is a designated project under Item A.1 of Part 1 Schedule 2 of the EIAO: “A.1, A road which is an expressway, trunk road, primary distributor road or district distributor road including new roads, and major extensions or improvements to existing roads”.
- 1.4 Pursuant to section 5(7)(a) of the EIAO, the Director of Environmental Protection (the Director) issues this Environmental Impact Assessment (EIA) study brief to the Applicant to carry out an EIA study.
- 1.5 The purpose of this EIA study is to provide information on the nature and extent of environmental impacts arising from the construction and operation of the Project and related activities taking place concurrently. This information will contribute to decisions by the Director on:

- (i) the overall acceptability of any adverse environmental consequences that are likely to arise as a result of the proposed project;
- (ii) the conditions and requirements for the detailed design, construction and operation of the proposed project to mitigate against adverse environmental consequences wherever practicable; and
- (iii) the acceptability of residual impacts after the proposed mitigation measures are implemented.

## **2. OBJECTIVES OF THE EIA STUDY**

2.1 The objectives of the EIA study are as follows:

- (i) to describe the Project and associated works together with the requirements for carrying out the Project;
- (ii) to identify and describe elements of community and environment likely to be affected by the Project and/or likely to cause adverse impacts to the Project, including natural and man-made environment and the associated environmental constraints;
- (iii) to provide information on the consideration of alternatives to avoid and minimize potential environmental impacts to sensitive uses;
- (iv) to identify and quantify emission sources and determine the significance of impacts on sensitive receivers and potential affected uses;
- (v) to identify and systematically evaluate any potential landscape and visual impacts and to propose measures to mitigate these impacts;
- (vi) to propose the provision of mitigation measures so as to minimize pollution, environmental disturbance and nuisance during construction and operation of the Project;
- (vii) to investigate the feasibility, practicability, effectiveness and implications of the proposed mitigation measures;
- (viii) to identify, predict and evaluate the residual environmental impacts (i.e. after practicable mitigation) and the cumulative effects expected to arise during the construction and operation phases of the Project in relation to the sensitive receivers and potential affected uses;
- (ix) to investigate the extent of the secondary environmental impacts that may arise from the proposed mitigation measures and to identify constraints associated with the mitigation measures recommended in the EIA study, as well as the provision of any necessary modification; and
- (x) to determine the need and specify environmental monitoring and audit requirements to ensure the effective implementation of the recommended environmental protection and pollution control measures.

### **3. DETAILED REQUIREMENTS OF THE EIA STUDY**

#### **3.1 The Purpose**

The purpose of this study brief is to scope the key issues of the EIA study and to specify the environmental issues that are required to be reviewed and assessed in the EIA report. The Applicant has to demonstrate in the EIA report that the criteria in the relevant sections of the Technical Memorandum on the Environmental Impact Assessment Process of the Environmental Impact Assessment Ordinance (hereinafter referred to as “the TM”), are complied with.

#### **3.2 The Scope**

The scope of this EIA study shall cover the Project proposed in the Project Profile and the works mentioned in Section 1.2 above. The EIA study shall cover the cumulative impacts of any adjacent projects. The EIA study shall address the key issues described below, together with any other key issues identified during the course of the EIA study and the cumulative environmental impacts of the Project.

- (i) potential noise impacts on sensitive receivers from the construction and operation of the Project;
- (ii) potential air quality impacts on sensitive receivers from the construction and operation of the Project;
- (iii) potential water quality impact on the relevant water system(s) from the construction of the Project;
- (iv) waste arising from the construction activities of the Project;
- (v) potential landscape & visual impacts from the construction and operation of the project.

#### **3.3 Consideration of Alternatives**

##### **3.3.1 The Need of the Project**

The Applicant shall study and review the need of the Project and provide information to justify the need. The Applicant shall explain clearly the purpose and objectives of the Project and describe the scenarios with and without the Project.

##### **3.3.2 Consideration of Alternative Options**

In addition to the proposed modification scheme, the Applicant shall consider other feasible alternatives for the Project, provide justification regarding how the proposed scheme is arrived at, including the descriptions of the environmental factors considered in the option selection.

## Technical Requirements

- 3.4 The Applicant shall conduct the EIA study to address all environmental aspects of the activities as described in Sections 3.2 and 3.3 above. The assessment shall be based on the best and latest information available during the course of the EIA study. The Applicant shall include in the EIA report details of the construction and operational programme and the methodologies for the Project. The Applicant shall clearly state in the EIA report the time frame and works programmes of the Project and other concurrent projects, and assess the cumulative environmental impacts from the Project and the interacting projects as identified in the EIA study.
- 3.5 The Applicant shall review previous studies or EIA reports which are relevant to the Project.
- 3.6 The EIA study shall meet the following technical requirements on specific impacts:

### 3.6.1 Noise Impact

3.6.1.1 The Applicant shall follow the criteria and guidelines for evaluating and assessing noise impact as stated in Annexes 5 and 13 of the TM, respectively.

3.6.1.2 The noise impact assessment shall include the following:

(i) Determination of Assessment Area

The study area for the noise impact assessment shall generally include all areas within 300m from the Project shown in Appendix A or other Project alignments as identified in the EIA. Subject to the agreement of the Director, the assessment area could be reduced accordingly if the first layer of noise sensitive receivers (NSRs), closer than 300m from the outer Project limit, provides acoustic shielding to those receivers at distances further away from the Project. Subject to the agreement of the Director, the assessment area shall be expanded to include NSRs at distances over 300m from the Project, which are affected by the construction and operation of the Project.

(ii) Provision of Background Information and Existing Noise Levels

The Applicant shall provide all background information relevant to the Project, e.g. relevant previous or current studies. Unless required for determining the planning standards, e.g. those for planning of fixed noise sources (such as ventilation systems of traffic noise enclosures), no existing noise levels are particularly required.

(iii) Identification of Noise Sensitive Receivers

- (a) The Applicant shall refer to Annex 13 of the TM when identifying

the NSRs. The NSRs shall include all existing NSRs and all planned/ committed noise sensitive developments and uses, including at least the residential developments at Hang Chun Court and Un Chau Estate, the site zoned “Residential” in the Cheung Sha Wan Outline Zoning Plan at the south of the junction of Hing Wah Street and Lai Chi Kok Road, and the Hong Kong Institute of Vocational Education (Haking Wong). Photographs of all existing NSRs shall be appended to the EIA report.

- (b) The Applicant shall select assessment points to represent all identified NSRs for carrying out quantitative noise assessment described below. The assessment points shall be agreed with the Director prior to the quantitative noise assessment and may be varied subject to the best and latest information available during the course of the EIA study. A map showing the location and description such as name of building, use, and floor of each and every selected assessment point shall be given. For planned noise sensitive land uses without committed site layouts, the Applicant can use the relevant planning parameters to work out representative site layouts for operational noise assessment purpose. However, such assumption together with any site specific constraints identified, such as setback of building, building orientation and extended podium, shall be considered practicable, feasible and agreeable for implementation by relevant parties including the Planning Department and Lands Department as per section 6.3, Annex 13 of EIAO-TM.

(iv) Provision of an Emission Inventory of the Noise Sources

The Applicant shall provide an inventory of noise sources including representative construction equipment for construction noise assessment, and traffic flow/ fixed plant equipment (e.g. ventilation systems of traffic noise enclosures), as appropriate, for operational noise assessment. Confirmation of the validity of the inventory shall be obtained from the relevant government departments/authorities and documented in the EIA report.

(v) Construction Noise Assessment

(a) The assessment shall cover the cumulative noise impacts due to the construction works of the Project and other concurrent projects identified during the course of the EIA study.

(b) The Applicant shall carry out assessment of noise impact from construction (excluding percussive piling) of the Project during daytime, i.e. 7 a.m. to 7 p.m., on weekdays other than general holidays in accordance with the methodology in paragraphs 5.3. and 5.4 of Annex 13 of the TM. The criteria in Table 1B of Annex 5 of the TM shall be adopted in the assessment.

(c) If the unmitigated construction noise levels are found exceeding the relevant criteria, the Applicant shall propose practicable direct mitigation measures (including movable barriers, enclosures, quieter alternative methods, re-scheduling and restricting hours of operation of noisy tasks) to minimize the

impact. If the mitigated noise levels still exceed the relevant criteria, the duration of the noise exceedance shall be given.

(d) The Applicant shall, as far as practicable, formulate a reasonable construction programme so that no work will be required in restricted hours as defined under the Noise Control Ordinance (NCO). In case the Applicant needs to evaluate whether construction works in restricted hours as defined under the NCO are feasible or not in the context of programming construction works, reference shall be made to relevant technical memoranda issued under the NCO. Regardless of the results of construction noise impact assessment for restricted hours, the Noise Control Authority will process Construction Noise Permit (CNP) application, if necessary, based on the NCO, the relevant technical memoranda issued under the NCO, and the contemporary conditions/situations. This aspect shall be explicitly stated in the noise chapter and the conclusions and recommendations chapter in EIA report.

(vi) Operational Noise Assessment

(a) Road Traffic Noise

(a1) Calculation of Noise Levels

The Applicant shall analyse the scope of the proposed modification works within the meaning of Items A.1 of Schedule 2 of EIAO for the purpose of traffic noise impact assessment. Figures showing extents of road sections within the meaning of Items A.1 of Schedule 2 of EIAO and other road sections shall be provided in the EIA report. In determining whether the traffic noise impact due to a road improvement project/ work is considered significant, detailed information with respect to factors including change of nature of road, change of alignment and change of traffic capacity or traffic composition etc. shall be assessed. The traffic noise impact shall be considered significant if the traffic noise level with the Project is greater than that without the Project at the design year by 1.0 dB(A) or more.

The Applicant shall calculate expected road traffic noise using methods described in the U.K. Department of Transport's "*Calculation of Road Traffic Noise*" (1988). Calculations of future road traffic noise shall be based on peak hour traffic flow in respect of maximum traffic projection within a 15 years period upon commencement of operation of the Project..

The EIA report shall contain sample calculations and input parameters for at least 10 assessment points as requested by the Director. Also, the Applicant shall provide the input data set of the traffic noise model in the format of electronic files in the EIA. The Applicant shall prepare and provide drawings (i.e., road-plots of the traffic noise model) of appropriate scale to show the road segments, topographic barriers, and assessment points of sensitive

receivers input into the traffic noise model.

The Applicant shall provide input data sets of traffic noise prediction model adopted in the EIA study as requested by the Director for the following scenarios:

- (1) unmitigated scenario at assessment year;
- (2) mitigated scenario at assessment year; and
- (3) prevailing scenario for indirect technical remedies eligibility assessment;

The data shall be in electronic text file (ASCII format) containing road segments, barriers and noise sensitive receivers information. The data structure of the above file shall be agreed with the Director. CD-ROM(s) containing the above data shall be attached in the EIA report.

(a2) Presentation of Noise Levels

The Applicant shall present the existing and future noise levels in  $L_{10}$  (1 hour) at the NSRs at various representative floor levels in (m P.D.) on tables and plans of suitable scale.

A quantitative assessment at the NSRs for road sections within the meaning of Items A.1 of Schedule 2 of EIAO shall be carried out and compared against the criteria set out in Table 1A of Annex 5 of the TM. The potential noise impact of road sections within the meaning of Items A.1 of Schedule 2 of EIAO shall be quantified by estimating the total number of dwellings, classrooms and other noise sensitive elements that will be exposed to noise levels exceeding the criteria set in Table 1A of Annex 5 in the TM.

(a3) Proposals for Noise Mitigation Measures

The Applicant shall propose, in accordance with Section 6 in Annex 13 of the TM, direct technical remedies in all situations where predicted traffic noise level due to the road sections within the meaning of Items A.1 of Schedule 2 of EIAO, exceeds the criteria in Table 1A of Annex 5 in the TM by 1 dB(A) or more, and, under section 4.4.3 of the TM, noise from the road sections within the meaning of Items A.1 of Schedule 2 of EIAO has significant contribution to the cumulative environmental impacts which would exceed the criteria when considered in conjunction with the existing or potential impacts from other projects. The direct mitigation measures listed under Section 6.1, Annex 13 of the EIAO-TM shall be thoroughly explored and evaluated with a view to reducing the noise level at the NSRs concerned to the level meeting the relevant noise criteria. Also, the feasibility, practicability, programming and effectiveness of the recommended mitigation measures should be assessed in accordance with section 4.4.2(k) of the EIAO-TM. Reasons for not adopting certain direct technical remedies in the design to reduce the traffic noise to a level meeting the criteria in the TM or to maximize the protection

for NSRs as far as possible shall be clearly and specifically quantified and laid down in the EIA report.

Following the guiding principles set out in the Legislative Council Paper (LC Paper no. CB(1)755/02-03(01)) prepared by ETWB in January 2003, sections of barriers proposed to protect existing NSRs shall be differentiated clearly from those proposed for the protection of future or planned NSRs as the latter is only required to be constructed before the occupation of the planned NSRs. To facilitate the phased implementation of the barriers under this principle, a barrier inventory showing intended NSRs (i.e. existing NSRs as distinct from planned NSRs) to be protected by different barrier sections to achieve different extent of noise reduction (by how many dB(A)) should be provided.

The total number of dwellings, classrooms and other noise sensitive element that will benefit from, and be protected by the provision of direct technical remedies shall be provided. In order to clearly present the extents/locations of recommended noise mitigation measures, plans prepared from 1:1000 or 1:2000 survey maps showing the mitigation measures (e.g., enclosures/barriers, low noise road surfacing, etc.) shall be included in the EIA report.

The total number of dwellings, classrooms and other noise sensitive elements that will still be exposed to noise levels above the criteria with the implementation of all recommended direct technical remedies shall be quantified.

The Applicant shall provide, in the EIA report information of recommended noise mitigation measures (to include at least barrier types, nominal dimensions at different cross-sections, extents/locations, lengths, mPD levels of barriers).

In case where a number of NSRs cannot be protected by the recommended direct technical remedies, the Applicant shall identify and estimate the total number of existing dwellings, classrooms and other noise sensitive elements which may qualify for indirect technical remedies, the associated costs and any implications for such implementation. For the purpose of determining eligibility of the affected premises for indirect technical remedies, reference shall be made to the following set of three criteria :

- (1) the predicted overall noise level at the NSR from the road sections within the meaning of Items A.1 of Schedule 2 of EIAO together with other traffic noise in the vicinity must be above a specified noise level ( e.g. 70 dB(A) for domestic premises and 65 dB(A) for education institutions, all in L10(1hr) );
- (2) the predicted overall noise level at the NSR is at least 1.0 dB(A) more than the prevailing traffic noise level, i.e. the total traffic noise level existing before the works to construct



the road were commenced; and  
(3) the contribution from the road sections within the meaning of Items A.1 of Schedule 2 of EIAO to the increase in predicted overall noise level at the NSR must be at least 1.0 dB(A).

(b) Fixed Noise Sources

If the Project will cause any fixed noise sources, such as the ventilation systems of enclosed road sections, if any, the following assessment shall be followed.

(b1) Assessment of Fixed Source Noise Levels

The Applicant shall calculate the expected noise using standard acoustics principles. Calculations for the expected noise shall be based on assumed plant inventories and utilization schedule for the worst-case scenario. The Applicant shall calculate noise levels taking into account correction of tonality, impulsiveness and intermittency in accordance with Technical Memorandum for the Assessment of Noise from Places other than Domestic Premises, Public Places or Construction Sites issued under the NCO.

(b2) Presentation of Noise Levels

The Applicant shall present the existing and future noise levels in  $L_{eq}$  (30 min) at the NSRs at various representative floor levels (in m P.D.) on tables and plans of suitable scale. A quantitative assessment at the NSRs for the proposed fixed noise source(s) shall be carried out and compared against the criteria set out in Table 1A of Annex 5 of the TM.

(b3) Proposals for Noise Mitigation Measures

The Applicant shall propose direct technical remedies within the Project limits in all situations where the predicted noise level exceeds the criteria set out in Table 1A of Annex 5 of the TM to protect the affected NSRs.

(vii) Assessment of Side Effects and Constraints

The Applicant shall identify, assess and propose means to minimize any side effects and to resolve any potential constraints due to the inclusion of any recommended direct technical remedies.

### **3.6.2 Air Quality Impact**

3.6.2.1 The Applicant shall follow the criteria and guidelines for evaluating and assessing air quality impact as stated in section 1 of Annex 4 and Annex 12 of the TM, respectively. In particular, special attention shall be paid to the operational phase air quality impact assessment.

- 3.6.2.2 The study area for air quality impact assessment shall generally be defined by a distance of 500 metres from the boundary of the Project site, yet it shall be extended to include major emission sources that may have a bearing on the environmental acceptability of the Project. Such assessment shall be based on the best available information at the time of the assessment. In particular, the assessment for the operation stage shall take into account the impacts of major emission sources.
- 3.6.2.3 The Applicant shall assess the air pollutant concentrations in accordance with the Guidelines for Local-Scale Air Quality Assessment Using Models given in Appendices B1 to B3, or other methodology as agreed by the Director (The Applicant shall note that the “Odour Impact” in sub-section 3.8 of Appendix B-1 is unlikely to be relevant to this Project unless there are major changes in the Project or circumstances during the course of this EIA study).
- 3.6.2.4 The air quality impact assessment shall include the following:
- (i) Background and Analysis of Activities
    - (a) Provide background information relating to air quality issues relevant to the Project, such as description of the types of activities of the Project that may affect air quality during both construction and operation stages.
    - (b) Give an account, where appropriate, of the works/measures that had been taken into consideration in the planning of the Project to abate the air pollution impact. That is, the Applicant shall consider alternative construction methods/phasing programmes and alternative modes of operation to minimize the constructional and operational air quality impact respectively.
    - (c) Present the background air quality levels in the assessment area for the purpose of evaluating the cumulative constructional and operational air quality impacts due to the Project.
  - (ii) Identification of Air Sensitive Receivers (ASRs) and Examination of Emission/Dispersion Characteristics
    - (a) Identify and describe representative existing and planned/ committed ASRs that would likely be affected by the Project, including those earmarked on the relevant Outline Zoning Plan(s), Outline Development Plans, Layout Plans and other relevant published land use plans, including plans and drawings published by Lands Department. The Applicant shall select the assessment points of the identified ASRs such that they represent the worst impact point of these ASRs. A map showing the location and description including the name of buildings, their uses and height of selected assessment points shall be given. Separation distances of these ASRs from the nearest emission sources shall also be given.
    - (b) Provide a list of air pollutant emission sources, including any nearby emission sources which are likely to have impact related to the Project based on the analysis of the constructional and operational activities in sub-section 3.6.2.4(i) above. Examples of construction stage emission

include stock piling, vehicular movements on unpaved haul roads within the project site etc. Examples of operational stage emission sources include exhaust emissions from vehicles etc. Confirmation regarding the validity of assumptions and the magnitude of activities (e.g. traffic mix and volume on a road etc.) shall be obtained from the relevant government departments/authorities and documented.

(iii) Construction Phase Air Quality Impact

- (a) The Applicant shall follow the requirements stipulated under the Air Pollution Control (Construction Dust) Regulation to ensure that construction dust impacts are controlled within the relevant standards as stipulated in section 1 of Annex 4 of the TM. If necessary, a monitoring and audit programme for the construction phase shall be devised to verify the effectiveness of the control measures proposed so as to ensure proper construction dust control.
- (b) If the Applicant anticipates that the Project and, if applicable, the Project together with concurrent projects within the assessment area of the air quality assessment, will give rise to significant construction dust impacts likely to exceed the recommended limits in the TM at the ASRs despite the incorporation of the dust control measures proposed in accordance with sub-section 3.6.2.4(iii)(a) above, a quantitative assessment should be carried out to evaluate the construction dust impact at the identified ASRs. The Applicant shall follow the methodology set out in sub-section 3.6.2.4(v) below when carrying out the quantitative assessment.

(iv) Operational Phase Air Quality Impact

- (a) The Applicant shall calculate the expected air pollutant concentrations at the identified ASRs based on an assumed reasonably worst-case scenario under normal operating condition. The evaluation shall be based on the strength of the emission sources identified in sub-section 3.6.2.4(ii)(b) above. The Applicant shall follow sub-section 3.6.2.4(v) below when carrying out the quantitative assessment.
- (b) The air pollution impacts of future road traffic shall be calculated based on the highest emission strength from the road within the next 15 years upon commencement of operation of the Project. The Applicant shall demonstrate that the selected year of assessment represents the highest emission scenario given the combination of vehicular emission factors and traffic flow for the selected year. The Fleet Average Emission Factors used in the assessment shall be agreed with the Director. If necessary, the Fleet Average Emission Factors shall be determined by a motor vehicle emission model such as EMFAC-HK model to be agreed with the Director. All the traffic flow data and assumptions that used in the assessment shall be clearly and properly documented in the EIA report.
- (c) If full enclosures are proposed in the Project, it is the responsibility of the Applicant to ensure that the air quality inside these proposed structures shall comply with EPD's "*Practice Note on Control of Air Pollution in Vehicle Tunnels*". When assessing air quality impact due to emissions from full enclosures, the Applicant shall ensure prior

agreement with the relevant ventilation design engineer over the amount and the types/kinds of pollutants emitted from these full enclosures; and such assumptions shall be clearly and properly documented in the EIA report.

(v) Quantitative Assessment Methodology

- (a) The Applicant shall conduct the quantitative assessment with reference to relevant sections of the modelling guidelines stated in section 3.6.2.3 or any other methodology as agreed with the Director. The specific methodology must be documented in such level of details (preferably with tables and diagrams) to allow the readers of the EIA report to grasp how the model has been set up to simulate the situation at hand without referring to the model input files. Detailed calculation of the pollutant emission rates for input to the model and a map showing all the road links shall be presented in the EIA report. The Applicant shall ensure consistency between the text description and the model files at every stage of submissions for review. In case of doubt, prior agreement between the Applicant and the Director on specific modelling details shall be sought.
- (b) The Applicant shall identify the key/ representative air pollutant parameters (types of pollutants and the averaging time concentrations) to be evaluated and provide explanation for choosing such parameters for assessing the impact of the Project.
- (c) The Applicant shall calculate the cumulative air quality impact at the identified ASRs and compare these results against the criteria set out in section 1 of Annex 4 in the TM. The predicted air quality impacts (both unmitigated and mitigated) shall be presented in the form of summary table and pollution contours, to be evaluated against the relevant air quality standards and on any effect they may have on the land use implications. Plans of a suitable scale shall be used to present pollution contour to allow buffer distance requirements to be determined properly.
- (d) If there are any direct technical noise remedies recommended in the study, the air quality implication due to these technical remedies shall be assessed. For instance, if barriers that may affect dispersion of air pollutants are proposed, then the implications of such remedies on air quality impact shall be assessed. If noise enclosure is proposed, then portal emissions of the enclosed road section and air quality inside the enclosed road section shall also be addressed. The Applicant shall highlight clearly the locations and types of agreed noise mitigating measures (where applicable), be they noise barriers, road enclosures and their portals, and affected ASR's, on contour maps for easy reference.

(vi) Mitigation Measures for Non-compliance

The Applicant shall propose remedies and mitigating measures where the predicted air quality impact exceeds the criteria set in section 1 of Annex 4 in the TM. These measures and any constraints on future land use

planning shall be agreed with the relevant government departments/ authorities and documented in the EIA report. The Applicant shall demonstrate quantitatively that the resultant impacts after incorporation of the proposed mitigating measures will comply with the criteria stipulated in section 1 of Annex 4 in the TM.

(vii) Submission of Model Files

All input and output file(s) of the model run(s) shall be submitted to the Director in electronic format.

### **3.6.3 Water Quality Impact (Construction Stage)**

3.6.3.1 The Applicant shall follow the criteria and guidelines for evaluating and assessing water pollution as stated in Annexes 6 and 14 of the TM respectively.

3.6.3.2 The Study Area shall include all areas within 300m from the Project boundary, and shall cover relevant water sensitive receivers that have a bearing on the environmental acceptability of the Project within the Victoria Harbour (Phase 2) Water Control Zone. This study area may be extended to include other areas being impacted such as stream courses and the associated water systems in the vicinity.

3.6.3.3 The physical, chemical and biological disruptions of the Victoria Harbour (Phase 2) Water Control Zone and fresh/ storm water and ground water system(s) within the study area arising during the construction of the Project shall be identified.

3.6.3.4 The water quality impact assessment shall address the following :

General

- (i) Collection and review of background information on the existing water system(s) and water sensitive receivers which might be affected by the Project.
- (ii) Characterization of water quality of the water systems and water sensitive receivers which might be affected by the Project and associated works during construction based on existing best available information or site surveys/tests as appropriate.
- (iii) Identification and analysis of relevant existing and planned activities, beneficial uses and water sensitive receivers related to the affected water system(s). The Applicant shall refer to, *inter alia*, those developments and uses earmarked on the relevant Outline Zoning Plans, Development Permission Area Plans, Outline Development Plans and Layout Plans.
- (iv) Identification of pertinent water quality objectives and establishment of other appropriate water quality criteria or standards for the water system(s) and the water sensitive receivers.
- (v) Review the specific construction methods and configurations of the Project. Identification of any alteration of watercourses and drainage system.
- (vi) Identification, analysis and quantification of existing and likely future

water pollution sources, including but are not limited to, point discharges and non-point sources to surface water runoff, sewage from workforce and polluted discharge generated from the Project. Field investigation and laboratory tests shall be conducted as appropriate. Establishment and provision of a pollution load inventory on the quantities and characteristics of these pollution sources. Field investigation and laboratory tests shall be conducted as appropriate to fill in any major information gaps.

#### Impact Prediction

- (vii) Prediction and quantification of the impacts on the water system(s) and the water sensitive receivers due to those alterations and changes identified in (v) and the pollution sources identified in (vi). The prediction shall take into account and include likely different construction stages or sequences.
- (viii) Cumulative impacts due to other projects, activities or pollution sources within a boundary around the Study Area to be agreed by the Director shall also be predicted and quantified.

#### Mitigation

- (ix) Analysis on the provision and adequacy of existing and planned future facilities to reduce pollution arising from the point and non-point sources identified in (vi).
- (x) Proposal of effective and practicable infrastructure upgrading or provision, water pollution prevention and mitigation measures to be implemented during the construction stage so as to reduce the water quality impacts to within acceptable levels of standards. Requirements to be incorporated in the Project contract document shall also be proposed.
- (xi) Best management practices to reduce storm water and non-point source pollution shall be investigated and proposed as appropriate. Attention shall be made to the water quality control and mitigation measures recommended in ProPECC Note 1/94 on construction site drainage.
- (xii) Evaluation and quantification of residual impacts on the water system(s) and the water sensitive receivers with regard to the appropriate water quality criteria, standards or guidelines.

### **3.6.4 Waste Management Implications (Construction Stage)**

3.6.4.1 The Applicant shall follow the criteria and guidelines for evaluating and assessing waste management implications as stated in Annexes 7 and 15 of the TM respectively.

3.6.4.2 The assessment of waste management implications shall cover the following:

- (i) Analysis of Activities and Waste Generation

The Applicant shall identify the quantity, quality and timing of the

waste arising as a result of the construction activities of the Project, based on the sequence and duration of these activities.

(ii) Proposal for Waste Management

- (a) Prior to considering the disposal options for various types of wastes, opportunities for reducing waste generation, on-site or off-site re-use and recycling shall be fully evaluated. Measures which can be taken in the planning and design stages e.g. by modifying the design approach and in the construction stage for maximizing waste reduction shall be separately considered.
- (b) After considering the opportunities for reducing waste generation and maximizing re-use, the types and quantities of the wastes required to be disposed of as a consequence shall be estimated and the disposal methods/ options for each type of wastes shall be described in detail. The disposal methods/ options recommended for each type of wastes shall take into account of the result of the assessment in (c) below; and
- (c) The impact caused by handling (including stockpiling, labelling, packaging & storage), collection, transportation and reuse/ disposal of wastes shall be addressed in detail and appropriate mitigation measures shall be proposed. This assessment shall cover the following areas :
  - potential hazard;
  - air and odour emissions;
  - noise;
  - wastewater discharge; and
  - public transport.

### **3.6.5 Landscape and Visual Impact**

3.6.5.1 The Applicant shall follow the criteria and guidelines as stated in Annexes 10 and 18 of the TM for evaluating and assessing landscape and visual impacts of any above ground structures, for example noise barrier proposed by the EIA Study, and work areas associated with the Project.

3.6.5.2 Study areas for landscape impact assessment shall include all areas within 100m from the Project. Study area for visual impact assessment shall be defined by the visual envelope of the Project. The defined visual envelope must be shown on a plan in the EIA report.

3.6.5.3 The Applicant shall review relevant Outline Zoning Plans, Outline Development Plans, Layout Plans, other relevant published land use plans, planning briefs and studies, approved planning applications and rezoning proposals which may identify areas of high landscape value, open space, amenity area and green belt designations. Any guidelines on landscape strategies, landscape frameworks, urban design concepts, building height profiles, special design areas, landmarks, designated view corridors, open space networks, landscape links that may affect the appreciation of the Project shall also be reviewed. The aim is to gain an insight to the future outlook of the area so as to assess whether the project can fit into surrounding setting. Any conflict with statutory town plan(s) and any

published land use plans shall be highlighted and appropriate follow-up action shall be recommended.

3.6.5.4 The Applicant shall assess the visual impacts of the Project, in particular the visual impact of any noise barrier proposed by the EIA Study. Clear illustrations including mapping of visual impact is required. The assessment shall include:

- (i) identification and plotting of visual envelope of the Project;
- (ii) identification of the key groups of sensitive receivers within the visual envelope with regard to views from both ground level and elevated vantage points;
- (iii) description of the visual compatibility of the Project with the surrounding and the existing and planned setting, and its obstruction and interference with the key views of the adjacent areas;
- (iv) description of the severity of visual impacts in terms of nature, distance and number of sensitive receivers; and
- (v) recommendation of mitigation measures to minimize adverse effects identified, including provision of a landscape design.

3.6.5.5 Annotated illustration materials such as coloured perspective drawings, plans and section/elevation diagrams, oblique aerial photographs, photographs taken at vantage points, and computer-generated photomontage shall be adopted to fully illustrate the landscape and visual impacts of the Project. In particular, the landscape and visual impacts of the Project with and without mitigation measures shall also be properly illustrated in existing and planned setting by computer-generated photomontage so as to demonstrate the effectiveness of the proposed mitigation measures. All computer graphics shall be compatible with Microstation DGN file format or as agreed with the Director. The Applicant shall record the technical details such as system set-up, software, data files and function in preparing the illustration, which may need to be submitted for verification of the accuracy of the illustrations.

### **3.6.6 Summary of Environmental Outcomes**

The EIA report shall contain a summary of the key environmental outcomes arising from the EIA study, including the population and environmentally sensitive areas protected, environmentally friendly designs recommended, key environmental problems avoided, and the environmental benefits of environmental protection measures recommended.

## **4. ENVIRONMENTAL MONITORING & AUDIT (EM&A) REQUIREMENTS**

4.1 The Applicant shall identify in the EIA study whether there is any need for EM&A activities during the construction phase of the project and, if affirmative, to define the scope of the EM&A requirements for the project in the EIA study.

4.2 Subject to the confirmation of the EIA study findings, the Applicant shall



comply with the requirements as stipulated in Annex 21 of the TM.

- 4.3 The Applicant shall prepare a project implementation schedule (in the form of a checklist as shown in Appendix C to this study brief) containing the EIA study recommendations and mitigation measures with reference to the implementation programme.

## **5. DURATION OF VALIDITY**

- 5.1 The Applicant shall notify the Director of the commencement of the EIA study. If the EIA study does not commence within 36 months after the date of issue of this EIA study brief, the Applicant shall apply to the Director for a fresh EIA study brief before commencement of the EIA study.

## **6. REPORT REQUIREMENTS**

- 6.1 In preparing the EIA report, the Applicant shall refer to Annex 11 of the TM for the contents of an EIA report. The Applicant shall also refer to Annex 20 of the TM, which stipulates the guidelines for the review of an EIA report.
- 6.2 The Applicant shall supply the Director with the following number of copies of the EIA report and the executive summary:
- (i) 30 copies of the EIA report and 30 copies of the executive summary (each bilingual in both English and Chinese) as required under section 6(2) of the EIAO to be supplied at the time of application for approval of the EIA report.
  - (ii) when necessary, addendum to the EIA report and the executive summary submitted in (i) above as required under section 7(1) of the EIAO, to be supplied upon advice by the Director for public inspection.
  - (iii) 20 additional copies of the EIA report and 50 additional copies of the executive summary (each bilingual in both English and Chinese) with or without Addendum as required under section 7(5) of the EIAO, to be supplied upon advice by the Director for consultation with the Advisory Council on the Environment.
- 6.3 To facilitate public inspection of EIA report via EIAO Internet Website, the Applicant shall provide electronic copies of both the EIA report and the executive summary prepared in HyperText Markup Language (HTML) (version 4.0 or later) and in Portable Document Format (PDF version 1.3 or later). For the HTML version, a content page capable of providing hyperlink to each section and sub-section of the EIA report and the executive summary shall be included in the beginning of the document. Hyperlinks to figures, drawings and tables in the EIA report and the executive summary shall be provided in the main text from where respective references are made. Graphics in the report shall be in interlaced GIF format.

- 6.4 The electronic copies of the EIA report and the Executive Summary shall be submitted to the Director at the time of application for approval of the EIA Report.
- 6.5 When the EIA Report and the Executive Summary are made available for public inspection under section 7(1) of the EIA Ordinance, the content of the electronic copies of the EIA Report and the Executive Summary must be the same as the hard copies and the Director shall be provided with the most updated electronic copies.

## **7. OTHER PROCEDURAL REQUIREMENTS**

- 7.1 During the EIA study, if there is any change in the name of the Applicant for this EIA study brief, the Applicant mentioned in this study brief must notify the Director immediately.
- 7.2 If there is any key change in the scope of the project mentioned in Section 1.2 of this EIA study brief and in Project Profile No. PP-426/2010, the Applicant must seek confirmation from the Director in writing on whether or not the scope of issues covered by this EIA study brief can still cover the key changes, and the additional issues, if any, that the EIA study must also address. If the changes to the project fundamentally alter the key scope of this EIA study brief, the Applicant shall apply to the Director for another EIA study brief afresh.

--- END OF EIA STUDY BRIEF ---

December 2010  
Environmental Assessment Division  
Environmental Protection Department

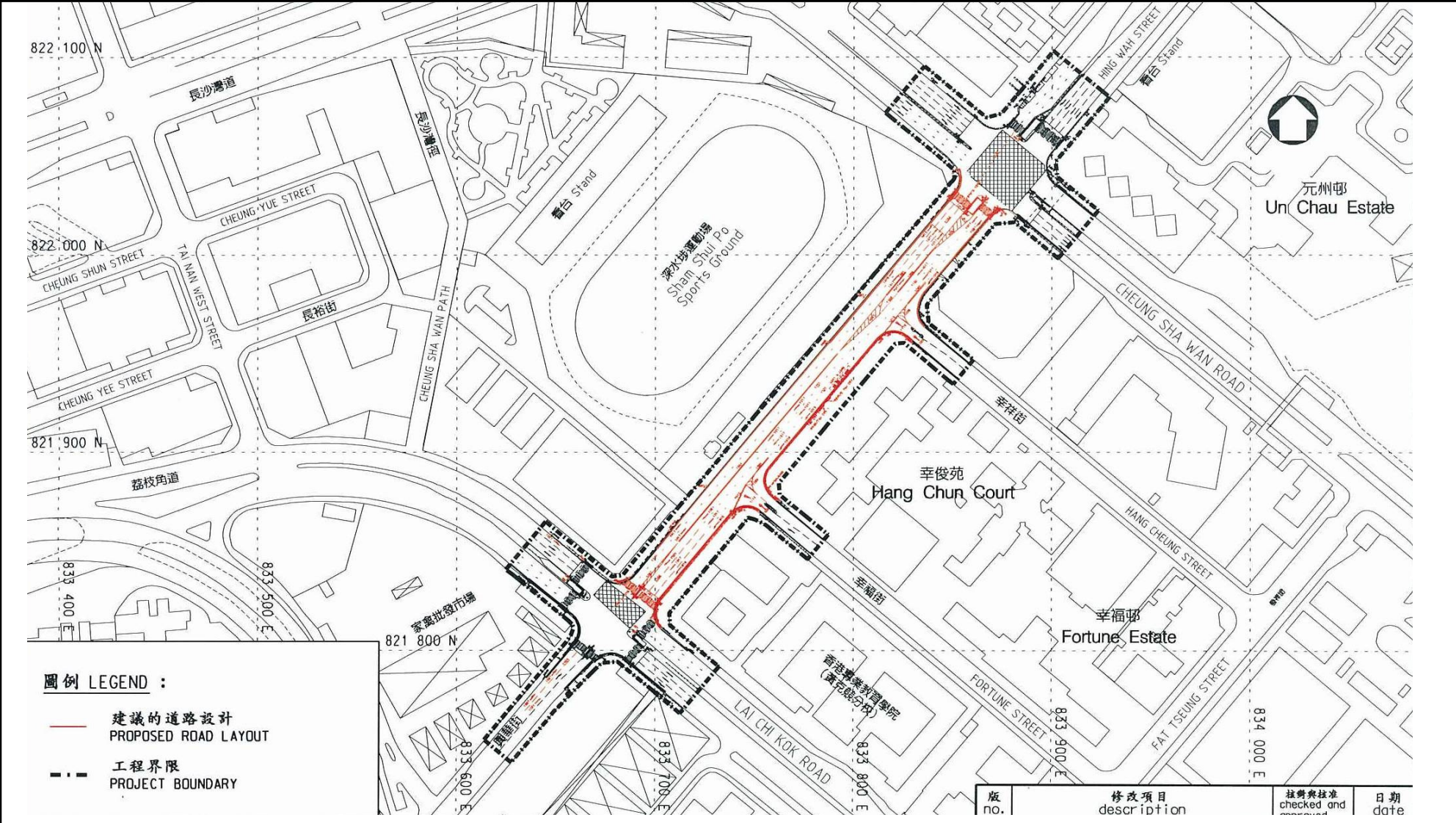

**Project Title: MODIFICATION OF HING WAH STREET BETWEEN LAI CHI KOK ROAD AND CHEUNG SHA WAN ROAD FOR TWO-WAY TRAFFIC**  
**工程名稱 : 改建荔枝角道與長沙灣道之間的一段興華街以實施雙程行車**  
**EIA Study Brief No. : ESB-218/2010**  
**環境影響評估研究概要編號 : ESB-218/2010**

**Figure 1: LOCATION OF THE PROJECT**  
**圖 1: 工程項目地點**

## **Guidelines on Choice of Models and Model Parameters in Air Quality Assessment**

*[The information contained in this Appendix is only meant to assist the Applicant in performing the air quality assessment. The Applicant must exercise professional judgment in applying this general information for the Project.]*

### **1. Introduction**

- 1.1 To expedite the review process by the Authority and to assist project proponents or environmental consultants with the conduct of air quality modelling exercise which are frequently called for as part of environmental impact assessment studies, this paper describes the usage and requirements of a few commonly used air quality models.

### **2. Choice of Models**

- 2.1 The models which have been most commonly used in air quality impact assessments, due partly to their ease of use and partly to the quick turn-around time for results, are of Gaussian type and designed for use in simple terrain under uniform wind flow. There are circumstances when these models are not suitable for ambient concentration estimates and other types of models such as physical, numerical or mesoscale models will have to be used. In situations where topographic, terrain or obstruction effects are minimal between source and receptor, the following Gaussian models can be used to estimate the near-field impacts of a number of source types including dust, traffic and industrial emissions.

<u>Model</u>	<u>Applications</u>
FDM	for evaluating fugitive and open dust source impacts (point, line and area sources)
CALINE4	for evaluating mobile traffic emission impacts (line sources)
ISCST3	for evaluating industrial chimney releases as well as area and volumetric sources (point, area and volume sources); line sources can be approximated by a number of volume sources.

These frequently used models are also referred to as Schedule 1 models (see attached list).

- 2.2 Note that both FDM and CALINE4 have a height limit on elevated sources (20 m and 10m, respectively). Source of elevation above these limits will have to be modelled using the ISCST3 model or suitable alternative models. In using the latter, reference should be made to the 'Guidelines on the Use of Alternative Computer Models in Air Quality Assessment' in Appendix B-3.
- 2.3 The models can be used to estimate both short-term (hourly and daily average) and long-term (annual average) ambient concentrations of air pollutants. The model results, obtained using appropriate model parameters (refer to Section 3) and assumptions, allow direct comparison with the relevant air quality standards such as the Air Quality Objectives (AQOs) for the relevant pollutant and time averaging period.

### **3. Model Input Requirements**

### 3.1 Meteorological Data

3.1.1 At least 1 year of recent meteorological data (including wind speed, wind direction, stability class, ambient temperature and mixing height) from a weather station either closest to or having similar characteristics as the study site should be used to determine the highest short-term (hourly, daily) and long-term (annual) impacts at identified air sensitive receivers in that period. The amount of valid data for the period should be no less than 90 percent.

3.1.2 Alternatively, the meteorological conditions as listed below can be used to examine the worst case short-term impacts:

Day time: stability class D; wind speed 1 m/s (at 10m height); worst-case wind angle; mixing height 500 m

Night time: stability class F; wind speed 1 m/s (at 10m height); worst case wind angle; mixing height 500 m

This is a common practice with using CALINE4 model due to its inability to handle lengthy data set.

3.1.3 For situations where, for example, (i) the model (such as CALINE4) does not allow easy handling of one full year of meteorological data; or (ii) model run time is a concern, the followings can be adopted in order to determine the daily and annual average impacts:

- (i) perform a frequency occurrence analysis of one year of meteorological data to determine the actual wind speed (to the nearest unit of m/s), wind direction (to the nearest 10°) and stability (classes A to F) combinations and their frequency of occurrence;
- (ii) determine the short term hourly impact under all of the identified wind speed, wind direction and stability combinations; and
- (iii) apply the frequency data with the short term results to determine the long term (daily / annual) impacts.

Apart from the above, any alternative approach that will capture the worst possible impact values (both short term and long term) may also be considered.

3.1.4 Note that the anemometer height (relative to a datum same for the sources and receptors) at which wind speed measurements were taken at a selected station should be correctly entered in the model. These measuring positions can vary greatly from station to station and the vertical wind profile employed in the model can be grossly distorted from the real case if incorrect anemometer height is used. This will lead to unreliable concentration estimates.

3.1.5 An additional parameter, namely, the standard deviation of wind direction,  $\sigma_{\theta}$ , needs to be provided as input to the CALINE4 model. Typical values of  $\sigma_{\theta}$  range from 12° for rural areas to 24° for highly urbanised areas under 'D' class stability. For semi-rural such as new development areas, 18° is more appropriate under the same stability condition. The following reference can be consulted for typical ranges of standard deviation of wind direction under different stability categories and surface roughness conditions.

*Ref.(1): Guideline On Air Quality Models (Revised), EPA-450/2-78-027R, United States Environmental Protection Agency, July 1986.*

### 3.2 Emission Sources

All the identified sources relevant to a process plant or a study site should be entered in the model and the emission estimated based on emission factors compiled in the AP-42 (Ref. 2) or other suitable references. The relevant sections of AP-42 and any parameters or assumptions used in deriving the emission rates (in units g/s, g/s/m or g/s/m<sup>2</sup>) as required by the model should be clearly stated for verification. The physical dimensions, location, release height and any other emission characteristics such as efflux conditions and emission pattern of the sources input to the model should also correspond to site data.

If the emission of a source varies with wind speed, the wind speed-dependent factor should be entered.

*Ref.(2): Compilation of Air Pollutant Emission Factors, AP-42, 5<sup>th</sup> Edition, United States Environmental Protection Agency, January 1995.*

### 3.3 Urban/Rural Classification

Emission sources may be located in a variety of settings. For modelling purposes these are classified as either rural or urban so as to reflect the enhanced mixing that occurs over urban areas due to the presence of buildings and urban heat effects. The selection of either rural or urban dispersion coefficients in a specific application should follow a land use classification procedure. If the land use types including industrial, commercial and residential uses account for 50% or more of an area within 3 km radius from the source, the site is classified as urban; otherwise, it is classified as rural.

### 3.4 Surface Roughness Height

This parameter is closely related to the land use characteristics of a study area and associated with the roughness element height. As a first approximation, the surface roughness can be estimated as 3 to 10 percent of the average height of physical structures. Typical values used for urban and new development areas are 370 cm and 100 cm, respectively.

### 3.5 Receptors

These include discrete receptors representing all identified air sensitive receivers at their appropriate locations and elevations and any other discrete or grid receptors for supplementary information. A receptor grid, whether Cartesian or Polar, may be used to generate results for contour outputs.

### 3.6 Particle Size Classes

In evaluating the impacts of dust-emitting activities, suitable dust size categories relevant to the dust sources concerned with reasonable breakdown in TSP (< 30  $\mu$  m) and RSP (< 10  $\mu$  m) compositions should be used.

### 3.7 NO<sub>2</sub> to NO<sub>x</sub> Ratio

The conversion of NO<sub>x</sub> to NO<sub>2</sub> is a result of a series of complex photochemical reactions and has implications on the prediction of near field impacts of traffic emissions. Until further data are available, three approaches are currently acceptable in the determination of NO<sub>2</sub>:

- (a) Ambient Ratio Method (ARM) - assuming 20% of NO<sub>x</sub> to be NO<sub>2</sub>; or
- (b) Discrete Parcel Method (DPM, available in the CALINE4 model); or
- (c) Ozone Limiting Method (OLM) - assuming the tailpipe NO<sub>2</sub> emission to be 7.5% of NO<sub>x</sub> and the background ozone concentration to be in the range of 57 to 68  $\mu\text{g}/\text{m}^3$  depending on the land use type (see also the EPD reference paper 'Guidelines on Assessing the 'TOTAL' Air Quality Impacts' in Appendix B-2).

### 3.8 Odour Impact

In assessing odour impacts, a much shorter time-averaging period of 5 seconds is required due to the shorter exposure period tolerable by human receptors. Conversion of model computed hourly average results to 5-second values is therefore necessary to enable comparison against recommended standard. The hourly concentration is first converted to 3-minute average value according to a power law relationship which is stability dependent (Ref. 3) and a result of the statistical nature of atmospheric turbulence. Another conversion factor (10 for unstable conditions and 5 for neutral to stable conditions) is then applied to convert the 3-minute average to 5-second average (Ref. 4). In summary, to convert the hourly results to 5-second averages, the following factors can be applied:

<u>Stability Category</u>	<u>1-hour to 5-sec Conversion Factor</u>
A & B	45
C	27
D	9
E & F	8

Under 'D' class stability, the 5-second concentration is approximately 10 times the hourly average result. Note, however, that the combined use of such conversion factors together with the ISCST results may not be suitable for assessing the extreme close-up impacts of odour sources.

*Ref.(3): Richard A. Duffee, Martha A. O'Brien and Ned Ostojic, 'Odor Modeling – Why and How', Recent Developments and Current Practices in Odor Regulations, Controls and Technology, Air & Waste Management Association, 1991.*

*Ref.(4): A.W.C. Keddie, 'Dispersion of Odours', Odour Control – A Concise Guide, Warren Spring Laboratory, 1980.*

### 3.9 Plume Rise Options

The ISCST3 model provides by default a list of the U.S. regulatory options for concentration calculations. These are all applicable to the Hong Kong situations except for the 'Final Plume Rise' option. As the distance between sources and receptors are generally fairly close, the non-regulatory option of 'Gradual Plume Rise' should be used instead to give more accurate estimate of near-field impacts due to plume emission. However, the 'Final Plume Rise' option may still be used for assessing the impacts of distant sources.

### 3.10 Portal Emissions

These include traffic emissions from tunnel portals and any other similar openings and are generally modelled as volume sources according to the PIARC 91 (or more up-to-date version) recommendations (Ref. 5, section III.2). For emissions arising from underpasses or any horizontal openings of the like, these are treated as area or point sources depending on the source physical dimensions. In all these situations, the ISCST3 model or more sophisticated models will have to be used instead of the CALINE4 model. In the case of portal emissions with significant horizontal exit velocity which cannot be handled by the ISCST3 model, the impacts may be estimated by the TOP model (Ref. 6) or any other suitable models subject to prior agreement with EPD. The EPD's 'Guidelines on the Use of Alternative Computer Models in Air Quality Assessment' should also be referred to in Appendix B-3.

*Ref.(5): XIXth World Road Congress Report, Permanent International Association of Road Congresses (PIARC), 1991.*

*Ref.(6): N. Ukegunchi, H. Okamoto and Y. Ide "Prediction of vehicular emission pollution around a tunnel mouth", Proceedings 4th International Clean Air Congress, pp. 205-207, Tokyo, 1977.*

### 3.11 Background Concentrations

Background concentrations are required to account for far-field sources which cannot be estimated by the model. These values, to be used in conjunction with model results for assessing the total impacts, should be based on long term average of monitoring data at location representative of the study site. Please make reference to the paper 'Guidelines on Assessing the 'TOTAL' Air Quality Impacts' in Appendix B-2 for further information.

#### 3.11 Output

The highest short-term and long-term averages of pollutant concentrations at prescribed receptor locations are output by the model and to be compared against the relevant air quality standards specified for the relevant pollutant. Contours of pollutant concentration are also required for indicating the general impacts of emissions over a study area. Copies of model files in electronic format should also be provided for EPD's reference.

---

#### **Schedule 1**

**Air Quality Models Generally Accepted by Hong Kong Environmental Protection Department for Regulatory Applications as at 1 July 1998 : \***

**Industrial Source Complex Dispersion Model - Short Term Version 3 (ISCST3)** or the latest version developed by U.S. Environmental Protection Agency

**California Line Source Dispersion Model Version 4 (CALINE4)** or the latest version developed by Department of Transportation, State of California, U.S.A.

**Fugitive Dust Model (FDM)** or the latest version developed by U.S. Environmental Protection Agency

\* EPD is continually reviewing the latest development in air quality models and will update this Schedule accordingly.



## **Guidelines on Assessing the 'TOTAL' Air Quality Impacts**

*[The information contained in this Appendix is only meant to assist the Applicant in performing the air quality assessment. The Applicant must exercise professional judgment in applying this general information for the Project.]*

### **1. Total Impacts - 3 Major Contributions**

- 1.1 In evaluating the air quality impacts of a proposed project upon air sensitive receivers, contributions from three classes of emission sources depending on their distance from the site should be considered. These are:

Primary contributions:	project induced
Secondary contributions:	pollutant-emitting activities in the immediate neighbourhood
Other contributions: (Background contributions)	pollution not accounted for by the previous two

### **2. Nature of Emissions**

#### **2.1 Primary contributions**

In most cases, the project-induced emissions are fairly well defined and quite often (but not necessarily) the major contributor to local air quality impacts. Examples include those due to traffic network, building or road construction projects.

#### **2.2 Secondary contributions**

Within the immediate neighbourhood of the project site, there are usually pollutant emitting activities contributing further to local air quality impacts. For most local scale projects, any emission sources in an area within 500m radius of the project site with notable impacts should be identified and included in an air quality assessment to cover the short-range contributions. In the exceptional cases where there is one or more significant sources nearby, the study area may have to be extended or alternative estimation approach employed to ensure these impacts are reasonably accounted for.

#### **2.3 Background contributions**

The above two types of emission contributions should account for, to a great extent, the air quality impacts upon local air sensitive receivers, which are often amenable to estimation by the 'Gaussian Dispersion' type of models. However, a background air quality level should be prescribed to indicate the baseline air quality in the region of the project site, which would account for any pollution not covered by the two preceding contributions. The emission sources contributing to the background air quality would be located further afield and not easy to identify. In addition, the transport mechanism by which pollutants are carried over long distances (ranging from 1km up to tens or hundreds of kms) is rather complex and cannot be adequately estimated by the 'Gaussian' type of models.

### 3. Background Air Quality - Estimation Approach

#### 3.1 The approach

In view of the difficulties in estimating background air quality using the air quality models currently available, an alternative approach based on monitored data is suggested. The essence of this approach is to adopt the long-term (5-year) averages of the most recent monitored air quality data obtained by EPD. These background data would be reviewed yearly or biennially depending on the availability of the monitored data. The approach is a first attempt to provide a reasonable estimate of the background air quality level for use in conjunction with EIA air quality assessment to address the cumulative impacts upon a locality. This approach may be replaced or supplemented by superior modelling efforts such as that entailed in PATH (Pollutants in the Atmosphere and their Transport over Hong Kong), a comprehensive territory-wide air quality modelling system currently being developed for Hong Kong. Notwithstanding this, the present approach is based on measured data and their long term regional averages; the background values so derived should therefore be indicative of the present background air quality. In the absence of any other meaningful way to estimate a background air quality for the future, this present background estimate should also be applied to future projects as a first attempt at a comprehensive estimate until a better approach is formulated.

#### 3.2 Categorisation

The monitored air quality data, by 'district-averaging' are further divided into three categories, viz, Urban, Industrial and Rural/New Development. The background pollutant concentrations to be adopted for a project site would depend on the geographical constituency to which the site belongs. The categorisation of these constituencies is given in Section 3.4. The monitoring stations suggested for the 'district-averaging'(arithmetic means) to derive averages for the three background air quality categories are listed as follows:

Urban:	Kwun Tong, Sham Shui Po, Tsim Sha Tsui and Central/Western
Industrial:	Kwun Tong, Tsuen Wan and Kwai Chung
Rural/New Development:	Sha Tin, Tai Po, Junk Bay, Hong Kong South and Yuen Long

The averaging would make use of data from the above stations wherever available. The majority of the monitoring stations are located some 20m above ground.

#### 3.3 Background pollutant values

Based on the above approach, background values for the 3 categories have been obtained for a few major air pollutants as follows:

POLLUTANT	URBAN	INDUSTRIAL	RURAL / NEW DEVELOPMENT
NO <sub>2</sub>	59	57	39
SO <sub>2</sub>	21	26	13
O <sub>3</sub>	62	68	57
TSP	98	96	87
RSP	60	58	51

All units are in micrograms per cubic metre. The above values are derived from 1992 to 1996 annual averages with the exception of ozone which represent annual average of daily hourly maximum values for year 1996.

In cases where suitable air quality monitoring data representative of the study site such as those obtained from a nearby monitoring station or on-site sampling are not available for the prescription of background air pollution levels, the above tabulated values can be adopted instead. Strictly speaking, the suggested values are only appropriate for long term assessment. However, as an interim measure and until a better approach is formulated, the same values can also be used for short term assessment. This implies that the short term background values will be somewhat under-estimated, which compensates for the fact that some of the monitoring data are inherently influenced by secondary sources because of the monitoring station location.

Indeed, if good quality on-site sampling data which cover at least one year period are available, these can be used to derive both the long term (annual) and short term (daily / hourly) background values, the latter are usually applied on an hour to hour, day to day basis.

### 3.4 Site categories

The categories to which the 19 geographical constituencies belong are listed as follows:

<b>DISTRICT</b>	<b>AIR QUALITY CATEGORY</b>
Islands	Rural / New Development
Southern	Rural / New Development
Eastern	Urban
Wan Chai	Urban
Central & Western	Urban
Sai Kung	Rural / New Development
Kwun Tong	Industrial
Wong Tai Sin	Urban
Kowloon City	Urban
Yau Tsim	Urban
Mong Kok	Urban
Sham Shui Po	Urban
Kwai Tsing	Industrial
Sha Tin	Rural / New Development
Tsuen Wan	Industrial
Tuen Mun	Rural / New Development
Tai Po	Rural / New Development
Yuen Long	Rural / New Development
Northern	Rural / New Development

### 3.5 Provisions for 'double-counting'

The current approach is, by no means, a rigorous treatment of background air quality but aims to provide an as-realistic-as-possible approximation based on limited field data. 'Double-counting' of 'secondary contributions' may be apparent through the use

of such 'monitoring-based' background data as some of the monitoring stations are of close proximity to existing emission sources. 'Primary contributions' due to a proposed project (which is yet to be realized) will not be double-counted by such an approach. In order to avoid over-estimation of background pollutant concentrations, an adjustment to the values given in Section 3.3 is possible and optional by multiplying the following factor:

$$(1.0 - E_{\text{Secondary contributions}}/E_{\text{Territory}})$$

where E stands for emission.

The significance of this factor is to eliminate the fractional contribution to background pollutant level of emissions due to 'secondary contributions' out of those from the entire territory. In most cases, this fractional contribution to background pollutant levels by the secondary contributions is minimal.

#### **4. Conclusions**

- 4.1 The above described approach to estimating the total air quality impacts of a proposed project, in particular the background pollutant concentrations for air quality assessment, should be adopted with immediate effect. Use of short term monitoring data to prescribe the background concentrations is no longer acceptable.

## **Guidelines on the Use of Alternative Computer Models in Air Quality Assessment**

*[The information contained in this Appendix is only meant to assist the Applicant in performing the air quality assessment. The Applicant must exercise professional judgment in applying this general information for the Project.]*

### **1. Background**

1.1 In Hong Kong, a number of Gaussian plume models are commonly employed in regulatory applications such as application for specified process licences and environmental impact assessments (EIAs). These frequently used models (as listed in Schedule 1 attached; hereafter referred to as Schedule 1 models) have no regulatory status but form the basic set of tools for local-scale air quality assessment in Hong Kong.

1.2 However, no single model is sufficient to cover all situations encountered in regulatory applications. In order to ensure that the best model available is used for each regulatory application and that a model is not arbitrarily applied, the project proponent (and/or its environmental consultants) should assess the capabilities of various models available and adopt one that is most suitable for the project concerned.

1.3 Examples of situations where the use of an alternative model is warranted include:

- (i) the complexity of the situation to be modelled far exceeds the capability of the Schedule 1 models; and
- (ii) the performance of an alternative model is comparable or better than the Schedule 1 models.

1.4 This paper outlines the demonstration / submission required in order to support the use of an alternative air quality model for regulatory applications for Hong Kong.

### **2. Required Demonstration / Submission**

2.1 Any model that is proposed for air quality applications and not listed amongst the Schedule 1 models will be considered by EPD on a case-by-case basis. In such cases, the proponent will have to provide the followings for EPD's review:

- (i) Technical details of the proposed model; and
- (ii) Performance evaluation of the proposed model

Based on the above information, EPD will determine the acceptability of the proposed model for a specific or general applications. The onus of providing adequate supporting materials rests entirely with the proponent.

2.2 To provide technical details of the proposed model, the proponent should submit documents containing at least the following information:

- (i) mathematical formulation and data requirements of the model;
- (ii) any previous performance evaluation of the model; and
- (iii) a complete set of model input and output file(s) in commonly used

electronic format.

- 2.3 On performance evaluation, the required approach and extent of demonstration varies depending on whether a Schedule 1 model is already available and suitable in simulating the situation under consideration. In cases where no Schedule 1 model is found applicable, the proponent must demonstrate that the proposed model passes the screening test as set out in USEPA Document "Protocol for Determining the Best Performing Model" (Ref. 1).
- Ref.(1): William M. Cox, 'Protocol for Determining the Best Performing Model'; Publication No. EPA-454/R-92-025; U.S. Environmental Protection Agency, Research Triangle Park, NC.*
- 2.4 For cases where a Schedule 1 model is applicable to the project under consideration but an alternative model is proposed for use instead, the proponent must demonstrate either that
- (i) the highest and second highest concentrations predicted by the proposed model are within 2 percent of the estimates obtained from an applicable Schedule 1 model (with appropriate options chosen) for all receptors for the project under consideration; or
  - (ii) the proposed model has superior performance against an applicable Schedule 1 model based on the evaluation procedure set out in USEPA Document "Protocol for Determining the Best Performing Model" (Ref. 1).
- 2.5 Should EPD find the information on technical details alone sufficient to indicate the acceptability of the proposed model, information on further performance evaluation as specified in Sections 2.3 and 2.4 above would not be necessary.
- 2.6 If the proposed model is an older version of one of the Schedule 1 models or was previously included in Schedule 1, the technical documents mentioned in Section 2.2 are normally not required. However, a performance demonstration of equivalence as stated in Section 2.4 (i) would become necessary.
- 2.7 If EPD is already in possession of some of the documents that describe the technical details of the proposed model, submission of the same by the proponent is not necessary. The proponent may check with EPD to avoid sending in duplicate information.

---

### **Schedule 1**

**Air Quality Models Generally Accepted by Hong Kong Environmental Protection Department for Regulatory Applications as at 1 July 1998 : \***

**Industrial Source Complex Dispersion Model - Short Term Version 3 (ISCST3)** or the latest version developed by U.S. Environmental Protection Agency

**California Line Source Dispersion Model Version 4 (CALINE4)** or the latest version developed by Department of Transportation, State of California, U.S.A.

**Fugitive Dust Model (FDM)** or the latest version developed by U.S. Environmental Protection Agency

\* EPD is continually reviewing the latest development in air quality models and will update this Schedule accordingly.

**Implementation Schedule of Recommended Mitigation Measures**

EIA Ref.	EM&A Ref.	Recommended Mitigation Measures	Objectives of the Recommended Measure & Main Concerns to address	Who to implement the measure?	Location of the measure	When to implement the measure?	What requirements or standards for the measure to achieve