







LEGEND:

-  BOUNDARY OF STUDY AREA
-  EXTENT OF RECLAMATION
-  V06-41 PHASE 1 CHEMICAL/BIOLOGICAL SCREENING SAMPLING LOCATION
-  V06-9W PHASE 1 ELUTRIATE TEST AND PORE WATER TEST SAMPLING LOCATION
-  V06-12 PHASE 2 CHEMICAL/BIOLOGICAL SCREENING SAMPLING LOCATION
-  V06-4W PHASE 2 ELUTRIATE TEST AND PORE WATER TEST SAMPLING LOCATION

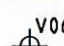
PHASE 1			
CHEMICAL/BIOLOGICAL SCREENING			
VIBROCORE NO.	EASTING	NORTHING	
V06-7	835767	815930	
V06-8	835869	815924	
V06-9	835967	815933	
V06-20	836960	815990	
V06-21	836969	816047	
V06-22	837069	816074	
V06-23	836969	816110	
V06-24	837073	816137	
V06-25	837167	816179	
V06-26	837247	816228	
V06-27	837316	816302	
V06-28	837389	816379	
V06-29	837445	816455	
V06-30	837301	816192	
V06-31	837420	816269	
V06-32	837453	816350	
V06-33	837461	816235	

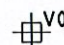
PHASE 1			
CHEMICAL/BIOLOGICAL SCREENING			
VIBROCORE NO.	EASTING	NORTHING	
V06-34	837521	816322	
V06-35	837497	816555	
V06-36	837549	816619	
V06-37	837629	816713	
V06-38	837718	816789	
V06-39	837775	816842	
V06-40	837839	816903	
V06-41	836959	816606	
V06-42	837052	816635	
V06-43	837174	816671	
V06-44	837296	816703	
V06-45	836971	816516	
V06-46	837061	816559	
V06-47	837184	816593	
V06-48	837307	816626	

PHASE 1			
ELUTRIATE TEST AND PORE WATER TEST FOR WATER QUALITY ASSESSMENT			
VIBROCORE NO.	EASTING	NORTHING	
V06-2W	835944	815897	
V06-6W	837130	816123	
V06-7W	836938	815959	
V06-8W	837431	816326	
V06-9W	837049	816632	
V06-10W	837709	816794	

PHASE 2			
CHEMICAL/BIOLOGICAL SCREENING			
VIBROCORE NO.	EASTING	NORTHING	
V06-6	835665	815897	
V06-10	836053	815948	
V06-11	836231	815950	
V06-12	836299	815951	
V06-13	836059	815983	
V06-14	836244	816011	
V06-15	836300	816014	
V06-16	836366	816015	
V06-17	836429	816004	
V06-18	836639	816021	
V06-19	836742	816036	

PHASE 2			
ELUTRIATE TEST AND PORE WATER TEST FOR WATER QUALITY ASSESSMENT			
VIBROCORE NO.	EASTING	NORTHING	
V06-1WB	835667	815893	
V06-3W	836055	815978	
V06-4W	836240	816003	
V06-5W	836671	816036	

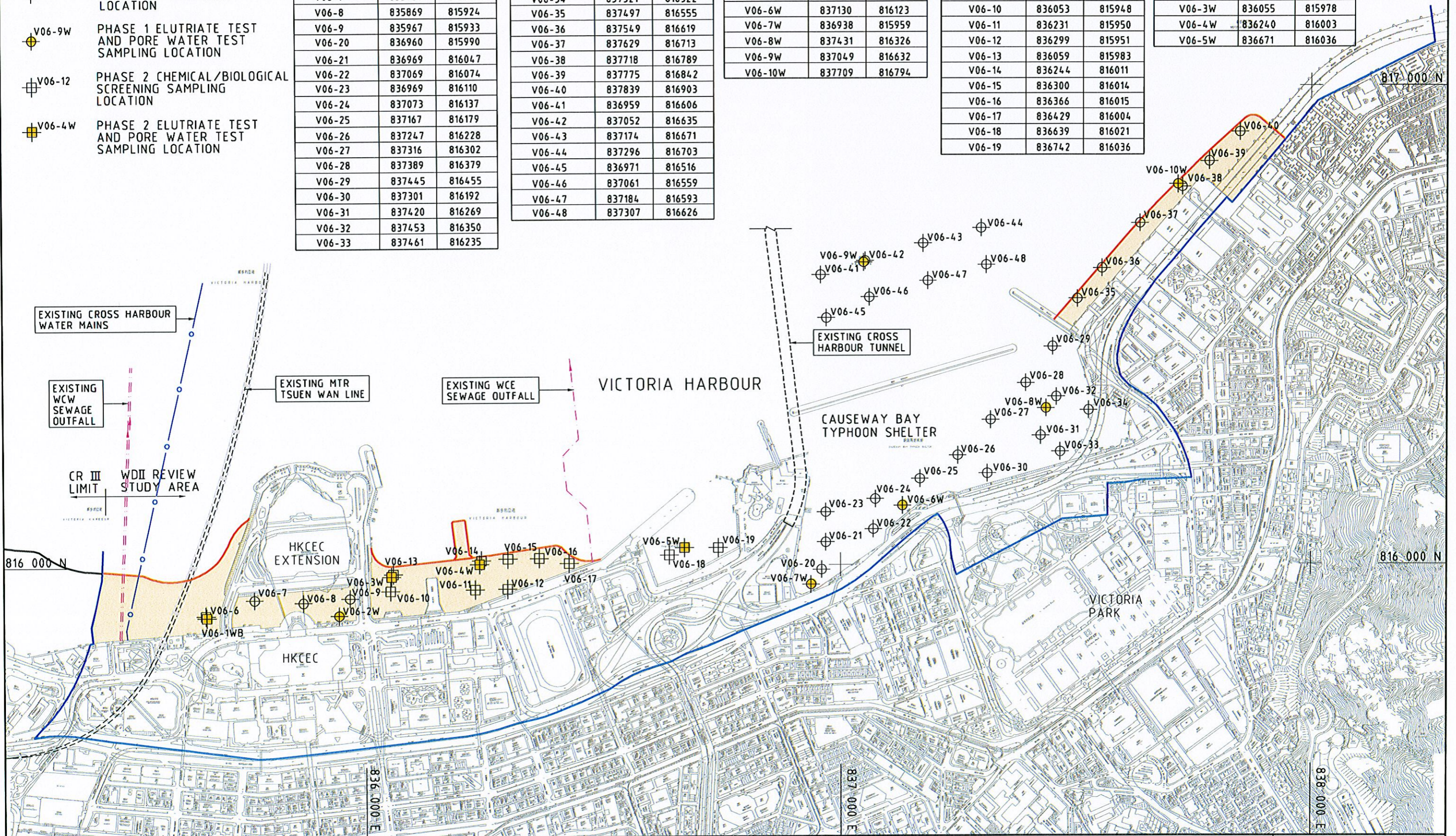

DATE: 2007-5-23 16:09:12

MAUNSELL | AECOM
Maunsell Consultants Asia Ltd

WAN CHAI DEVELOPMENT PHASE II - PLANNING AND ENGINEERING REVIEW
MARINE SEDIMENTS SAMPLING LOCATIONS

FIGURE 6.1

A3 SCALE 1:8000