

B (809800,826000)



500m Study Area

TAPs include Cl, HCl, F, P, Be, As, Mo, Sb, Pt, Se and Rh

TAP concentration = Emission Rate of the TAP (as stated in Section 3 of EIA) x Contour Value + Background (as stated in Section 3 of EIA)

A (809800,824600)



Scale: As shown

Figure B7-N1 Cumulative 1-hour TAPs Concentration ($\mu\text{g}/\text{m}^3$) (with Emission Rate of 1 g/s) at 8.5mPD emitted from Source Location A4 (Mitigated Scenario 2)

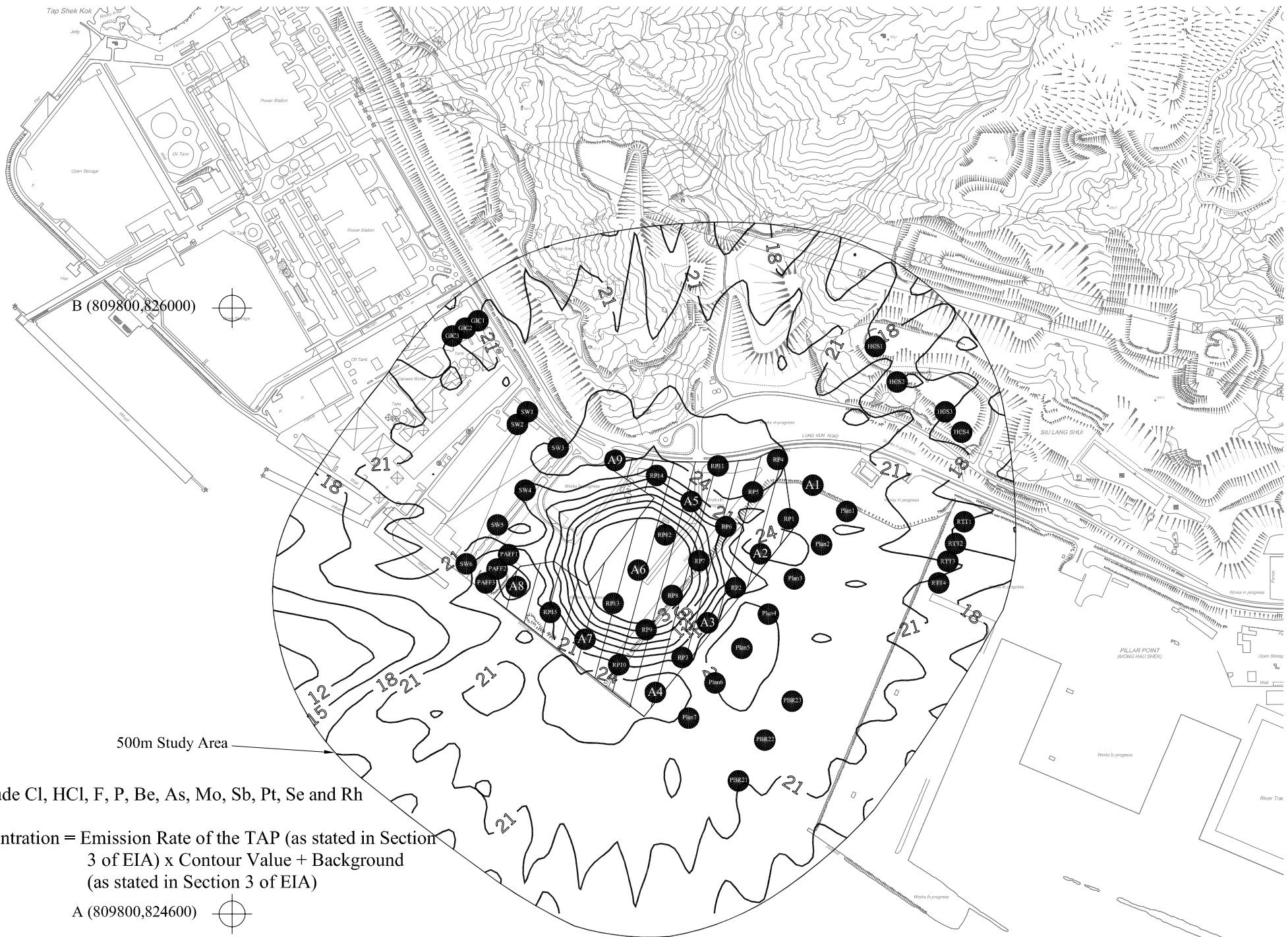

B (809800,826000)



500m Study Area

TAPs include Cl, HCl, F, P, Be, As, Mo, Sb, Pt, Se and Rh

TAP concentration = Emission Rate of the TAP (as stated in Section 3 of EIA) x Contour Value + Background (as stated in Section 3 of EIA)

A (809800,824600)



Scale: As shown

Figure B7-N2 Cumulative 1-hour TAPs Concentration ($\mu\text{g}/\text{m}^3$) (with Emission Rate of 1 g/s) at 8.5mPD emitted from Source Location A6 (Mitigated Scenario 2)

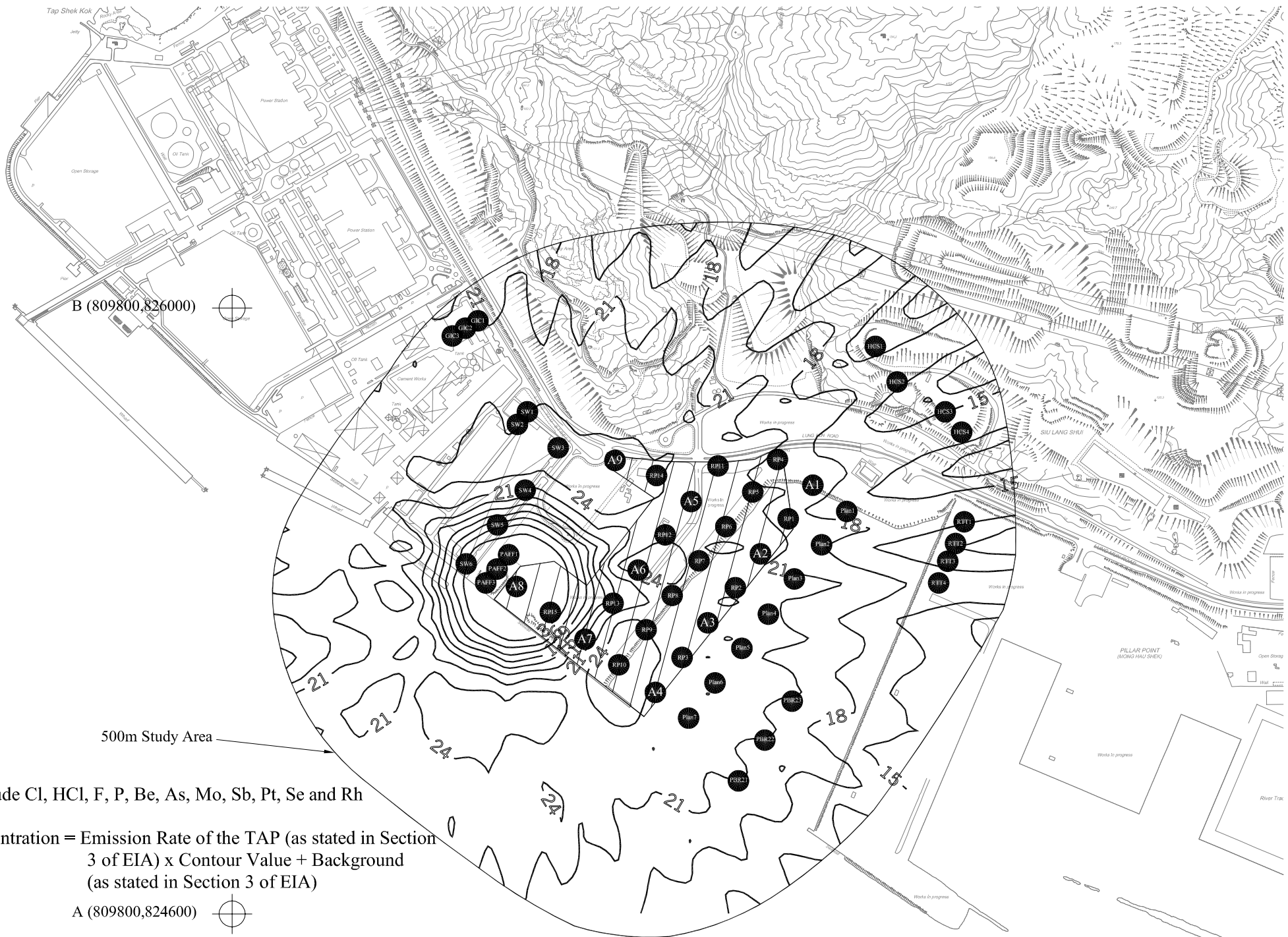

B (809800,826000)



500m Study Area

TAPs include Cl, HCl, F, P, Be, As, Mo, Sb, Pt, Se and Rh

TAP concentration = Emission Rate of the TAP (as stated in Section 3 of EIA) x Contour Value + Background (as stated in Section 3 of EIA)

A (809800,824600)



Scale: As shown

Figure B7-N3 Cumulative 1-hour TAPs Concentration ($\mu\text{g}/\text{m}^3$) (with Emission Rate of 1 g/s) at 8.5mPD emitted from Source Location A8 (Mitigated Scenario 2)

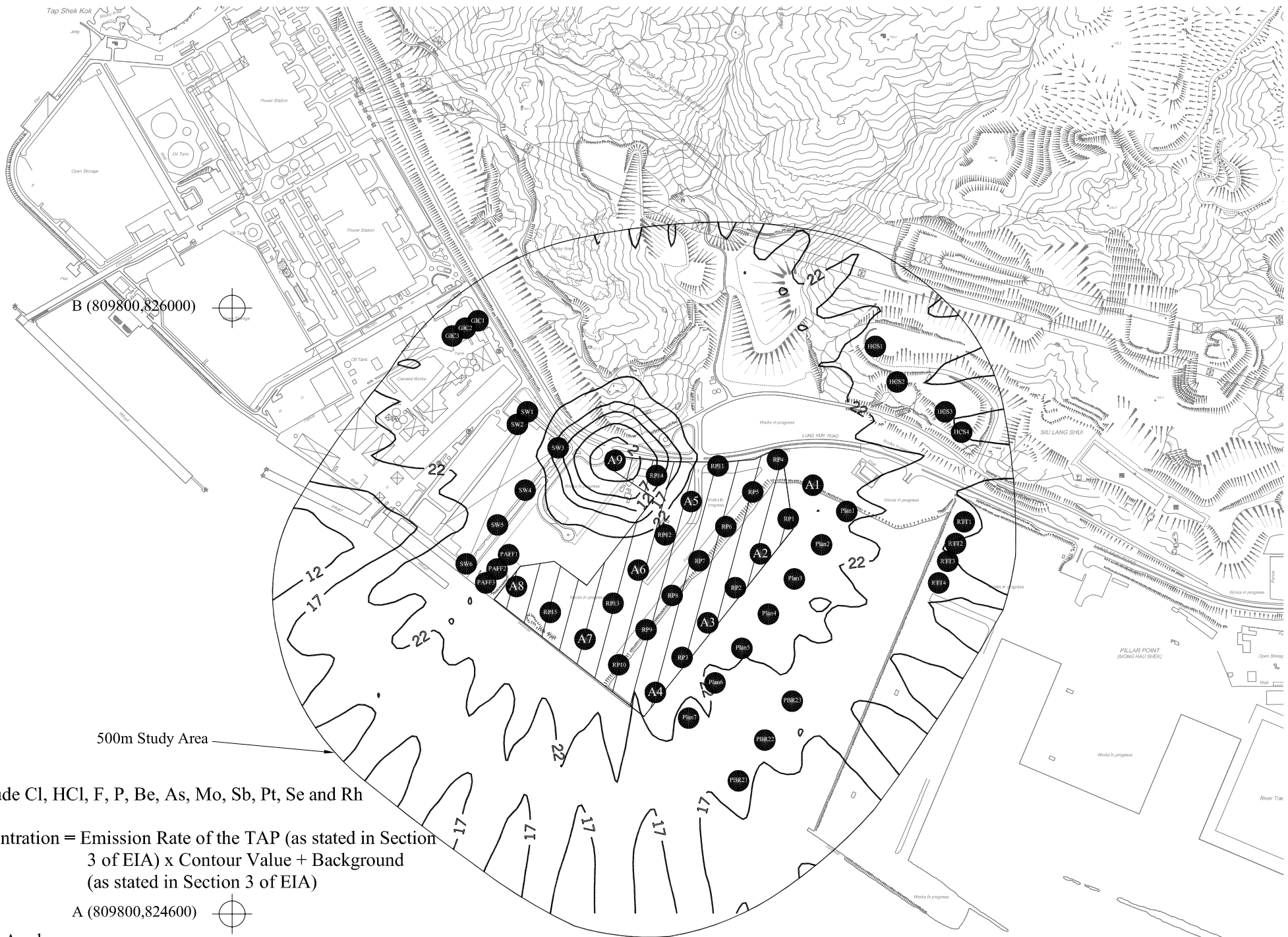

B (809800,826000)



500m Study Area

TAPs include Cl, HCl, F, P, Be, As, Mo, Sb, Pt, Se and Rh

TAP concentration = Emission Rate of the TAP (as stated in Section 3 of EIA) x Contour Value + Background (as stated in Section 3 of EIA)

A (809800,824600)



Scale: As shown

Figure 7-N4 Cumulative 1 Hour TAPs Concentration ($\mu\text{g}/\text{m}^3$) at 22.5mPD emitted from Source Location A9 (Mitigated Scenario 2)

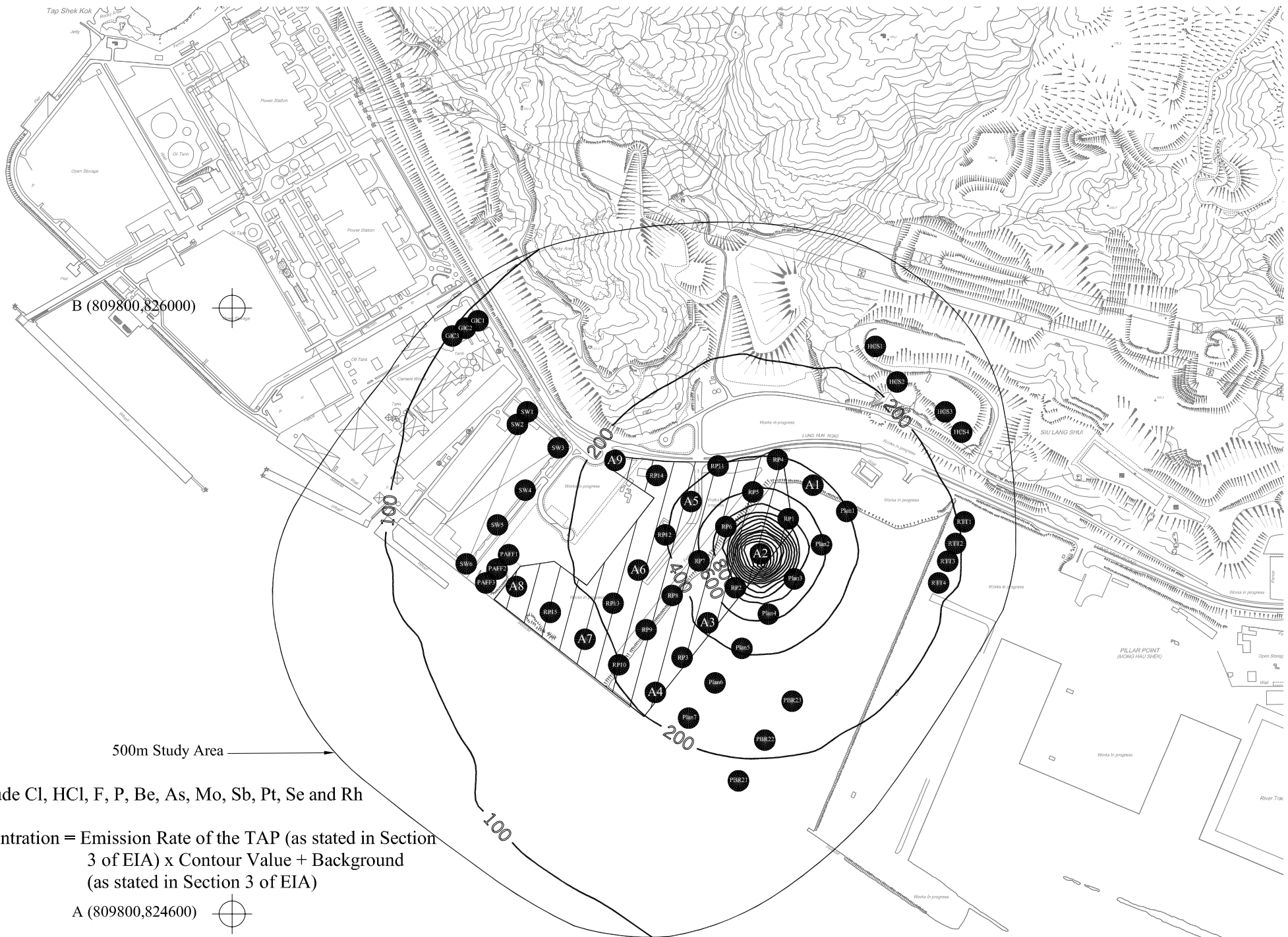

B (809800,826000)



500m Study Area

TAPs include Cl, HCl, F, P, Be, As, Mo, Sb, Pt, Se and Rh

TAP concentration = Emission Rate of the TAP (as stated in Section 3 of EIA) x Contour Value + Background (as stated in Section 3 of EIA)

A (809800,824600)



Scale: As shown

Figure B7-N5 Cumulative 1-hour TAPs Concentration ($\mu\text{g}/\text{m}^3$) (with Emission Rate of 1 g/s) at 61.5mPD emitted from Source Location A2 (Mitigated Scenario 2)

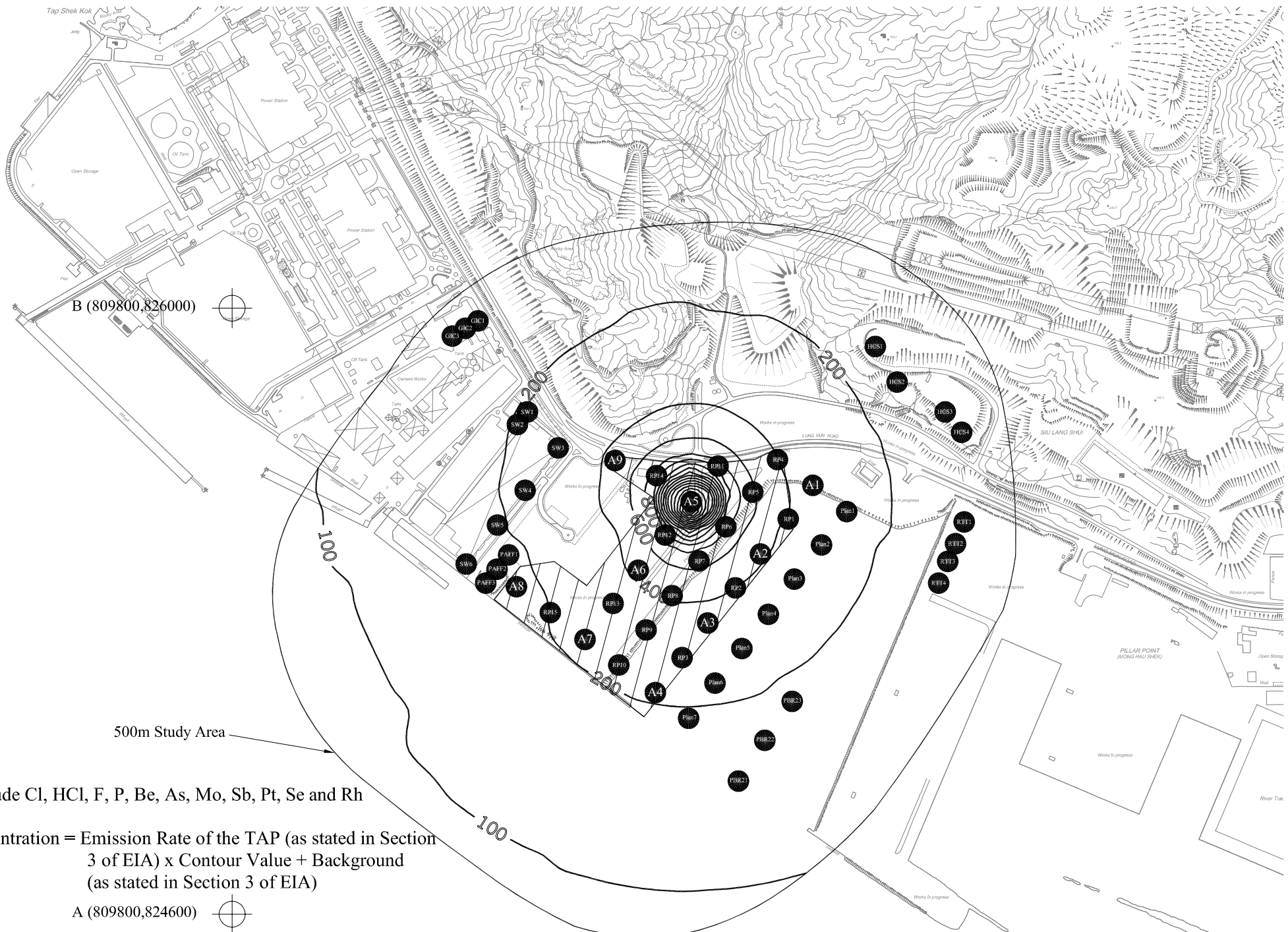

B (809800,826000)



500m Study Area

TAPs include Cl, HCl, F, P, Be, As, Mo, Sb, Pt, Se and Rh

TAP concentration = Emission Rate of the TAP (as stated in Section 3 of EIA) x Contour Value + Background (as stated in Section 3 of EIA)

A (809800,824600)



Scale: As shown

Figure B7-N6 Cumulative 1-hour TAPs Concentration ($\mu\text{g}/\text{m}^3$) (with Emission Rate of 1 g/s) at 61.5mPD emitted from Source Location A5 (Mitigated Scenario 2)