

815 200E

815 400E

835 100E

834 900N



DEEP BAY  
(HAU HOI WAN)

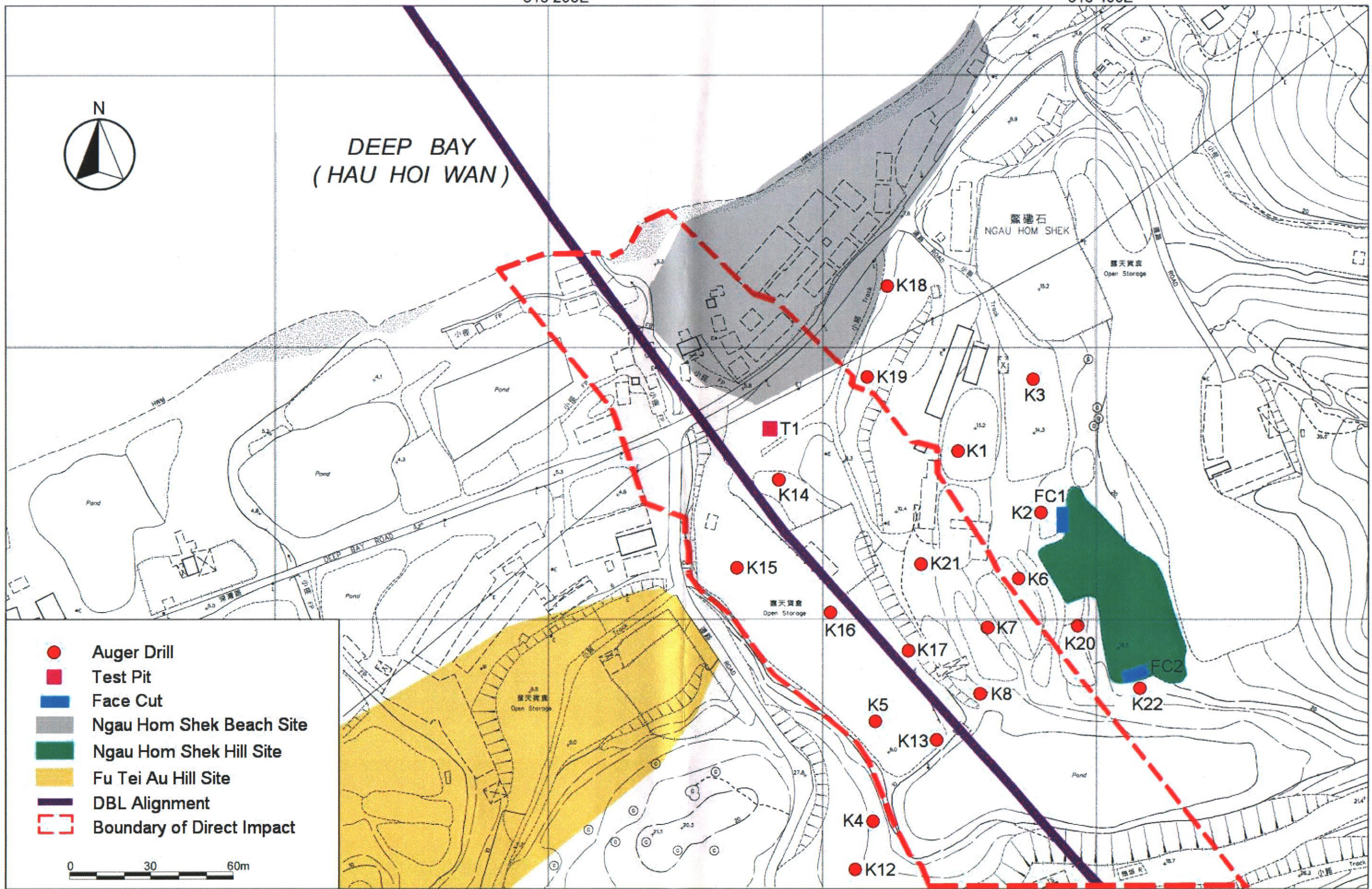

Based on the map of 6-NW-1C (Series HP1C), 1999-Oct ed., from Survey and Mapping Office, Lands Department

- Auger Drill
- Test Pit
- Face Cut
- Ngau Hom Shek Beach Site
- Ngau Hom Shek Hill Site
- Fu Tei Au Hill Site
- DBL Alignment
- Boundary of Direct Impact

Printer by : SYU  
2002/08/06  
Filename : J:\233308\WORKING\Final EM&A\FIGEM-7-2.dgn

|      |      |    |      |
|------|------|----|------|
| Mark | Date | By | Rev. |
|      |      |    |      |
|      |      |    |      |
|      |      |    |      |
|      |      |    |      |

|             |        |
|-------------|--------|
| Designed By | XXXXXX |
| Drawn By    | XXXXXX |
| Checked By  | XXXXXX |
| In Charge   | XXXXXX |
| Date        | XXXXXX |

**路政署**  
**HIGHWAYS DEPARTMENT**  
主要工程管理處  
Major Works Project Management Office

Consultant  
**ARUP** 奧雅納工程顧問  
Ove Arup & Partners Hong Kong Limited  
Supported By:  
Environmental Management Ltd. ○  
BMT Asia Pacific Ltd. ○  
Urbis Ltd. ○

Project Title  
Shenzhen Western Corridor  
Investigation & Planning

Drawing Title  
ARCHAEOLOGICAL SURVEY  
IN THE NGAU HOM SHEK AREA

|                |             |             |              |
|----------------|-------------|-------------|--------------|
| Cad File Name  | FIGEM-7-2   | Cad Date    | MAY 2002     |
| Scale          | 1:1000      | Drawing No. | FIGURE EM7.2 |
| Drawing Status | PRELIMINARY | Rev.        | -            |