

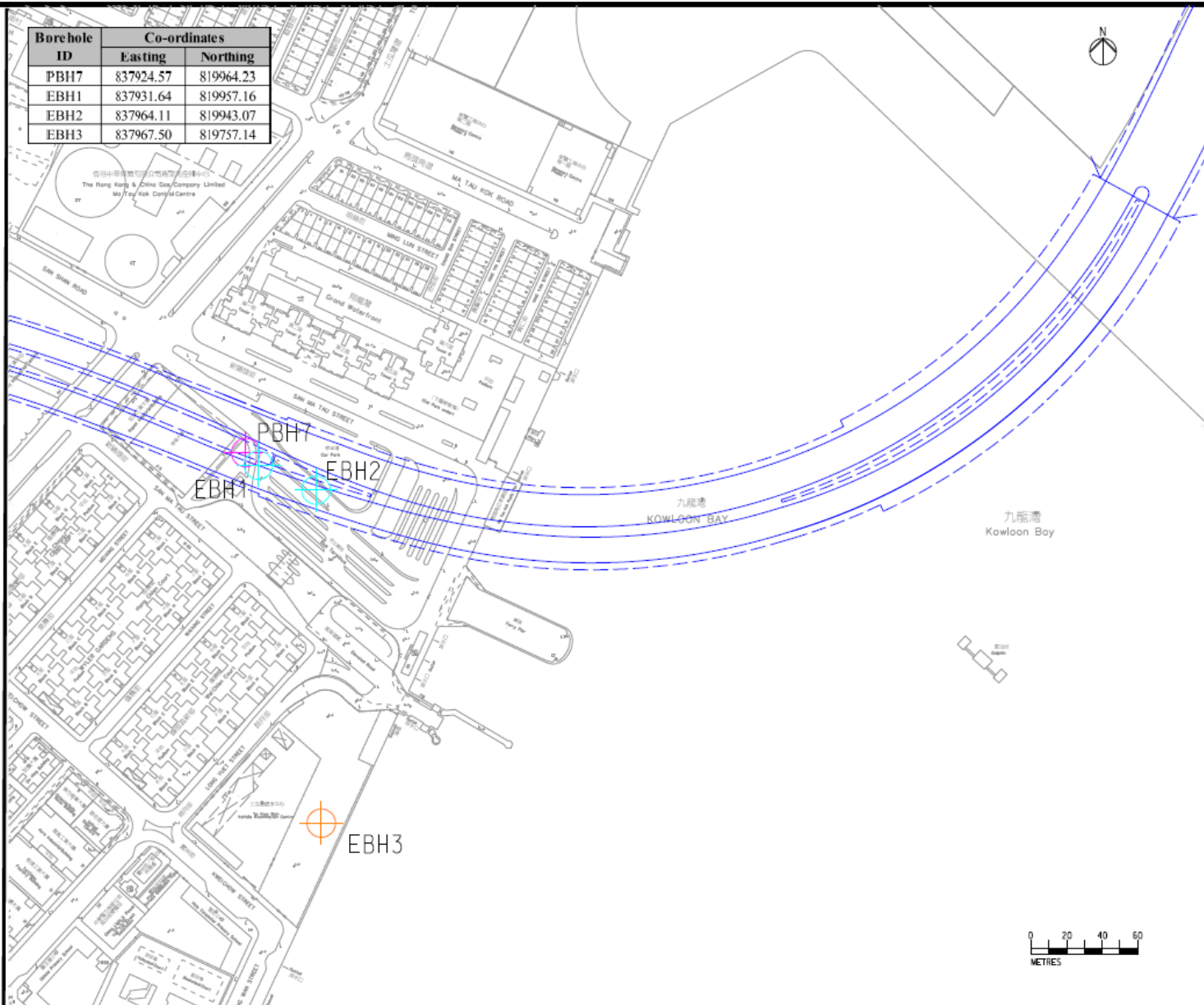



Borehole ID	Co-ordinates	
	Easting	Northing
PBH7	837924.57	819964.23
EBH1	837931.64	819957.16
EBH2	837964.11	819943.07
EBH3	837967.50	819757.14



Legend

-  PBH1 Borehole Locations of the SI Works Conduction in 2009 with RBRGs Exceedance
-  EBH1 Borehole Locations of the SI Works Conduction in 2011 & 2012 (Confirmatory Investigation)
-  EBH3 Borehole Locations for additional Works Area

Project Title - Central Kowloon Route
 工程名稱 - 中九龍幹線

Environmental Permit No. : EP-457/2013/B
 環境許可證編號 : EP-457/2013/B

Figure 4 – Location of Contaminated Borehole and Confirmatory Investigation (East Portion)

圖 4 - 受污染鑽孔及確定研究的地點 (東段)

