

FORM 5  
ENVIRONMENTAL IMPACT ASSESSMENT ORDINANCE  
(CHAPTER 499)  
SECTION 13(1)

Application for Variation of an Environmental Permit

PART A PREVIOUS APPLICATIONS

No previous application for variation of an environmental permit.  
 The environmental permit was previously amended.  
Application No. : .....

PART B DETAILS OF APPLICANT

B1. Name : (person or company)  
Water Supplies Department  
[Note : In accordance with section 13(1) of the Ordinance, the person holding an environmental permit or a person who assumes responsibility for the designated project may apply for variation of the environmental permit.]  
B2. Business Registration No. : [REDACTED]  
(if applicable)  
B3. Correspondence Address : [REDACTED]  
B4. Name of Contact Person : [REDACTED]  
B5. Position of Contact Person : [REDACTED]  
B6. Telephone No. : [REDACTED]  
B7. Fax No. : [REDACTED]  
B8. E-mail Address : (if any) [REDACTED]

PART C DETAILS OF CURRENT ENVIRONMENTAL PERMIT

C1. Name of the Current Environmental Permit Holder :  
Water Supplies Department  
C2. Application No. of the Current Environmental Permit : EP-207/2005  
C3. The Current Environmental Permit was Issued in : month / year  
01 / 2005

Important Notes : Please submit the application together with  
(a) 3 copies of this completed form; and  
(b) appropriate fee as stipulated in the Environmental Impact Assessment (Fees) Regulation  
to the Environmental Protection Department at the following address :  
The EIA Ordinance Register Office,  
27th floor, Southorn Centre, 130 Hennessy Road,  
Wan Chai, Hong Kong.

Tick (✓) the appropriate box



**PART D PROPOSED VARIATIONS TO THE CONDITIONS IN CURRENT ENVIRONMENTAL PERMIT**

D1.  Condition(s) in the Current Environmental Permit :	D2.  Proposed Variation(s) :	D3.  Reason for Variation(s) :	D4.  Describe the environmental changes arising from the proposed variation(s) :	D5.  Describe how the environment and the community might be affected by the proposed variation(s) :	D6.  Describe how and to what extent the environmental performance requirements set out in the EIA report previously approved or project profile previously submitted for this project may be affected :	D7.  Describe any additional measures proposed to eliminate, reduce or control any adverse environmental impact arising from the proposed variation(s) and to meet the requirements in the Technical Memorandum on Environmental Impact Assessment Process :
<p><u>Condition 3.2</u></p> <p>To provide visual screening, trees of native species shall be planted along the site boundary as shown in Figure 1. The newly planted trees shall be maintained throughout the operation of the Project.</p>	<p>It is proposed to revise Condition 3.2 of the Environmental Permit (EP) as "To provide visual screening, vertical greening shall be provided on the external walls of Siu Ho Wan Water Treatment Works Extension building."</p> <p>It is also proposed to update Figure 1 of the EP to reflect the proposed variation.</p>	<p>As the north-western / northern sides of the Siu Ho Wan (SHW) Water Treatment Works (WTW) is fully occupied by existing and proposed underground utilities, existing Emergency Vehicle Access and footpath, planting of trees along these sides of the SHW WTW site boundary is infeasible.</p> <p>After the Environmental Impact Assessment (EIA) stage, there has been a significant increase in the density and size of trees and amenity planting at the cut slope around the SHW WTW site as well as along Cheung Tung Road, which would already provide a dense screen to the SHW WTW extension works. Therefore, additional tree planting along the north-western boundary of the SHW WTW as required in the EP would not provide any significant further screening to the SHW WTW extension.</p> <p>Please refer to Annex A for details.</p>	<p>The growth of trees and amenity planting at the cut slope around the SHW WTW site and along Cheung Tung Road after the EIA stage as mentioned in Part D3 would provide similar visual screening effect as required under Condition 3.2 of the existing EP. In addition, vertical greening would be provided on the external walls of the SHW WTW extension building to provide further visual mitigation. As such, the proposed variation would not change the extent of visual impact predicted in the approved EIA Report.</p> <p>The perspective view and photomontages for the proposed vertical greening are presented in Annex A.</p>	<p>The proposed variation would not affect the extent of environmental impact as predicted in the approved EIA Report. The proposed variation would comply with the requirements in the Technical Memorandum on EIA Process (EIAO-TM) with mitigation measures in place.</p>	<p>The environmental performance requirements set out in the approved EIA Report will be maintained under the revised design. The proposed variation would not change the extent of environmental impacts predicted in the approved EIA Report.</p>	<p>Key additional mitigation measure proposed includes vertical greening on the external wall of the new SHW WTW extension building to blend the building into the surrounding environment. Typical details of the additional measures are provided in Annex A.</p>

**PART E DECLARATION BY APPLICANT**

E1. I hereby certify that the particulars given above are correct and true to the best of my knowledge and belief. I understand the environmental permit may be suspended, varied or cancelled if any information given above is false, misleading, wrong or incomplete.

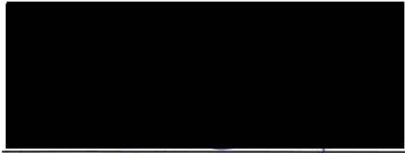

Signature of Applicant



Full Name in Block Letters



Position



on behalf of \_\_\_\_\_  
Water Supplies Department  
Company Name and Chop (as appropriate)

19 July 2021  
Date

**NOTES :**

1. A person who constructs or operates a designated project in Part I of Schedule 2 of the Ordinance or decommissions a designated project listed in Part II of Schedule 2 of the Ordinance without an environmental permit or contrary to the permit conditions commits an offence under the Ordinance and is liable to a maximum fine of \$5,000,000 and to a maximum imprisonment for 2 years.
2. A person for whom a designated project is constructed, operated or decommissioned and who permits the carrying out of the designated project in contravention of the Ordinance commits an offence and is liable to a maximum fine of \$5,000,000 and to a maximum imprisonment for 2 years.



## **Annex A**

### **Original Visual Screening Measure for SHW WTW Extension proposed in the EIA Report**

Tree planting along the north-western boundary of the SHW WTW site was proposed in the EIA Report and under **Condition 3.2** of the EP to provide visual screening as one of the landscape and visual mitigation measures. Vertical greening was not considered in the original design of the proposed SHW WTW extension.

### **Proposed Variation**

Instead of tree planting along the north-western site boundary of the SHW WTW, vertical greening (e.g. evergreen climbers and weeping plants) is proposed on the external wall of the new SHW WTW extension building to blend the building into the surrounding environment. Reference of the proposed vertical greening is provided in **Exhibit 1** and the perspective view (with and without proposed vertical greening) is shown in **Exhibit 2**. The details shown in **Exhibit 1** and **Exhibit 2** are tentative and will be subject to the detailed design of the vertical greening.

The photomontages of selected viewpoint (from Sham Shui Kok Drive) with and without visual impact mitigation measures including vertical greening are presented in **Exhibit 3**.

### **Reason for Variation**

To enable tree planting, a minimum planter width of 3 m would need to be reserved. As the north-western side of the SHW WTW is fully congested with existing and proposed underground utilities, planting of trees along this side of the SHW WTW site boundary is not feasible due to insufficient spacing. Moreover, the existing pavement on the northern side of the SHW WTW site also functions as an Emergency Vehicle Access (EVA) such that changing of the width is restricted. An existing footpath of over 3 m is located alongside the EVA. However, a new raw water main of 1200mm in diameter is proposed along this existing footpath. An existing pipeline is also running adjacent to this footpath. Provided with a safety buffer distance of 0.9m from the centre line of the proposed raw water mains, there is only 1.7 m left between the new raw water mains and the existing pipeline along the footpath. The width of other tree planting areas assumed in the EIA report is also very narrow of less than 3m as generally required. Therefore, planting of trees along the north-western side of the SHW WTW site boundary is infeasible and not recommended.

Review of the latest condition around the Project sites indicated that there has been a significant increase in the density and size of amenity planting at the cut slope around the SHW WTW site as well as along Cheung Tung Road as illustrated **Exhibit 4**. The existing tree and amenity planting in the SHW area would already provide a dense screen to the SHW WTW extension works. Further natural growth of these existing trees is also expected. Therefore, additional tree planting around the north-western boundary of the SHW WTW as required in the EP is considered not necessary.

### Exhibit 1: Tentative Design of Vertical Greening

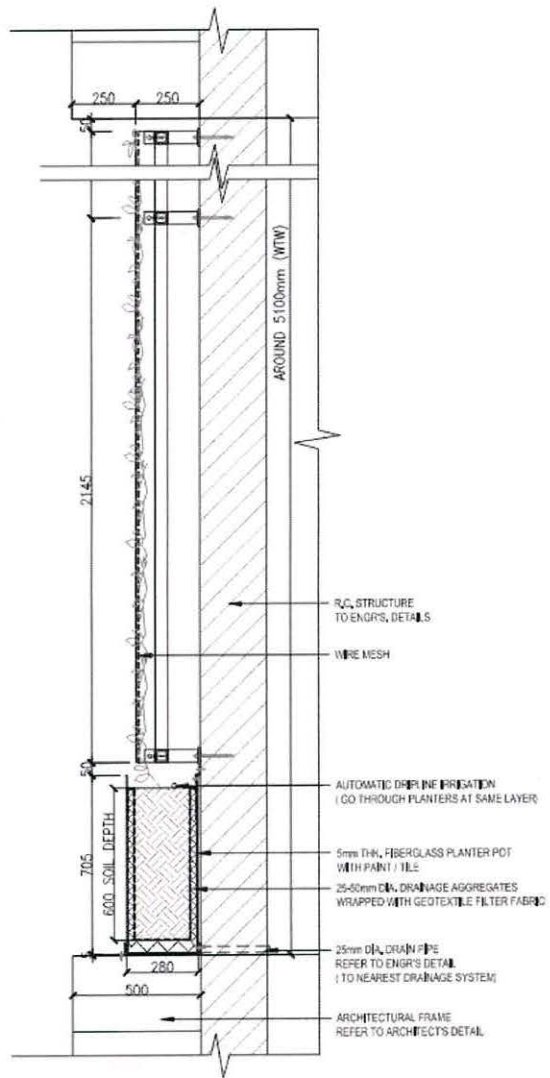

Typical Detail of Vertical Greening Wire Mesh (For Reference)



REFERENCE IMAGE

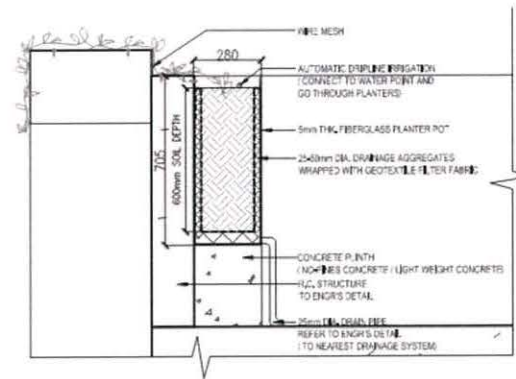

Typical Detail of Cascading Plants on Roof (For Reference)



Exhibit 2 Perspective View of Proposed Siu Ho Wan Water Treatment Works Extension

Without Proposed Vertical Greening



With Proposed Vertical Greening



Exhibit 3 Photomontage of Selected Viewpoint (from Sham Shui Kok Drive)

Without Visual Impact Mitigation Measures including Vertical Greening

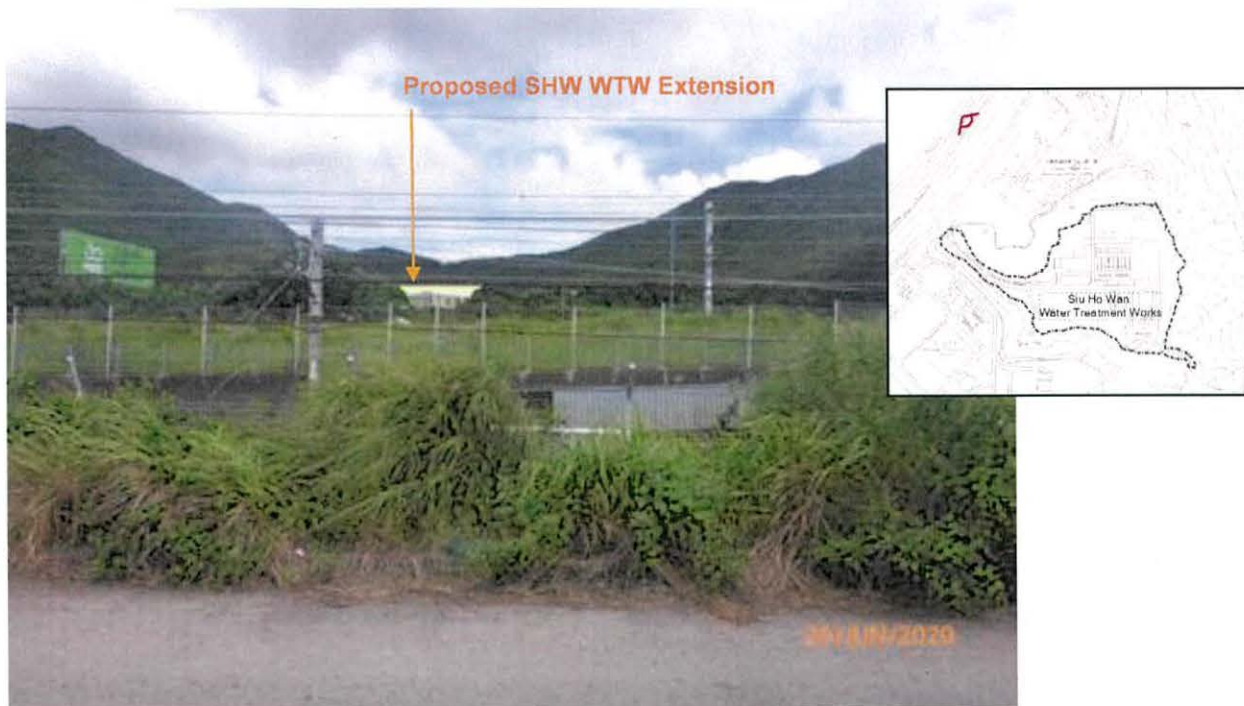

With Visual Impact Mitigation Measures including Vertical Greening





Exhibit 4 Changes of Site Conditions after the EIA Stage

