

User: c:\cadd\apps\mstrn\workspace\users\example\user, UserRef: c:\cadd\apps\mstrn\workspace\projects\p01\p01.dwg
 PRINTED BY: A450198 02/06/03 04:46:54 PM
 FILENAME: c:\cadd\w_r_dwg\p01\w_r\Railway Protection\Government\WRRP139.dgn

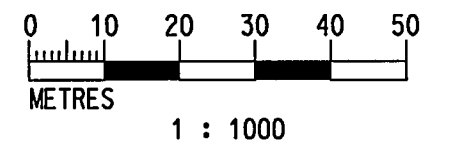
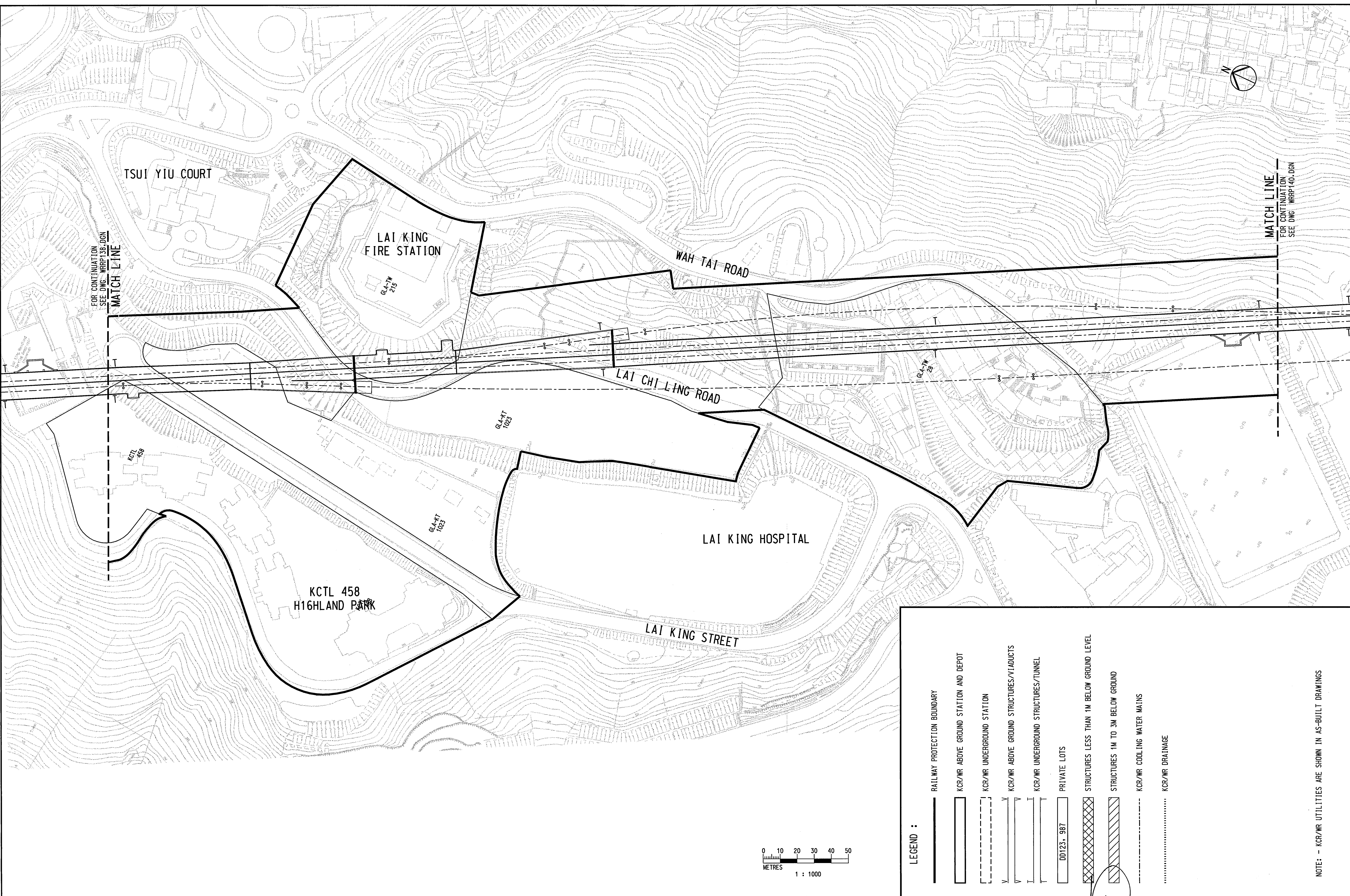

LEGEND :

- RAILWAY PROTECTION BOUNDARY
- KCR/MR ABOVE GROUND STATION AND DEPOT
- KCR/MR UNDERGROUND STATION
- KCR/MR ABOVE GROUND STRUCTURES/VIA-DUCTS
- KCR/MR UNDERGROUND STRUCTURES/TUNNEL
- PRIVATE LOTS
- DD123, 987
- STRUCTURES LESS THAN 1M BELOW GROUND LEVEL
- STRUCTURES 1M TO 3M BELOW GROUND
- KCR/MR COOLING WATER MAINS
- KCR/MR DRAINAGE

NOTE: - KCR/MR UTILITIES ARE SHOWN IN AS-BUILT DRAWINGS

REV	DATE	BY	SUB	APP	DESCRIPTION
02	JUN 2003	SN	ADM	LSC	SECOND ISSUE
01	NOV 2002	SN	ADM	LSC	FIRST ISSUE

DESIGNED BY
SN
 DRAWN BY
M. K. CHUNG
 CHECKED BY
ADM
 IN CHARGE
LSC
 DATE



AREA NUMBER 3 OF THE SCHEDULED AREAS
 FIFTH SCHEDULE
 BUILDINGS ORDINANCE (CAP.123)

RAILWAY LINES OF THE
 KOWLOON - CANTON RAILWAY CORPORATION
 - WEST RAIL (PHASE 1)
 RAILWAY PROTECTION PLAN

Signed: *(Signature)*
 (Michael M Y SUEN)
 Secretary for Housing, Planning and Lands
 Date: 6 JUN 2003



CADD FILE NO WRRP139.DGN	CADD DATE 29 JUL 2002
SCALE 1:1000 @ A1	
DRAWING NUMBER KCR/WR/RP/139	
SHEET NO 39	STAGE CODE REV 1